

# For Sublease

**CBRE**

Fully furnished modern office space in Brian Canfield Centre at well below market rates.



14th Floor

# 3777 Kingsway

Burnaby, BC



# High profile office development

with exceptional views and large, efficient floorplates.

## The Opportunity

To sublease the 14th floor at 3777 Kingsway, Burnaby, British Columbia. The opportunity features 19,054 SF of fully furnished area with over 100 workstations.

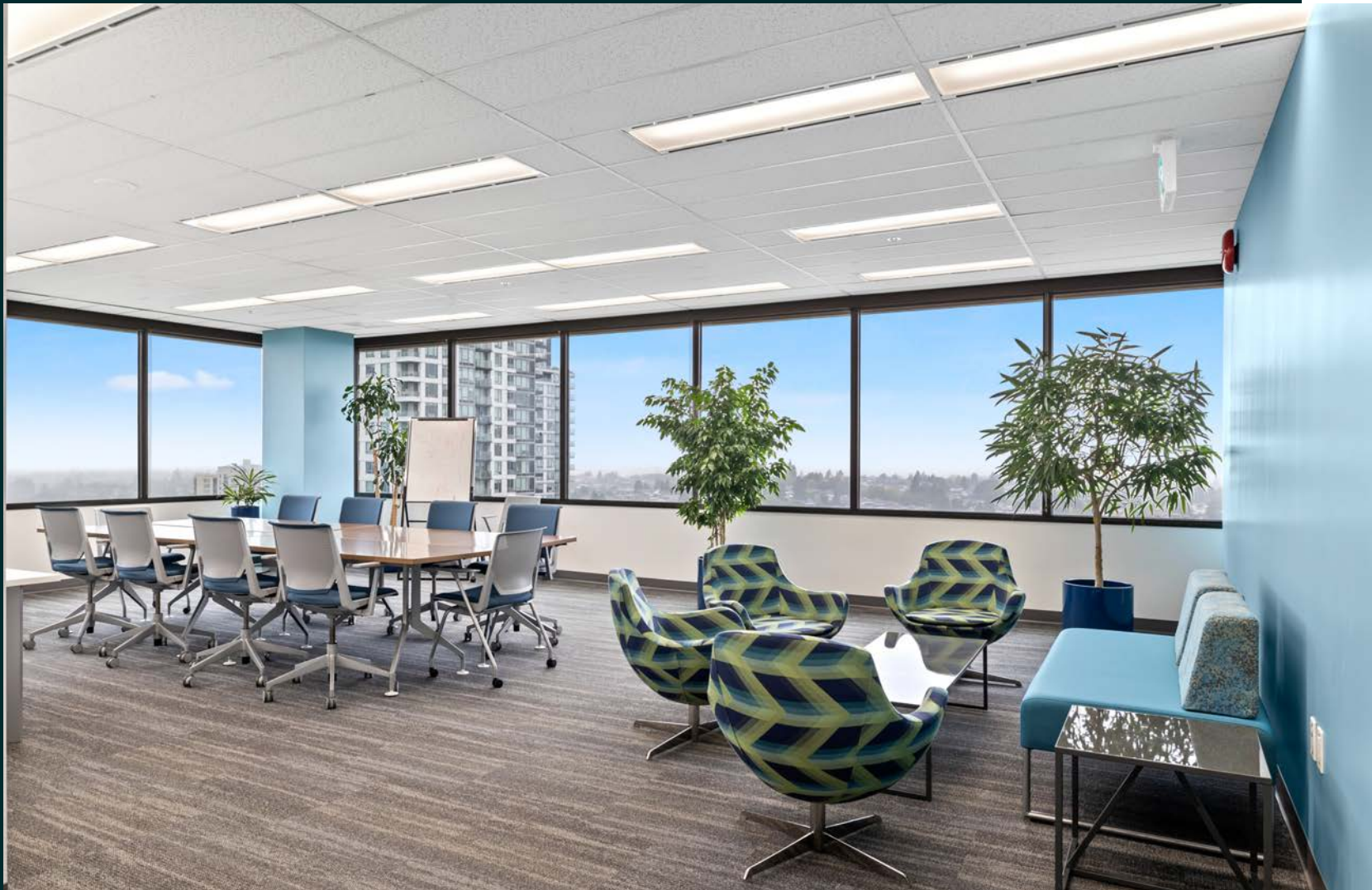

## The Premises



**AVAILABLE AREA**  
14th Floor - 19,054 SF



**ASKING SUBLEASE RATE**  
\$30.00 PSF Gross



**OCCUPANCY**  
Available with 60 days notice



**TERM**  
To April 28, 2026



3777 Kingsway  
Burnaby, BC

Office Space | For Sublease

14TH FLOOR

19,054

SF

Virtual Tour 

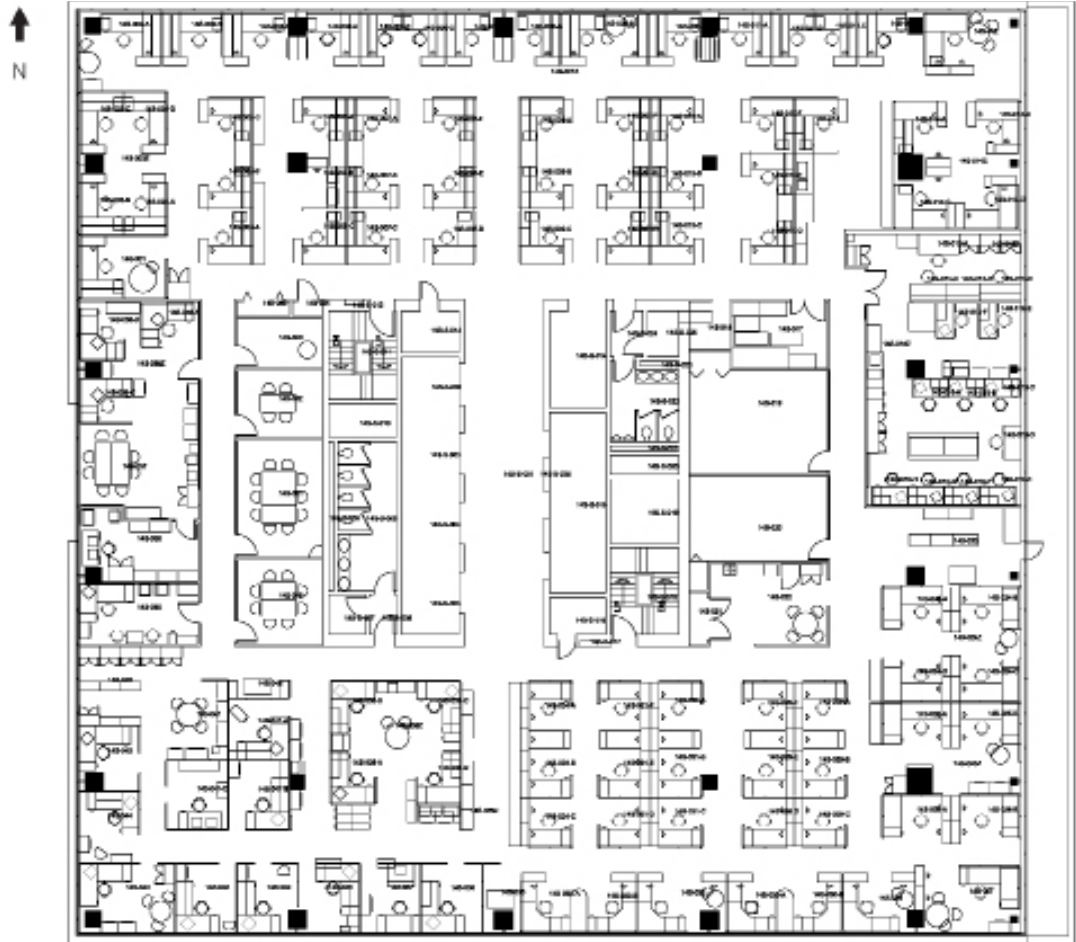

NOT TO SCALE

## Building Amenities



Fitness  
Facility



Cafeteria



Auditorium



Generous  
common areas



Underground +  
Surface Parking



# Location

The Brian Canfield Centre is a landmark building prominently located at the corner of NE Boundary and Kingsway in Burnaby. The building offers expansive views in all directions, large efficient floor plates and numerous onsite amenities.

The property is located within walking distance to both the Joyce and Patterson SkyTrain stations as well as Starbucks and Bikram Yoga Studio.

Swanguard Stadium is across the street, boasting an eight lane running track, sports field and park trails.

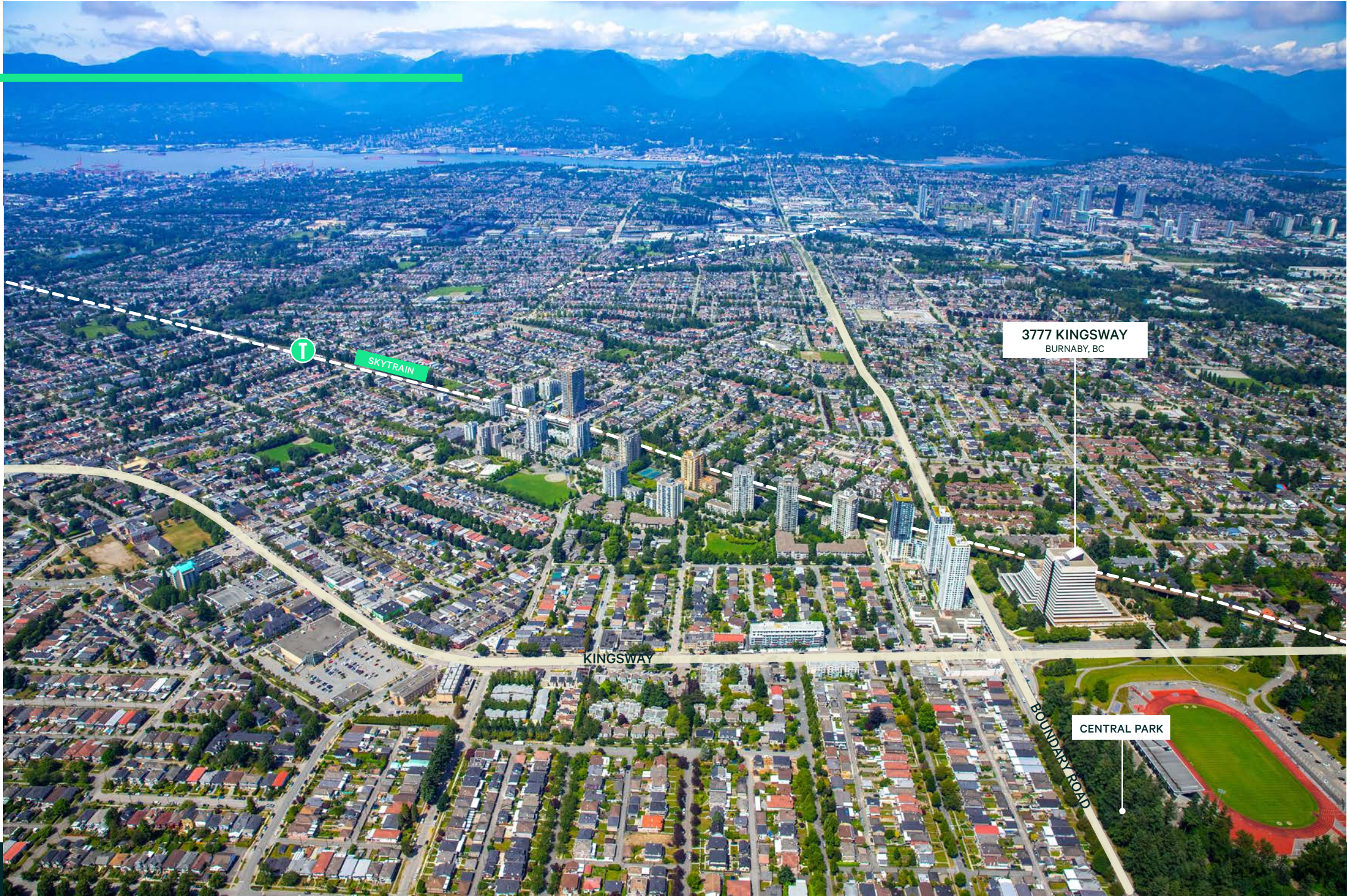

Vibrant

## Metrotown Neighbourhood

with access to transit, Metrotown Centre, and Central Park



81

EXCELLENT  
TRANSIT



70

VERY  
BIKEABLE



28

MIN TO  
WATERFRONT  
STATION



3777 Kingsway  
Burnaby, BC

Office Space | For Sublease

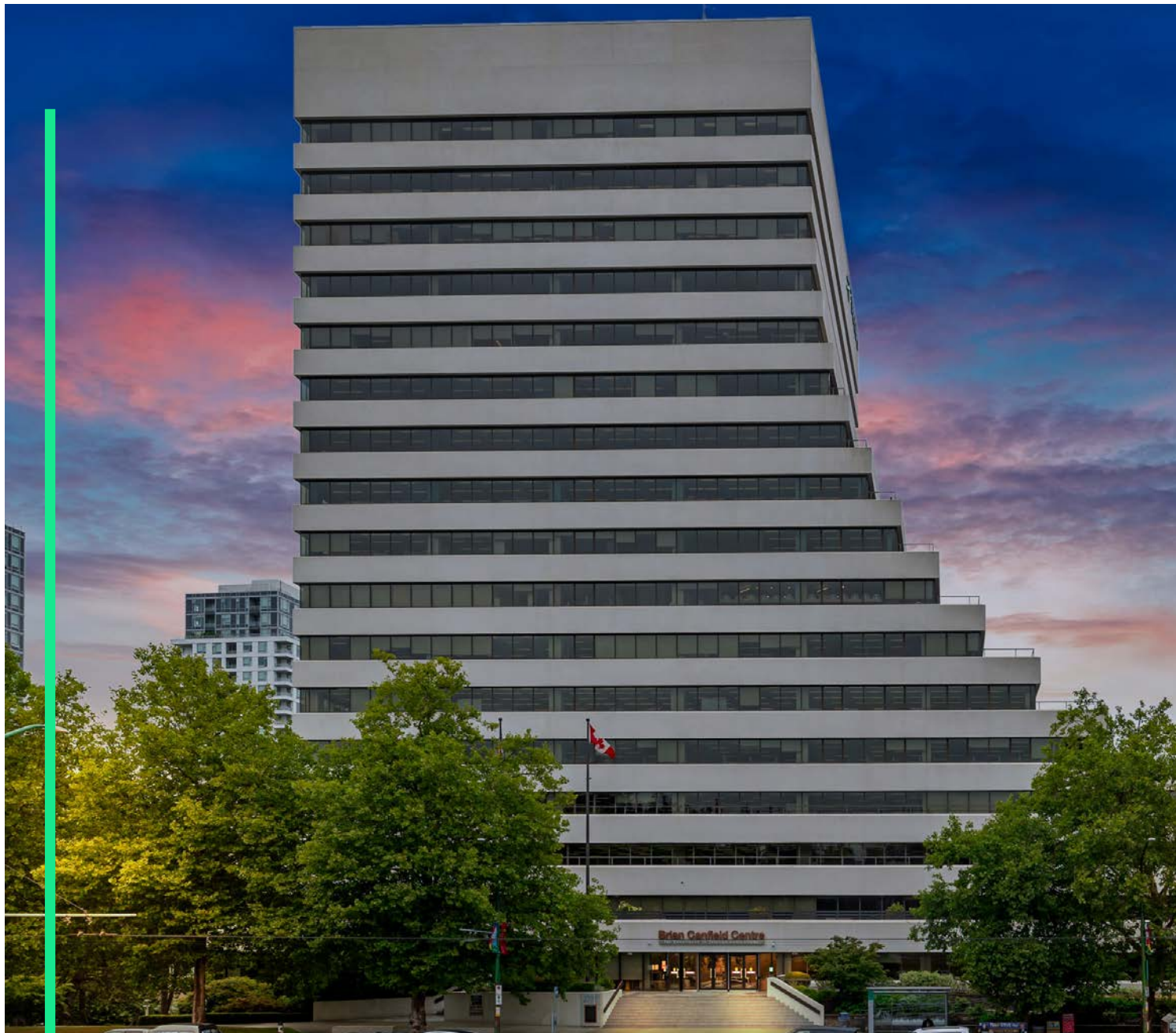

## Contact Agent

### John Megan

Personal Real Estate Corporation  
Senior Vice President  
Real Estate Advisory & Transaction Services

john.megan@cbre.com  
604 662 5111

# CBRE

CBRE Limited | [www.cbre.ca](http://www.cbre.ca)

This disclaimer shall apply to CBRE Limited, Real Estate Brokerage, and to all other divisions of the Corporation; to include all employees and independent contractors ("CBRE"). The information set out herein, including, without limitation, any projections, images, opinions, assumptions and estimates obtained from third parties (the "Information") has not been verified by CBRE, and CBRE does not represent, warrant or guarantee the accuracy, correctness and completeness of the Information. CBRE does not accept or assume any responsibility or liability, direct or consequential, for the Information or the recipient's reliance upon the Information. The recipient of the Information should take such steps as the recipient may deem necessary to verify the Information prior to placing any reliance upon the Information. The Information may change and any property described in the Information may be withdrawn from the market at any time without notice or obligation to the recipient from CBRE. CBRE and the CBRE logo are the service marks of CBRE Limited and/or its affiliated or related companies in other countries. All other marks displayed on this document are the property of their respective owners. All Rights Reserved.

Mapping Sources: Canadian Mapping Services Canada [mapping@cbre.com](mailto:mapping@cbre.com); DMTI Spatial, Environics Analytics, Microsoft Bing, Google Earth.