

# FOR SUBLEASE

887 GREAT NORTHERN WAY,  
VANCOUVER, BC

## LAB & OFFICE SPACE

### WITH UPGRADED BUILDING AMENITIES



## CONTACT

### ALAIN RIVÈRE

Personal Real Estate Corporation  
Senior Vice President | The HTFG  
+1 604 662 5110  
[alain.rivere@cbre.com](mailto:alain.rivere@cbre.com)



THE HIGH  
TECHNOLOGY  
FACILITIES GROUP

# CBRE



## HIGHLIGHTS

Fully-furnished and turn-key solution with a range of office and lab spaces available to rent:

- Available for occupancy immediately
- Month-to-month flexible leasing terms that are ideal for growing companies
- 2 individual offices and 2 lab benches available
- Shared meeting rooms (via booking system)
- Internet - WIFI enabled
- Located 2 blocks from VCC-Clark Skytrain
- The Central Valley Greenway and the #84 bus run along Great Northern Way

## BUILDING AMENITIES

- 24-hr access, 7 days a week with onsite security
- Onsite Café/break-out facility
- Fitness and shower facilities (exclusive for tenants)
- Secure bike storage
- Opportunity to arrange underground parking



This disclaimer shall apply to CBRE Limited, Real Estate Brokerage, and to all other divisions of the Corporation; to include all employees and independent contractors ("CBRE"). The information set out herein, including, without limitation, any projections, images, opinions, assumptions and estimates obtained from third parties (the "Information") has not been verified by CBRE, and CBRE does not represent, warrant or guarantee the accuracy, correctness and completeness of the Information. CBRE does not accept or assume any responsibility or liability, direct or consequential, for the Information or the recipient's reliance upon the Information. The recipient of the Information should take such steps as the recipient may deem necessary to verify the Information prior to placing any reliance upon the Information. The Information may change and any property described in the Information may be withdrawn from the market at any time without notice or obligation to the recipient from CBRE. CBRE and the CBRE logo are the service marks of CBRE Limited and/or its affiliated or related companies in other countries. All other marks displayed on this document are the property of their respective owners. All Rights Reserved. Mapping Sources: Canadian Mapping Services [cmapdata.com](https://www.cmapdata.com) DMIT Spatial, Envirionics Analytics, Microsoft Bing, Google Earth.

## UNIT 220 (OFFICE)

### Yellow

Shared boardroom and one meeting room, available for booking at no additional cost.

### Purple

Shared galley kitchen with a lunch lounge.

### Blue

Two dedicated fully furnished offices, consisting of one larger window office and one hallway office. Furniture could be configured to suite specific needs.

**Monthly rent: \$5,400 + GST for all offices and access to shared areas..**

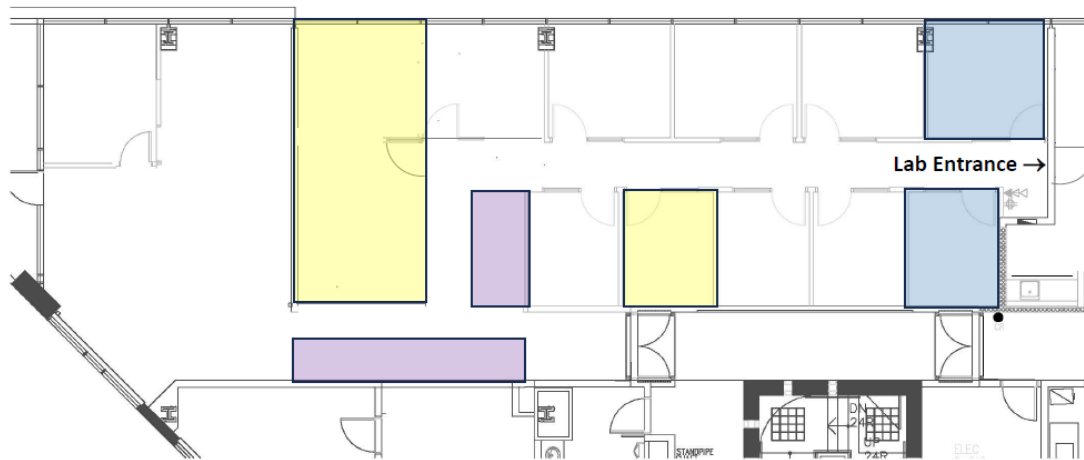

## UNIT 220 (LAB)

### Yellow

Lab space consisting of 17 ft long lab benches (A and D), one shared fume hood, and a multitude of shared equipment.

**Monthly rent per individual lab bench: 1,450 +GST.**

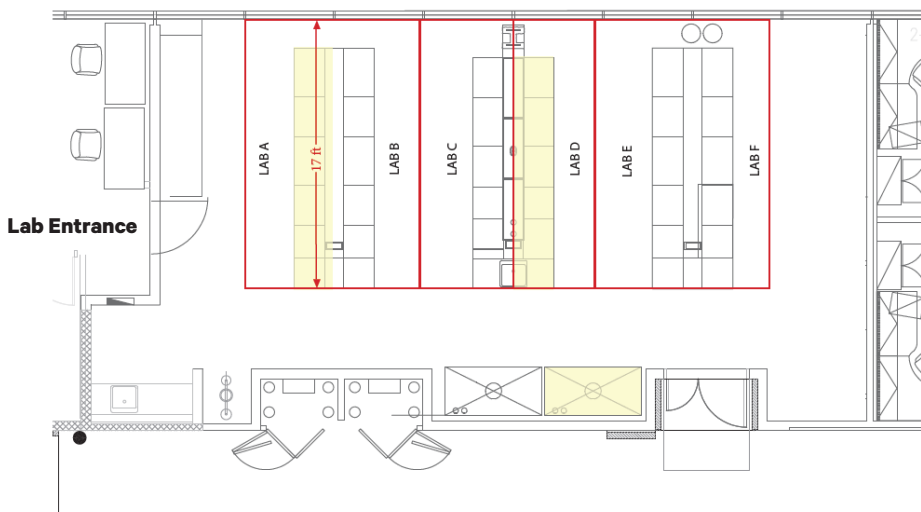

### Shared Equipment & Additional Facilities

- Thermo Scientific Sorvall X1R Centrifuge including the following rotors
  - Thermo Scientific angle rotor model F15-8x50C
  - TX-400 Swinging bucket rotor
  - MicroClick 30 rotor
- Micro17 Microcentrifuge
- Tuttnauer 3545 Autoclave, 34.4L
- Compact Digital Mini-Rotator with rotator attachment
- Thermo Scientific LP vortex mixer
- Mettler Analytical balance
- Mettler Toledo MS 1602TS Precision balance
- EMD Millipore Direct Q3 UV Water Purification System
- Mini Centrifuge
- Thermo Scientific Forma Environmental Chamber
- Gas cylinder alcoves that feed directly into the fume hoods
- Eye wash station and lab shower
- First aid and fire safety in place

# 887 GREAT NORTHERN WAY



	VCC Clark Millennium Line with connection to Expo Line	Olympic Village Canada Line
Car	1	7
Transit	1	7
Bike	1	11
Walk	6	20

- Skytrain Expo Line
- Skytrain Millennium Line
- Future Skytrain Alignment
- Canada Line
- Major Bus Routes
- Major Bike Routes
- T B Transit & Bus Stations

## LOCATION

Located in the False Creek Flats, and on the Central Valley Greenway, 887 Great Northern Way boasts high quality office space in an office and lab building facing China Creek North Park, a 3.16 hectare park with running track and playing fields. The building is a 2-minute walk from VCC Clark SkyTrain Station, the current terminus on the Millennium Skytrain Line. The #84 bus departs from VCC Clark Station, connecting commuters to UBC with a stop at the Olympic Village Canada Line Station. Main Street is 6 blocks away with bus routes giving access to Main Street Skytrain Station and the rest of the Lower Mainland.

To the West of the Building is Emily Carr University, and the newly completed 565 Great Northern Way office building which will increase the vibrancy of this highly sought after neighbourhood.



## CONTACT

### ALAIN RIVÈRE

Personal Real Estate Corporation  
 Senior Vice President | The HTFG  
 +1 604 662 5110  
[alain.rivere@cbre.com](mailto:alain.rivere@cbre.com)



THE HIGH  
 TECHNOLOGY  
 FACILITIES GROUP

