

Industrial | For Lease

UNIT 201B & 202B

1546 Derwent Way

Delta, BC

PROFESSIONALLY MANAGED AND OWNED BY:

Beedie/



Small Bay Warehouse Units with Dock & Grade Loading Located on Annacis Island

CBRE

THE
INDUSTRIAL
SPECIALISTS

The Opportunity

Prime Warehouse Space Available For Lease

CBRE is pleased to present the opportunity to lease units **201B & 202B at 1546 Derwent Way** (the "Property") – two corner small bay warehouse units located on Annacis Island in Delta.

The Property provides great exposure along Derwent Way and offers a total of 10,010 SF, 18' clear heights and 1 dock & 1 grade level loading doors.

The Property is conveniently located on the west side of Annacis Business Park along Derwent Way. Offering excellent accessibility to major lower mainland thoroughfares, Annacis Business Park is favoured by local and national tenants.

UNIT SIZE
Warehouse 7,247 SF
Office 2,159 SF
Mezzanine 604 SF

Total: 10,010 SF

ZONING
I-2 (Industrial)
Permitting a wide range of industrial uses including manufacturing, warehousing, distribution, assembly, food and related office uses

LOADING
1 Dock & 1 Grade Level

CEILING HEIGHT
18'

AVAILABILITY
Immediately

ASKING RATE
Contact Listing Agents

OPERATING COSTS (2024)
\$6.41 PSF + 5.0%
Management Fee of Basic Rent

Floor Plan

*Floorplan not to scale

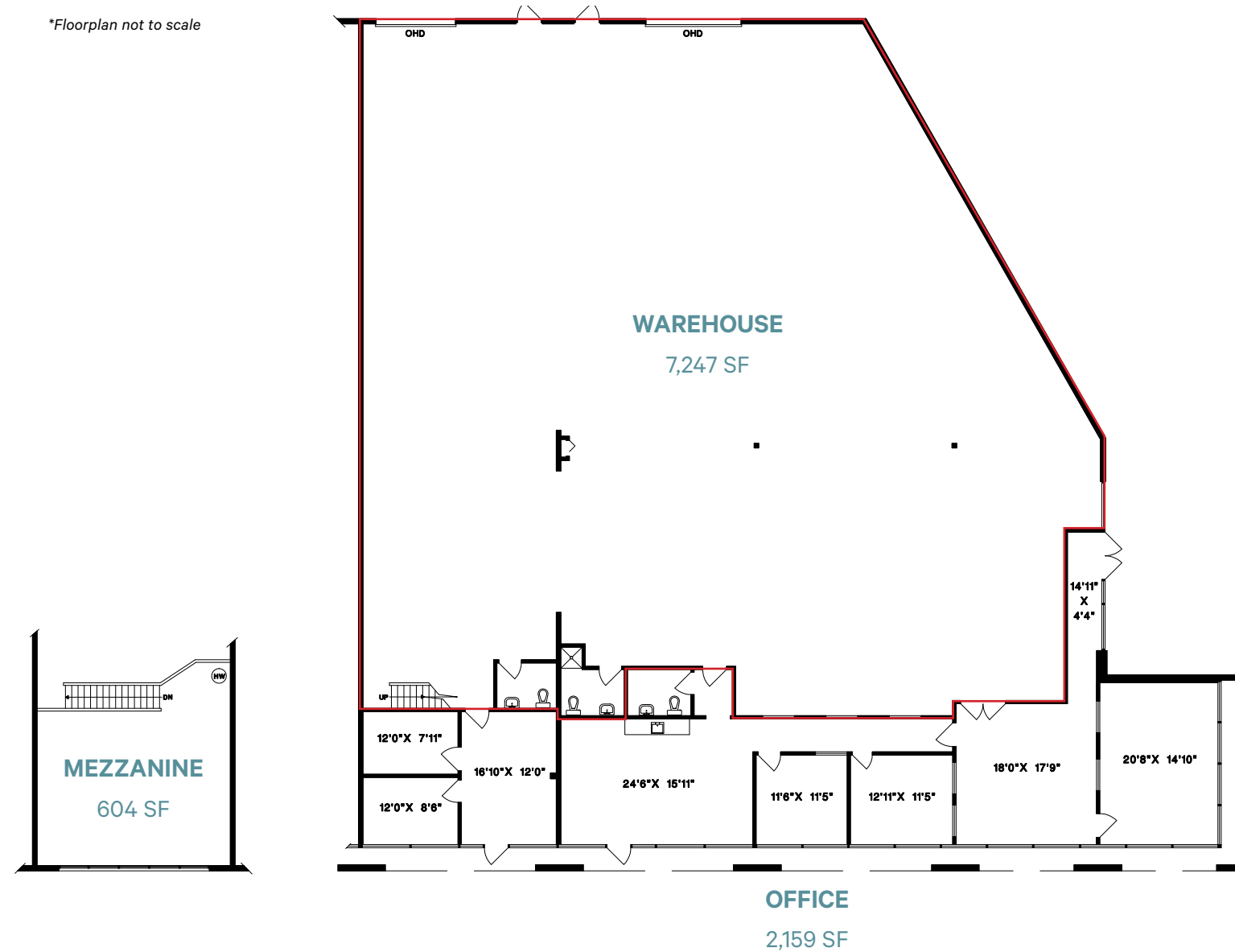

Property Features

- » Ample parking in the complex
- » Concrete tilt-up construction
- » Ample truck maneuvering room
- » Three phase power
- » Excellent corporate appeal
- » Fully sprinklered
- » Professionally managed and owned by Beedie



3

Minutes to Highway 91

6

Minutes to Highway 17

20

Minutes to Surrey City Centre

20

Minutes to US/Canada Border Crossing



Convenient Access to Highway 99 via Highway 17



Bus Routes Near Property



Connect With Us For More Information

LUC SOARES

Sales Associate
778 372 1938
luc.soares@cbre.com

STEVE BROOKE

PERSONAL REAL ESTATE CORPORATION
Executive Vice President
604 662 5147
steve.brooke@cbre.com

JOEL BARNETT

PERSONAL REAL ESTATE CORPORATION
Executive Vice President
604 662 5570
joel.barnett@cbre.com

ALEX MEI 梅嘉俊

PERSONAL REAL ESTATE CORPORATION
Associate Vice President
778 788 3106
alex.mei@cbre.com



CBRE Limited | 1021 West Hastings Street #2500, Vancouver, BC V6E 0C3 | cbre.ca

theindustrialspecialists.com

@theindustrialspecialists

This disclaimer shall apply to CBRE Limited, Real Estate Brokerage, and to all other divisions of the Corporation; to include all employees and independent contractors ("CBRE"). The information set out herein, including, without limitation, any projections, images, opinions, assumptions and estimates obtained from third parties (the "Information") has not been verified by CBRE, and CBRE does not represent, warrant or guarantee the accuracy, correctness and completeness of the Information. CBRE does not accept or assume any responsibility or liability, direct or consequential, for the Information or the recipient's reliance upon the Information. The recipient of the Information should take such steps as the recipient may deem necessary to verify the Information prior to placing any reliance upon the Information. The Information may change and any property described in the Information may be withdrawn from the market at any time without notice or obligation to the recipient from CBRE. CBRE and the CBRE logo are the service marks of CBRE Limited and/or its affiliated or related companies in other countries. All other marks displayed on this document are the property of their respective owners. All Rights Reserved. Mapping Sources: Canadian Mapping Services canadamapping@cbre.com; DMTI Spatial, Environics Analytics, Microsoft Bing, Google Earth. Images: Southgranville.org