

Office For Sublease | Move In Ready

---

3,405 - 11,567 SF

# 2700 Production Way

Burnaby, BC

Office space near Production Way-  
University SkyTrain Station



## Contact

**Zach Wittenberg**

Personal Real Estate Corporation  
Vice President  
Commercial Properties - Advisory & Transaction Services

[zach.wittenberg@cbre.com](mailto:zach.wittenberg@cbre.com)  
+1 604 662 5158

**CBRE**



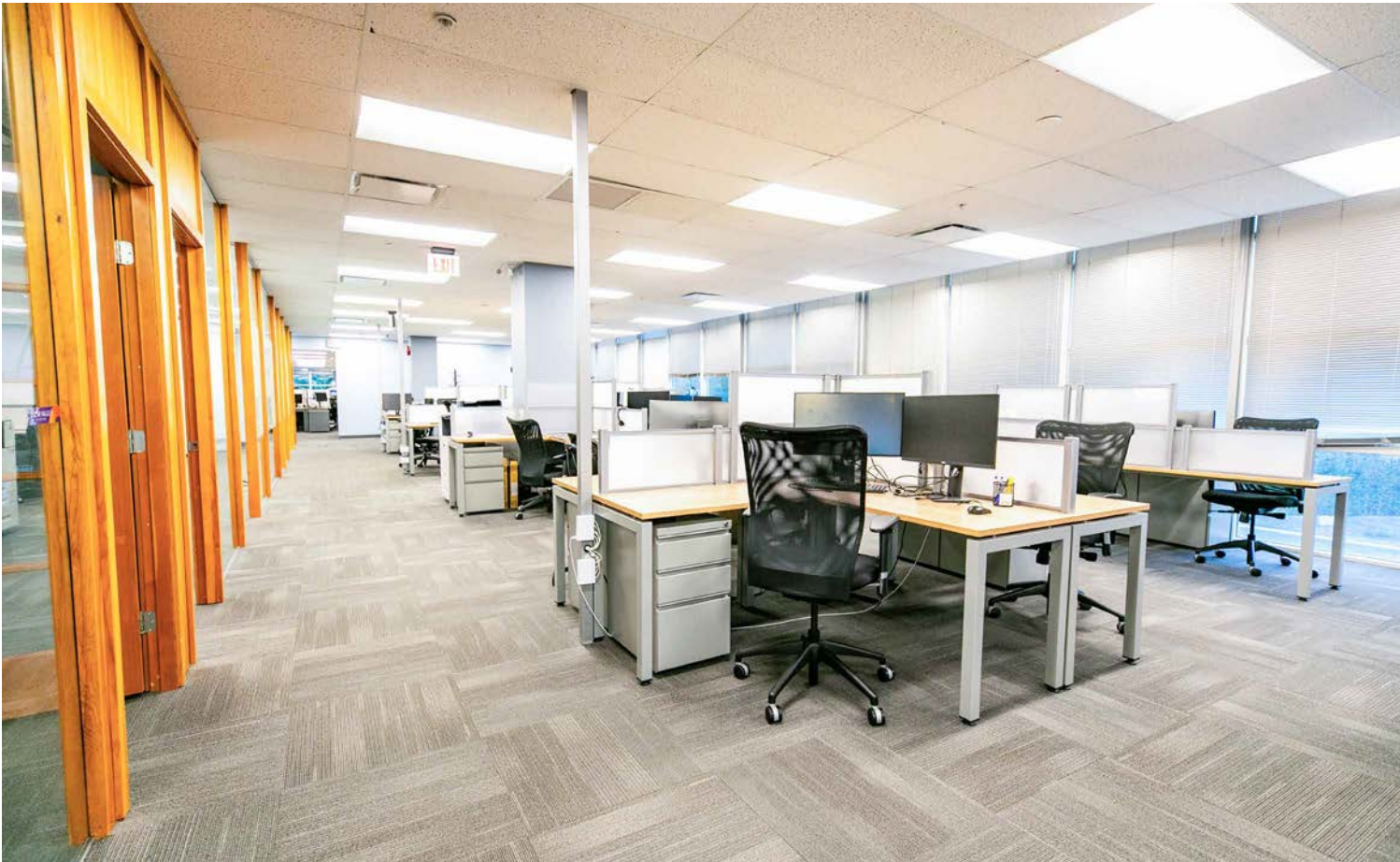

Floor-to-ceiling glass provides the space with plenty of natural light and outstanding views.



## Available Immediately



**Available Area**  
Suite 610 - 3,405 SF  
Suite 660/670 - 11,567 SF



**Sublease Rate**  
Contact Listing Agent



**Additional Rent**  
\$17.51 PSF (2023 estimate)  
Inclusive of hydro and in-suite janitorial.



**Expiry Date**  
September 28, 2024



**Furniture Included**

## Suite Features

### SUITE 610

- + 2 meeting rooms
- + Open office
- + Private decks

### SUITE 660 / 670

- + 11 private offices
- + 2 meeting rooms
- + Open office
- + Large lunch room

## Building Features

- + Attractive lobby entrance off Production Way
- + Building communal gym
- + Covered access to five level parkade
- + Secured building

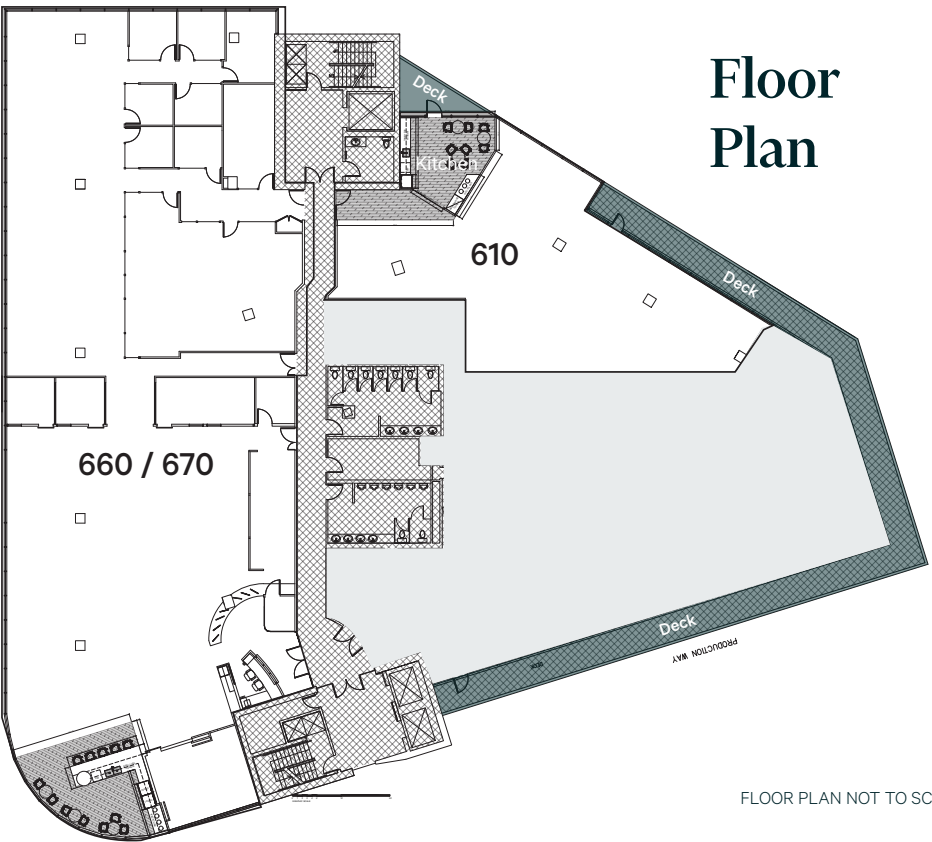

FLOOR PLAN NOT TO SCALE





## Location

2700 Production Way is located at the base of Burnaby Mountain, near Simon Fraser University and Lougheed Town Centre. This desirable location benefits from unparalleled access to all areas of Metro Vancouver through multiple arterial routes such as Trans-Canada Highway, Lougheed Highway, and North Road. Production Way University SkyTrain Station and a proposed gondola is a quick 10 minute walk away providing immediate rapid transit access.



## Contact

### Zach Wittenberg

Personal Real Estate Corporation  
Vice President  
Commercial Properties - Advisory & Transaction Services

[zach.wittenberg@cbre.com](mailto:zach.wittenberg@cbre.com)  
+1 604 662 5158



CBRE Limited  
1021 West Hastings Street | #2500 | Vancouver, BC V6E 0C3 | [www.cbre.ca](http://www.cbre.ca)

This disclaimer shall apply to CBRE Limited, Real Estate Brokerage, and to all other divisions of the Corporation; to include all employees and independent contractors ("CBRE"). All references to CBRE Limited herein shall be deemed to include CBRE, Inc. The information set out herein, including, without limitation, any projections, images, opinions, assumptions and estimates obtained from third parties (the "Information") has not been verified by CBRE, and CBRE does not represent, warrant or guarantee the accuracy, correctness and completeness of the Information. CBRE does not accept or assume any responsibility or liability, direct or consequential, for the Information or the recipient's reliance upon the Information. The recipient of the Information should take such steps as the recipient may deem necessary to verify the Information prior to placing any reliance upon the Information. The Information may change and any property described in the Information may be withdrawn from the market at any time without notice or obligation to the recipient from CBRE. CBRE and the CBRE logo are the service marks of CBRE Limited and/or its affiliated or related companies in other countries. All other marks displayed on this document are the property of their respective owners. All Rights Reserved. Mapping Sources: Canadian Mapping Services [canadamapping@cbre.com](mailto:canadamapping@cbre.com); DMTI Spatial, EnviroNics Analytics, Microsoft Bing, Google Earth.