



NAI Advent

ADVENT COMMERCIAL REAL ESTATE CORP.

Industrial Flex Bay

For Lease | Units 23 and 24, 2015 32 Ave NE, Calgary, AB T2E 6Z3

ABOUT THE PROPERTY

UNIT SIZE	±5,612 SF total
ZONING	I-C (Industrial Commercial)
WAREHOUSE	±1,560 SF
OFFICE/SHOWROOM	±4,052 SF
PARKING	Scramble
LOADING	1 dock door, 1 drive-in door
POWER	200 amp (TBV)
OP COSTS	\$5.58 + 6% management fee
LEASE RATE	Market
LEASE TERM	Negotiable
AVAILABLE	May 1, 2026

For more information, please contact:



Brian West

+1 403 630 7881
bwest@naiadvent.com



Connor West

+1 587 429 8577
cwest@naiadvent.com

PROPERTY LOCATION

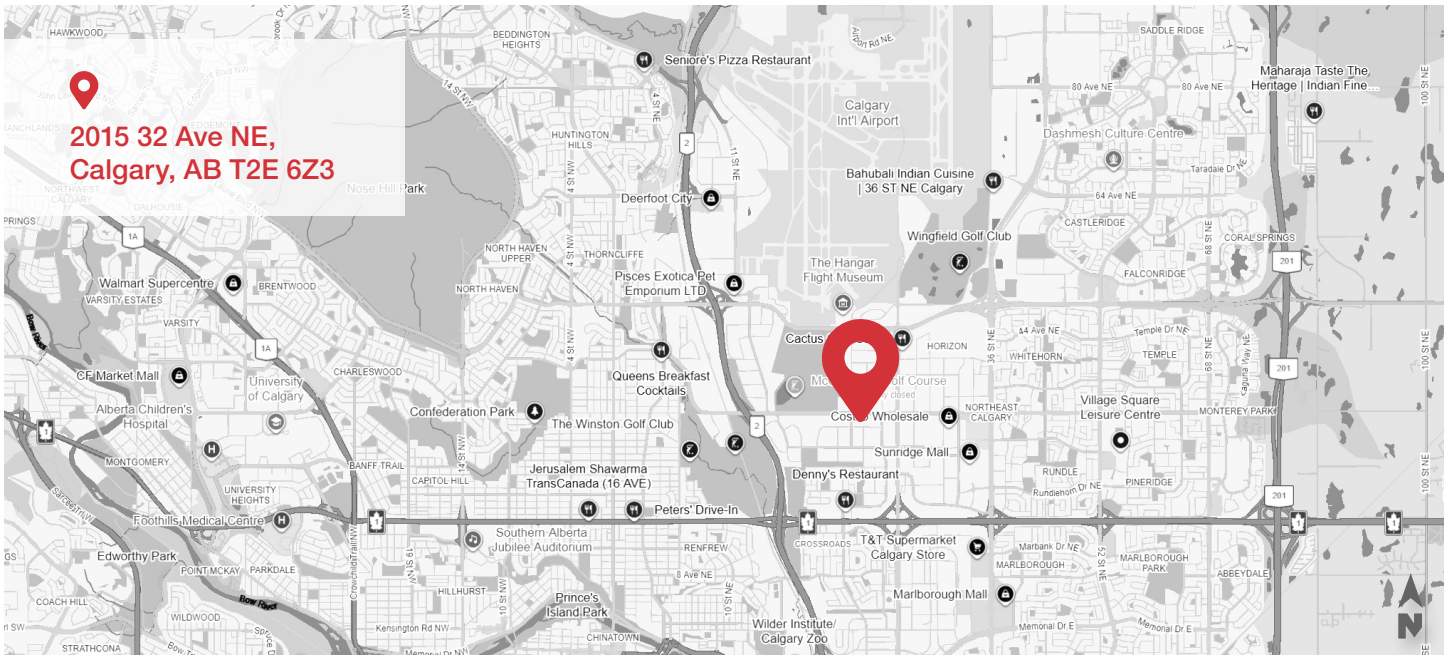

For more information,
please contact:



Brian West

+1 403 630 7881
bwest@naiadvent.com



Connor West

+1 587 429 8577
cwest@naiadvent.com

PROPERTY FLOOR PLAN

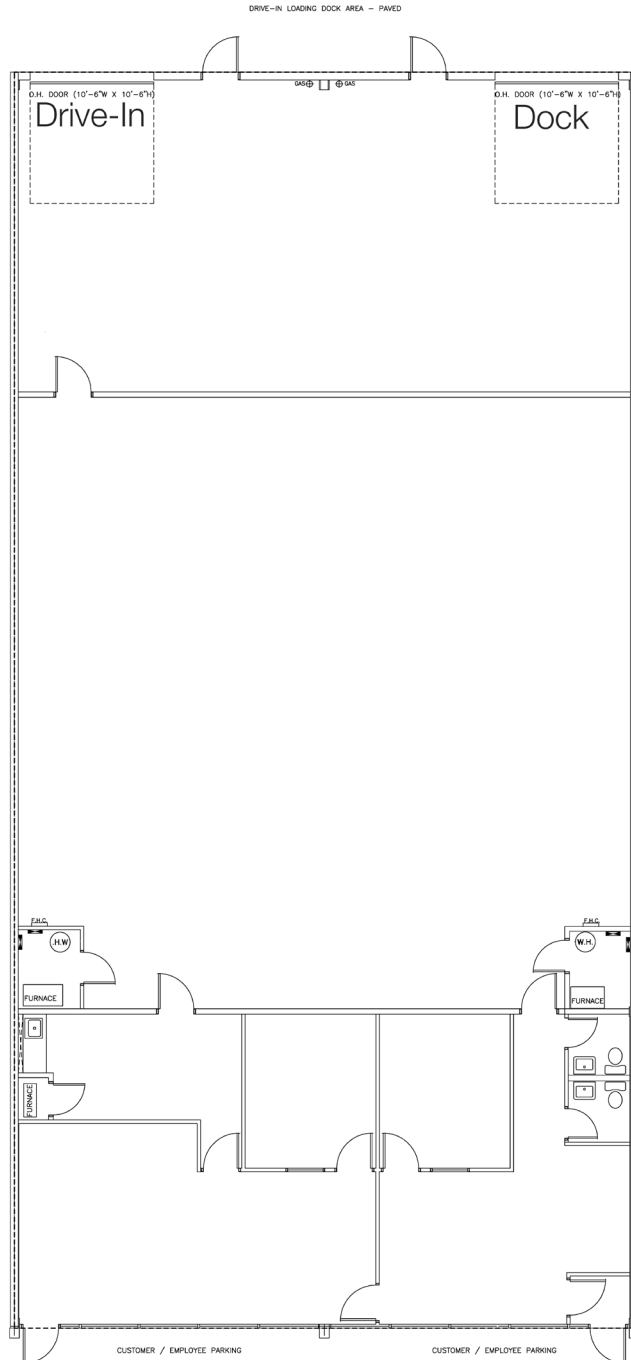

For more information,
please contact:



Brian West
+1 403 630 7881
bwest@naiadvent.com



Connor West
+1 587 429 8577
cwest@naiadvent.com

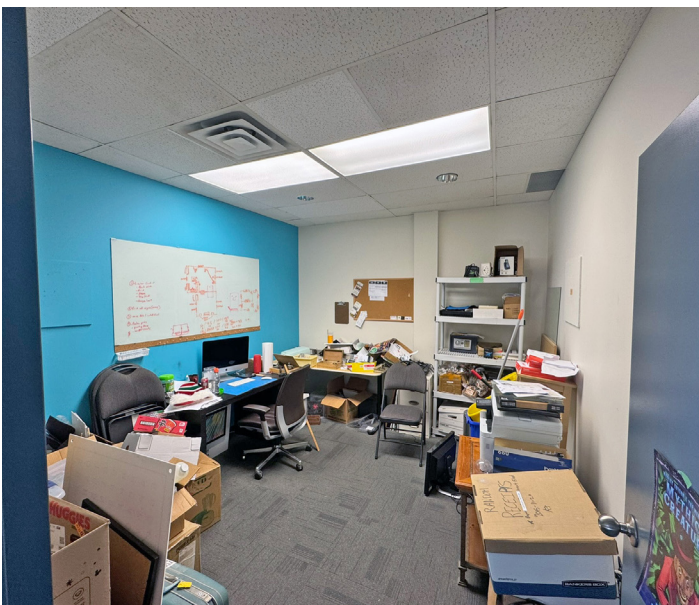
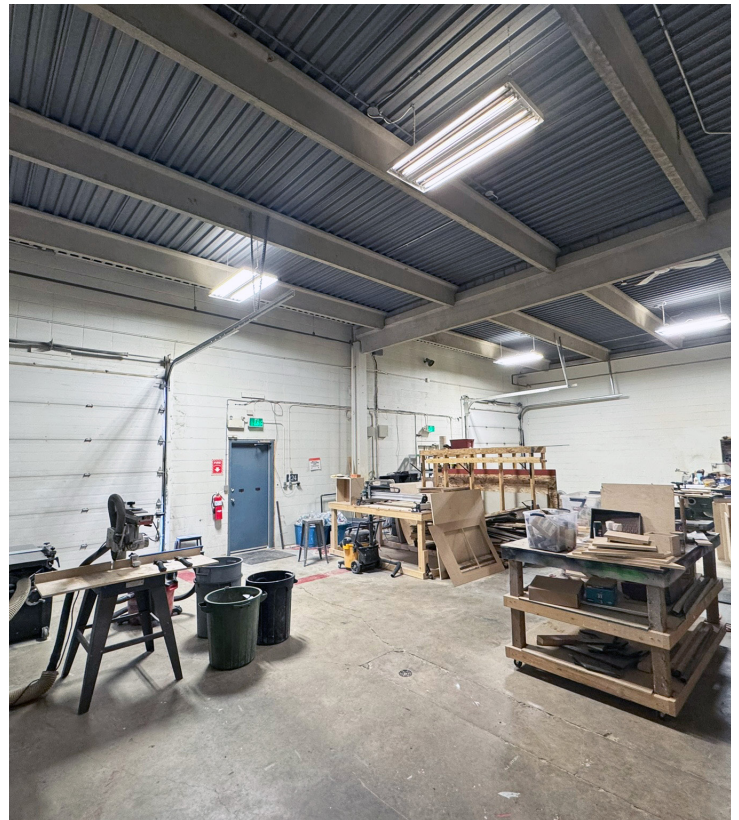

This brochure is intended for information purposes only and should not be relied upon for accurate factual information by the recipients hereof. The information contained herein is based on information which NAI Advent deems reliable, however, NAI Advent assumes no responsibility for the degree of accuracy of such information, nor does NAI Advent represent or warrant the information contained herein. Recipients hereof should conduct their own investigations to determine the accuracy of information contained herein. The information contained herein is subject to change without notice.

For more information,
please contact:



Brian West

+1 403 630 7881
bwest@naiadvent.com



Connor West

+1 587 429 8577
cwest@naiadvent.com