

## 2608, 2642 & 2658 176<sup>th</sup> Street Surrey, BC

### Property Highlights

- ▶ 23.1 acres of net developable area
- ▶ 3.74 acres designated “Multiple Residential” – 22upa
- ▶ 11.20 acres designated “Townhouse Residential” – 30upa

Gary Haukeland\*  
Senior Vice President  
604 691 6693  
ghaukeland@naicommercial.ca  
\*Personal Real Estate Corporation

J-D Murray  
Senior Associate  
604 691 6664  
jdmurray@naicommercial.ca

**NAI Commercial**  
1075 W Georgia St, Suite 1300  
Vancouver, BC V6E 3C9  
+1 604 683 7535  
[naicommercial.ca](http://naicommercial.ca)

## 2608, 2642 & 2658 176<sup>th</sup> Street, Surrey, BC

### The Opportunity

The subject site consists of three single-family parcels totalling a gross area of approximately 29.49 acres (1,284,584 SF). The site is designated “Townhouse, Multiple Residential 22 upa, Park” within the Redwood Heights Neighbourhood Community Plan. The net developable area is approximately 23.10 acres (1,006,236 SF). The subject properties have an active rezoning application submitted to the City of Surrey to rezone from RA, A-1, A-2, to RA, RM-30, subdivision from three (3) to six (6) lots, and a general development permit that is still in initial review. Based on NCP, 3.74 acres is designated “Multiple Residential” – 22upa, 11.20 acres is designated “Townhouse Residential” – 30upa, and 8.16 acres is designated as ‘park’. The subject site is not in the ALR.

### Location

The property is located on the east side 176<sup>th</sup> Street (Pacific Highway 15) at the 26<sup>th</sup> Avenue intersection, in South Surrey. The property is between Campbell Heights and Grandview Heights, and close to all amenities.

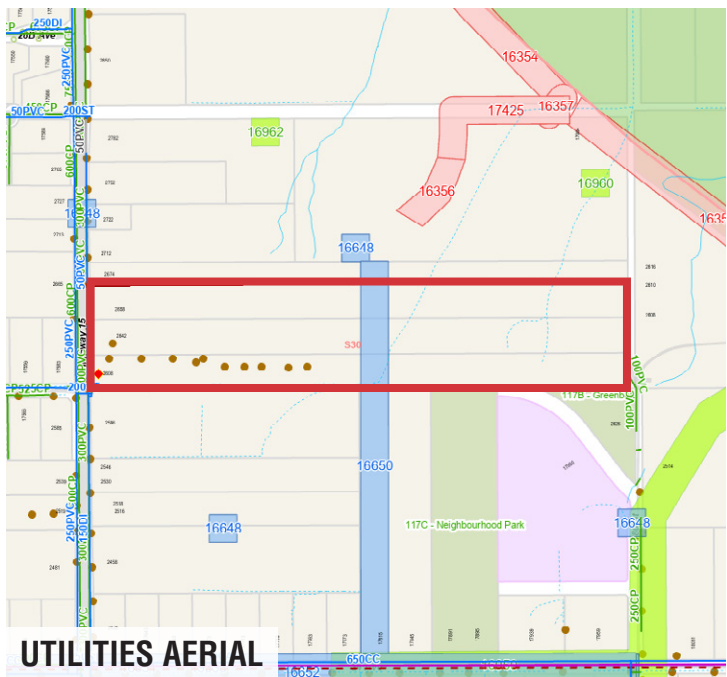

UTILITIES AERIAL

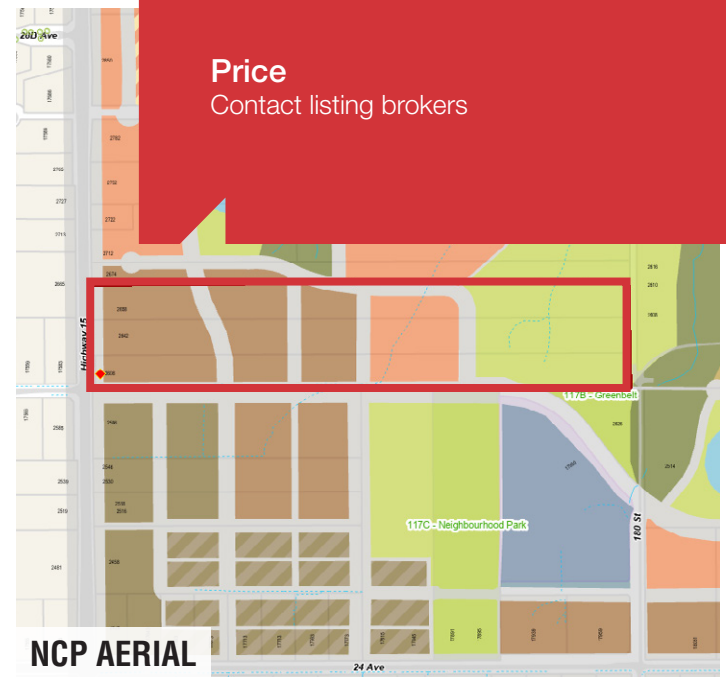

NCP AERIAL

## Property Details

### Civic Address

2609-2658 176<sup>th</sup> Street, Surrey, BC V3Z 9W5

### Legal Description

**2608 176<sup>th</sup> Street (9.90 acres)**

PID: 000-878-324

Legal: Lot 17 Section 20 Township 7 New Westminster District Plan 44251

**2642 176<sup>th</sup> Street (9.76 acres)**

PID: 011-359-226

Legal: Lot 2 Except: Firstly: South 85.3 Feet; Secondly: Part On Statutory Right Of Way Plan 84545; Section 20 Township 7 New Westminster District Plan 8342

**2658 176<sup>th</sup> Street (9.85 acres)**

PID: 011-359-234

Legal: Lot 3 Except: Part On Statutory Right Of Way Plan 84545; Section 20 Township 7 New Westminster District Plan 8342

### Total Lot Size

29.49 acres

(net developable – 23.10 acres)

### Total Property Taxes

\$405,056.55 (2024)

### Zoning

Currently Zoned RA, A2, & A1

### Price

Contact listing brokers

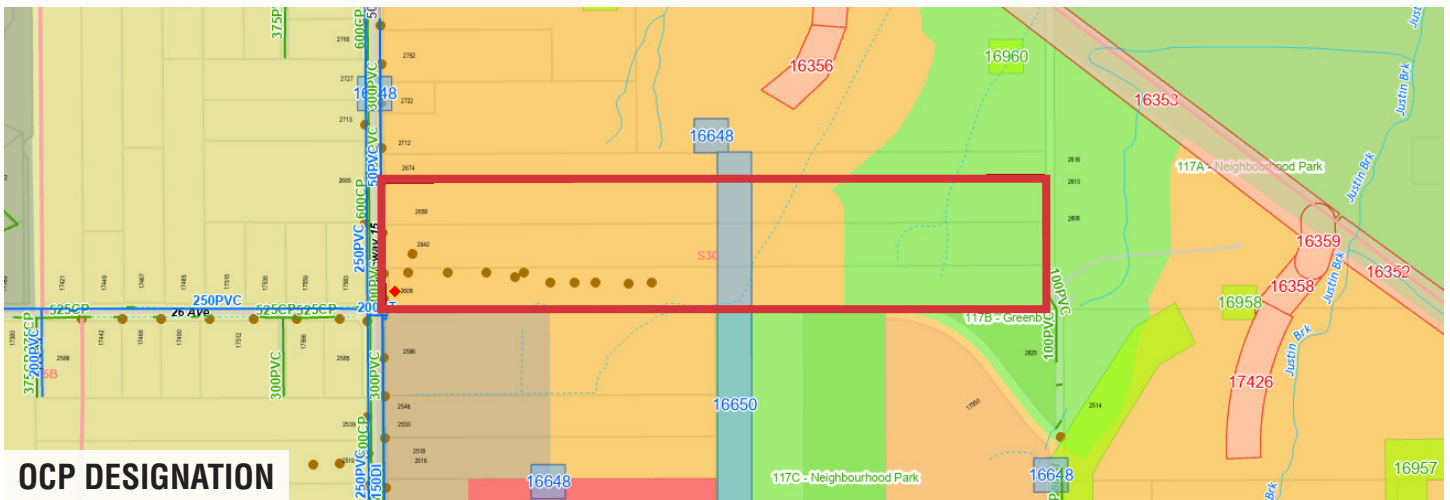



**2608-2658**  
176 STREET

26 AVE

**GRANDVIEW  
HEIGHTS**

176 ST

15

**CAMPBELL  
HEIGHTS**

**🚗 Drive Times:**

Downtown Langley	15 min
Surrey Central	30 min

**✈️ Proximity to Airports:**

Vancouver International Airport	35 min
Abbotsford International Airport	35 min

**Gary Haukeland\***, Senior Vice President  
604 691 6693 | ghaukeland@naicommercial.ca

**J-D Murray**, Senior Associate  
604 691 6664 | jdmurray@naicommercial.ca

\*Personal Real Estate Corporation

**NAI**Commercial

No warranty or representation, express or implied, is made as to the accuracy of the information contained herein, and the same is submitted subject to errors, omissions, change of price, rental or other conditions, prior sale, lease or financing, or withdrawal without notice, and of any special listing conditions imposed by our principals no warranties or representations are made as to the condition of the property or any hazards contained therein are any to be implied. Aerial image(s) courtesy of Google, Landsat/Copernicus

**NAI Commercial**  
1075 W Georgia St, Suite 1300  
Vancouver, BC V6E 3C9  
+1 604 683 7535  
[naicommercial.ca](http://naicommercial.ca)