



**807-815
HORNBY STREET**

Vancouver, BC

RETAIL SUBLEASE BROCHURE



SITINGS REALTY LTD.

SITINGS.CA / 604.684.6767

1595 - 650 West Georgia Street, Vancouver, BC V6B 4N8

LIAM MARCH

Personal Real Estate Corporation
Senior Associate

604.628.2583

liam@sittings.ca

PROJECT SUMMARY

Situated at 807-815 Hornby Street in Vancouver, this ±1,238 sq ft retail space offers a prime location just steps away from Robson Street, one of Vancouver's busiest shopping and commercial corridors. The space benefits from exceptional visibility with extremely high foot and vehicle traffic, providing great exposure for various businesses. Surrounded by a mix of retail shops, dining options, and essential services, the area offers a vibrant and dynamic atmosphere. With its proximity to major transit routes, accessing the space is convenient for both customers and employees. The versatile layout accommodates various retail applications, offering flexibility for different business needs. With its central location near Robson Street and significant traffic flow, this retail property presents a valuable opportunity for businesses seeking a prominent presence in Vancouver's downtown core.

- ✦ High foot and vehicle traffic
- ✦ Excellent visibility
- ✦ Prime location, steps away from Robson Street
- ✦ Proximity to SkyTrain and Public Transit
- ✦ Versatile ± 1,238 SF Retail Space
- ✦ Build Out completed in 2024



This document/email has been prepared by Sitings Realty Ltd. for advertising and general information only. Although information contained herein is from sources we believe reliable, Sitings Realty Ltd. makes no guarantees, representations or warranties of any kind, expressed or implied, regarding the information including, but not limited to, warranties of content, accuracy and reliability. This document/email is subject to errors and omissions and any interested party should undertake their own inquiries as to the accuracy of the information. Sitings Realty Ltd. excludes unequivocally all inferred or implied terms, conditions and warranties arising out of this document and excludes all liability for loss and damages arising there from. All areas, measurements and dimension herein are approximate, interested parties/tenant are to verify measurements if important to them. This document/email is not an inducement representation.

DETAILS

✚ Size: 1,238 SF

✚ Base Rent: Contact Listing Agent

✚ Commercial Parking: Reserved Parking Stall

✚ Additional Rent: \$23.98 PSF (est.)

AREA TENANTS



DEMOGRAPHICS

DRIVE TIME	3 MIN	5 MIN	10MIN
2024 Population	48,110	136,339	343,831
2029 Populations Projections	55,799	153,058	375,304
2024 Average HH Income	\$121,640	\$125,997	\$129,006
2024 Daytime Population	120,815	254,396	472,304

CONTACT

LIAM MARCH

Personal Real Estate Corporation
Sitings Realty Ltd

604.628.2583
liam@sitings.ca

AERIAL

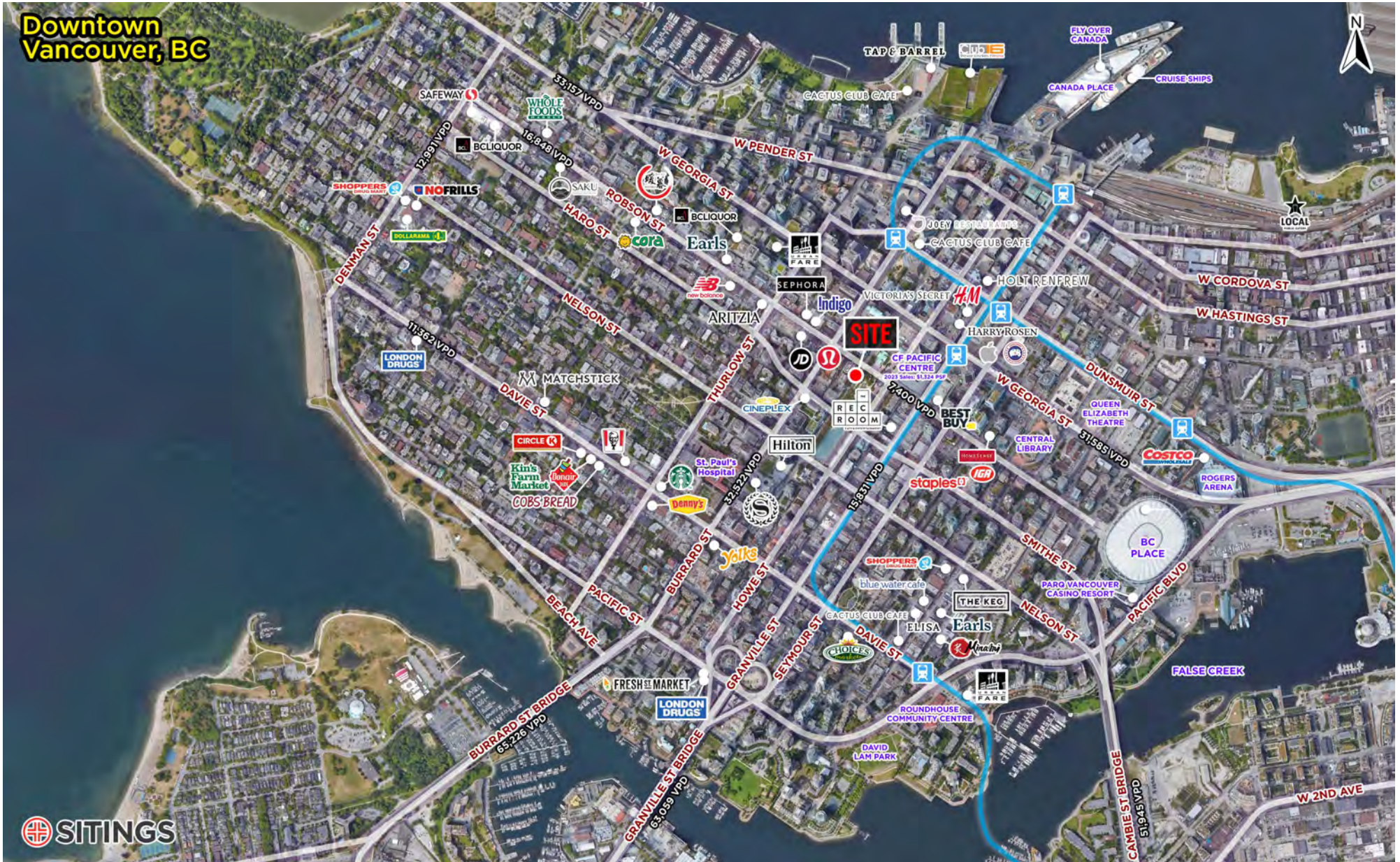

AERIAL

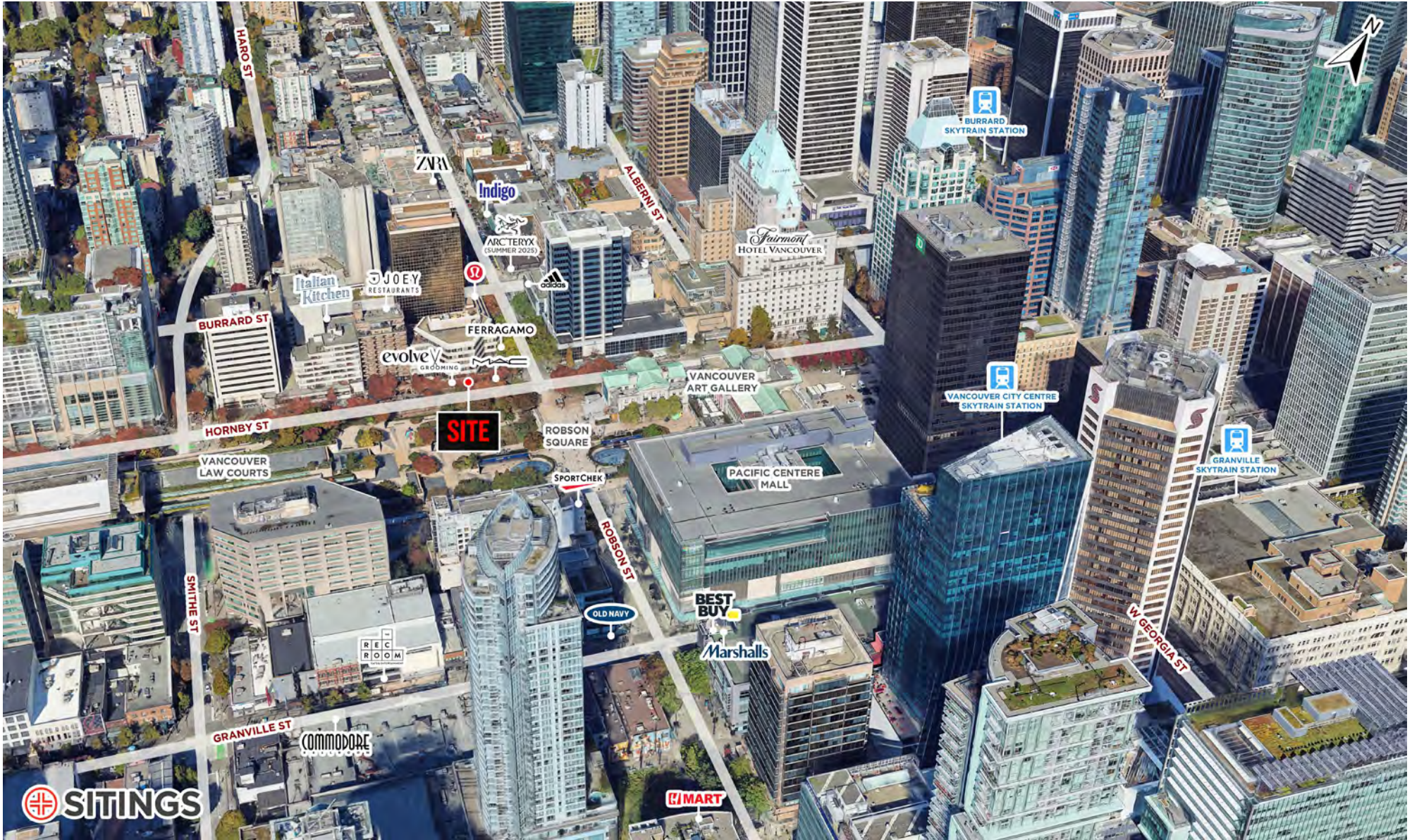

This document/email has been prepared by Sitings Realty Ltd. for advertising and general information only. Although information contained herein is from sources we believe reliable, Sitings Realty Ltd. makes no guarantees, representations or warranties of any kind, expressed or implied, regarding the information including, but not limited to, warranties of content, accuracy and reliability. This document/email is subject to errors and omissions and any interested party should undertake their own inquiries as to the accuracy of the information. Sitings Realty Ltd. excludes unequivocally all inferred or implied terms, conditions and warranties arising out of this document and excludes all liability for loss and damages arising there from. All areas, measurements and dimension herein are approximate, interested parties/tenant are to verify measurements if important to them. This document/email is not an inducement representation.

FLOOR PLAN

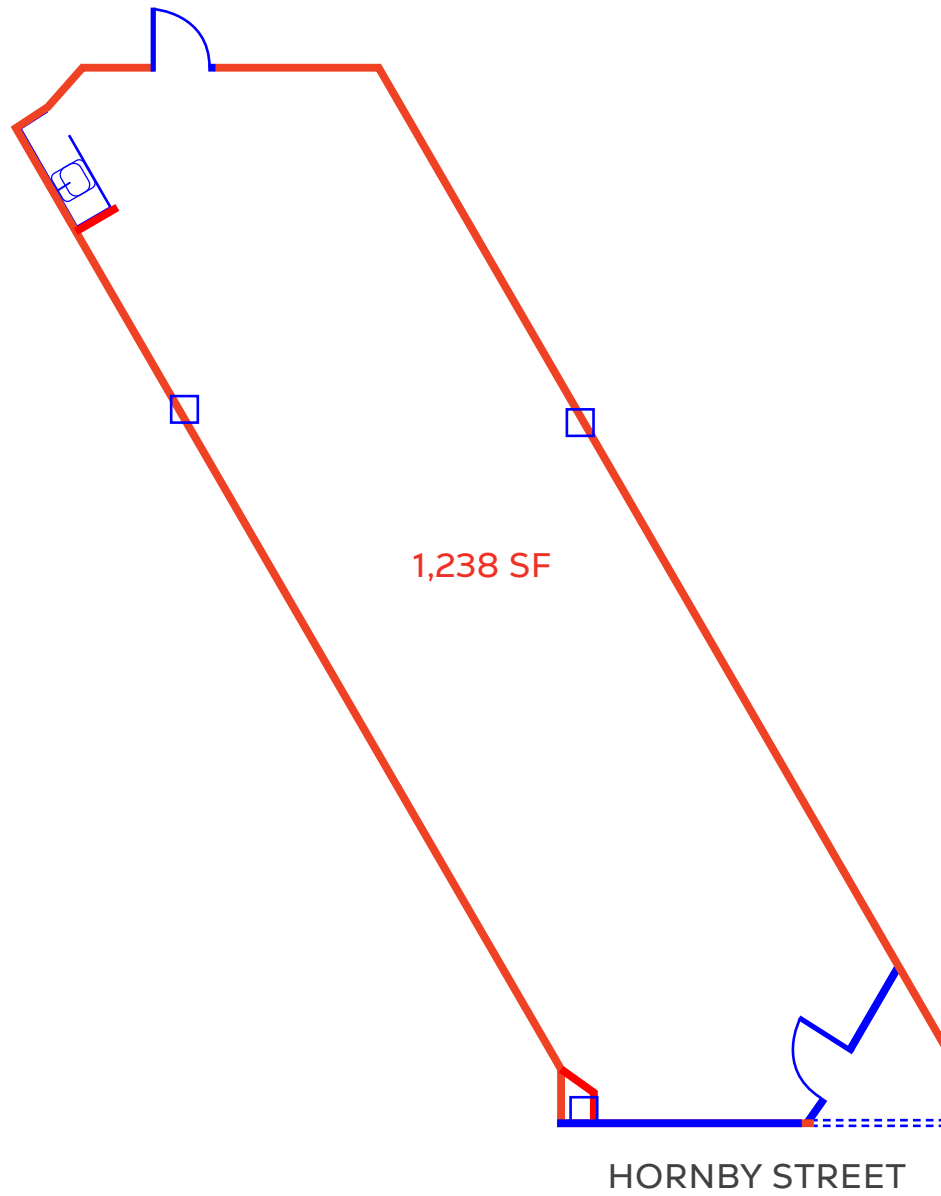

INTERIOR PHOTOS



EXTERIOR PHOTOS

