

RETAIL FOR LEASE

1,115 SF & 1,415 SF AVAILABLE

NEST

27 FAULKNER STREET, DARTMOUTH



CBRE

LOCATION

Dartmouth, often referred to as the “City of Lakes,” is a thriving community and the area around Faulkner Street is experiencing significant redevelopment, with multiple residential and mixed-use projects underway or proposed. Recent and ongoing developments in the vicinity include high-rise apartment buildings and mixed-use projects incorporating commercial space, contributing to a growing density and a robust customer base for future businesses.

27 Faulkner Street benefits from a central and easily accessible location. The area boasts excellent transit connectivity, with numerous bus lines serving Faulkner Street and its surroundings, ensuring convenient access for both employees and customers.

For those utilizing ferry services, the Alderney and Woodside ferry lines are also accessible. Along with great bike infrastructure, The Nest has a walk score of 82, meaning most errands can be accomplished on foot, highlighting the pedestrian-friendly nature of this area.

MARKET SNAPSHOT

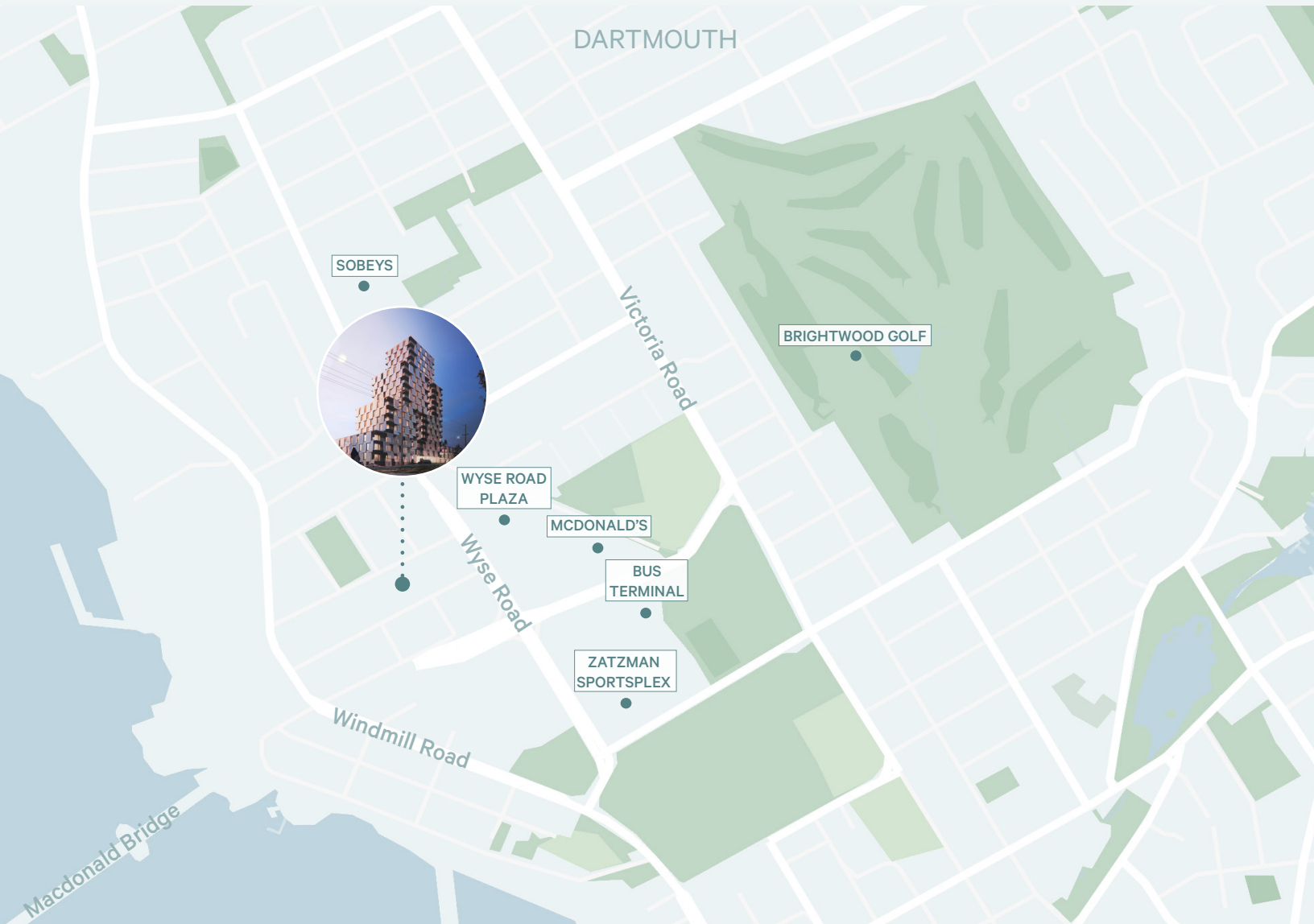

THE OPPORTUNITY

Discover an unparalleled opportunity for your business at 27 Faulkner Street, Dartmouth, a prime commercial location nestled in the vibrant part of HRM. The availabilities at The Nest would be ideal for retail and services, presenting significant potential for a variety of commercial ventures.

LOCATION

27 Faulkner Street, Dartmouth, NS

PROPERTY TYPE

210 Unit Residential With
Ground Floor Retail

SIZES

1,415 SF & 1,115 SF

RENT

Please Contact

AVAILABLE

Spring 2027

PARKING

Paid, Underground

ACCESSIBILITY

Wheelchair Accessible

HIGHLIGHTS

- High Ceilings
- New Construction
- Large Windows

IDEAL TENANTS



RETAIL



SERVICES



CAFE

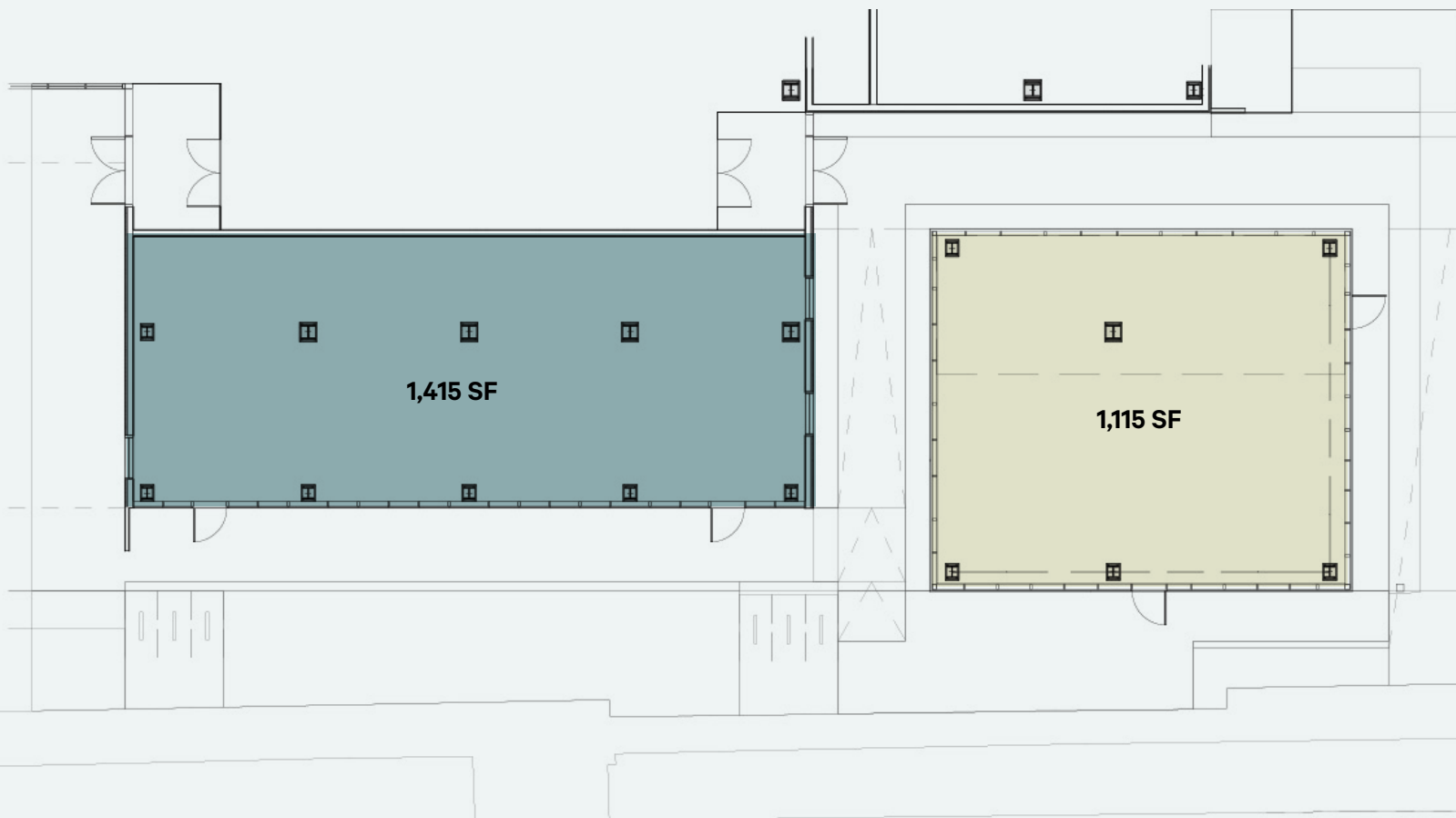



For More Information, please Contact:

MAT HOUSTON

Vice President
T 902 492 2074
mat.houston@cbre.com

BREANNA MACRURY

Sales Brokerage Associate
T 902 492 2082
breanna.macrury@cbre.com

CBRE

This disclaimer shall apply to CBRE Limited, Real Estate Brokerage, and to all other divisions of the Corporation; to include all employees and independent contractors ("CBRE"). The information set out herein, including, without limitation, any projections, images, opinions, assumptions and estimates obtained from third parties (the "Information") has not been verified by CBRE, and CBRE does not represent, warrant or guarantee the accuracy, correctness and completeness of the Information. CBRE does not accept or assume any responsibility or liability, direct or consequential, for the Information or the recipient's reliance upon the Information. The recipient of the Information should take such steps as the recipient may deem necessary to verify the Information prior to placing any reliance upon the Information. The Information may change and any property described in the Information may be withdrawn from the market at any time without notice or obligation to the recipient from CBRE. CBRE and the CBRE logo are the service marks of CBRE Limited and/or its affiliated or related companies in other countries. All other marks displayed on this document are the property of their respective owners. All Rights Reserved. Mapping Sources: Canadian Mapping Services canadamapping@cbre.com; DMTI Spatial, Environics Analytics, Microsoft Bing, Google Earth