



FOR LEASE 64,172 SF INDUSTRIAL FREESTAND

20 COMMANDER BOULEVARD
SCARBOROUGH, ON



CUSHMAN &
WAKEFIELD



20 COMMANDER BOULEVARD SCARBOROUGH, ON

BUILDING SPECS

Total Building Size:	64,172 SF
Office Area	8,687 SF
Warehouse Area	55,485 SF
Warehouse Clear Height:	16' 2"
Shipping Facilities:	4 Truck Level Doors 1 Drive In Door 1 "Van Level" Door
Asking Net Rent:	\$19.95 PSF
TMI:	\$5.16 PSF (2025)

Welcome to 20 Commander Boulevard - a quality freestanding industrial facility located in high demand North Scarborough. This property provides your company with full control over parking, shipping and product flow as well as providing a strong business image. The prime location is positioned for excellent access to highway #401 and to a vast labour pool. Well configured with 13% office offering a balanced layout for plant/warehouse and administrative functions. Excellent access to public transportation. Close proximity to many local amenities. Professionally managed & owned by Dream Industrial - ensuring a well-kept facility for your business success.

Landlord is undertaking significant upgrades that includes high-bay LED lighting throughout the warehouse. Approximately 4,000 SF of the offices is as air-conditioned tech/assembly area with tiled flooring & drop ceiling



20 COMMANDER BOULEVARD
SCARBOROUGH, ON



20 COMMANDER BOULEVARD SCARBOROUGH, ON

FLOOR PLAN - AREA USES

LEGEND

- Main Offices
- Tech area
- Plant/Warehouse
- Mezzanine

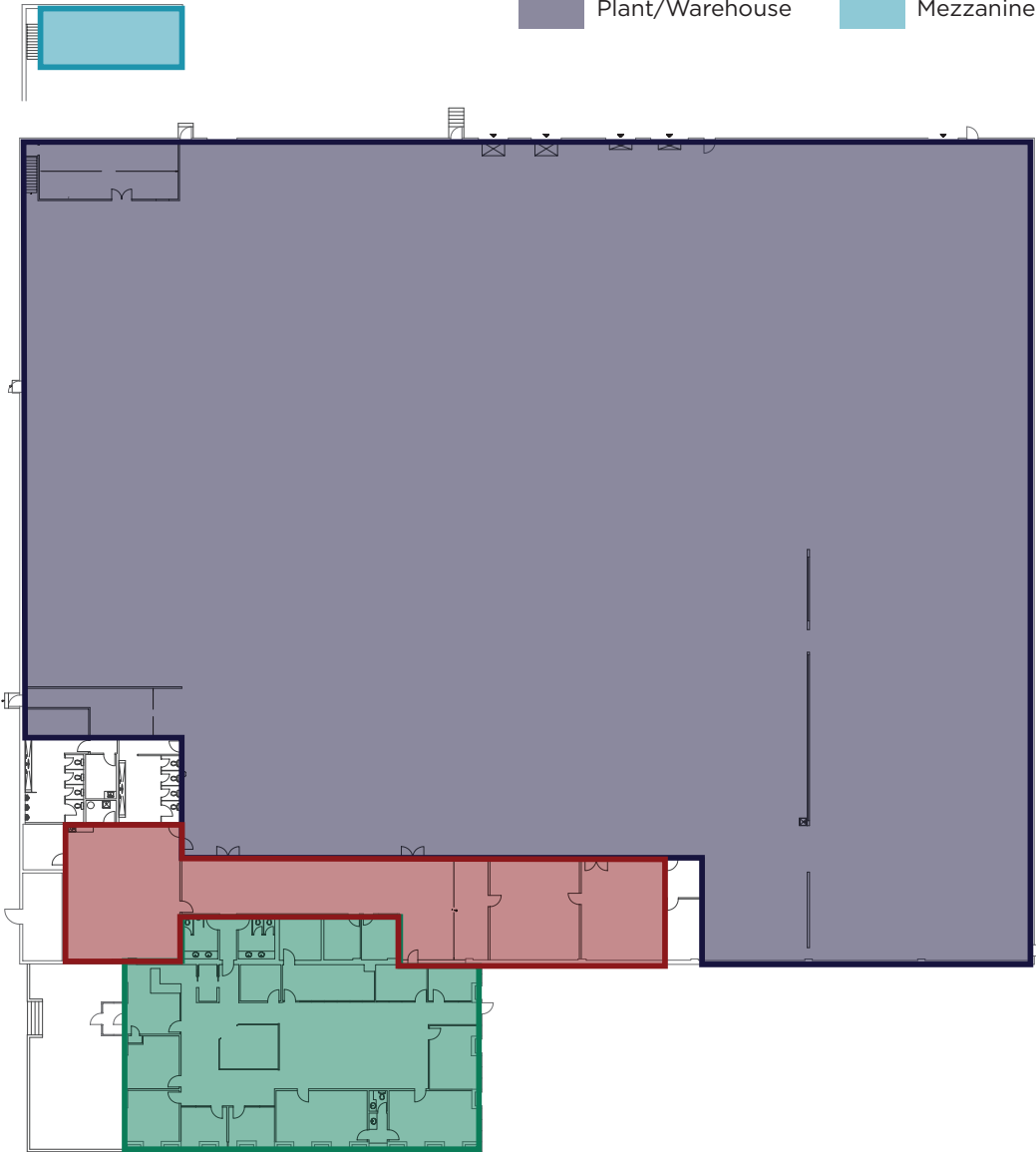

20 COMMANDER BOULEVARD SCARBOROUGH, ON

FLOOR PLAN

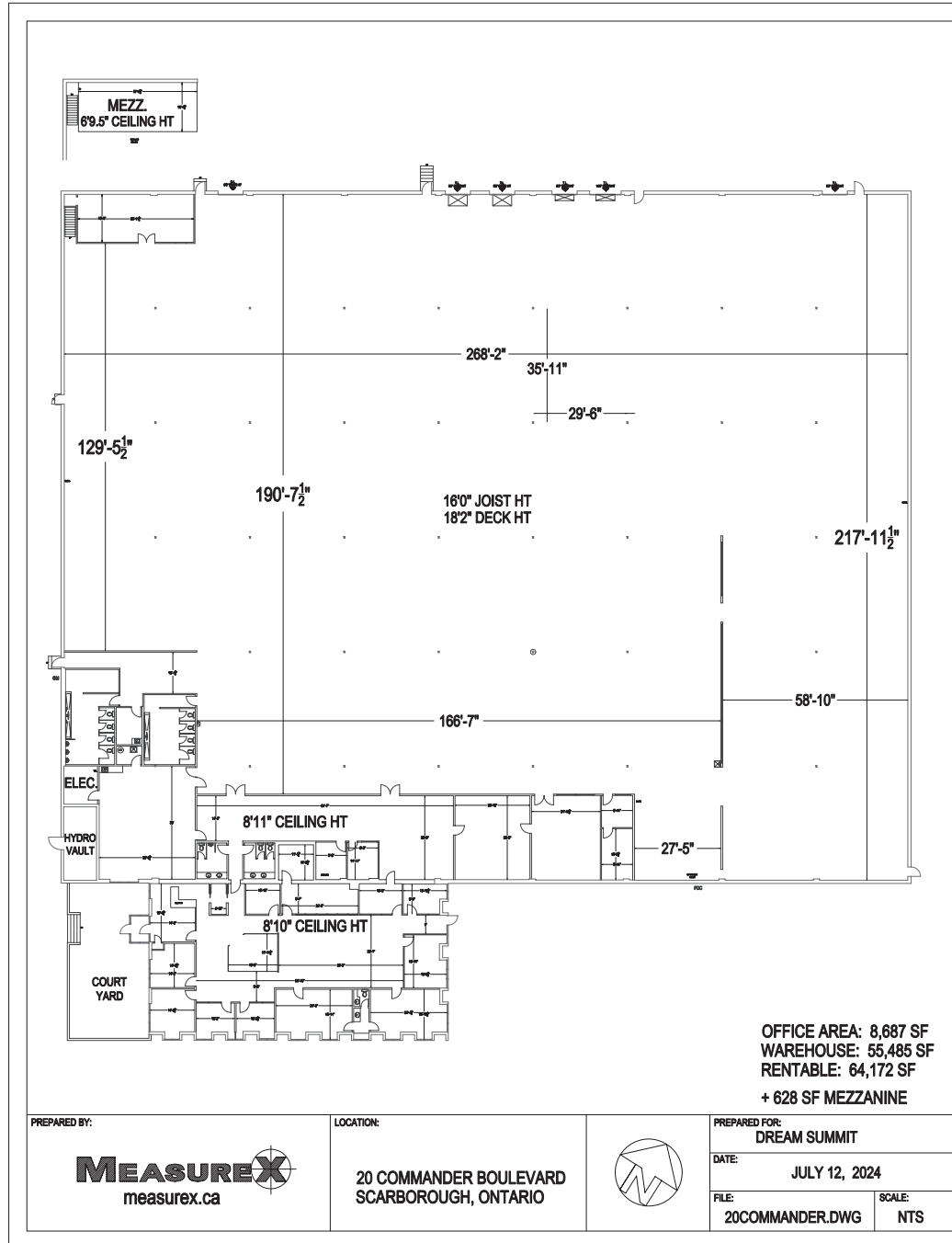

20 COMMANDER BOULEVARD SCARBOROUGH, ON

LOCATION MAP



Transit Lines: ■ Scarborough RT ■ Scarborough Subway Extension

Bus Routes: ■ Bus 85 ■ Bus 169 ■ Bus 130

20 COMMANDER BOULEVARD SCARBOROUGH, ON

PROXIMITY TO TORONTO AND AIRPORT



20 COMMANDER BOULEVARD

SCARBOROUGH, ON

ZONING PERMITTED USES

- Ambulance Depot
- Animal Shelter
- Artist Studio
- Automated Banking Machine
- Bindery
- Building Supply Yards
- Carpenter's Shop
- Cold Storage
- Contractor's Establishment
- Custom Workshop
- Dry Cleaning or Laundry Plant
- Financial Institution
- Fire Hall
- Industrial Sales and Service Use
- Kennel
- Laboratory
- Manufacturing
- Office
- Park
- Performing Arts Studio
- Pet Services
- Police Station
- Printing Establishment
- Production Studio
- Public Works Yard
- Service Shop
- Software Development and Processing
- Warehouse
- Wholesaling Use [By-law: OMB PL130592]
- Recreation Use
- Renewable Energy
- Retail Service
- Retail Store
- Shipping Terminal
- Transportation Use
- Vehicle Depot
- Vehicle Fuel Station
- Vehicle Repair Shop
- Vehicle Service Shop

PERMITTED USES WITH CONDITIONS

- Marihuana production facility
- Metal Factory involving Forging and Stamping
- Open Storage



FOR MORE INFORMATION, CONTACT:

GREG RACIC

Vice President
Sales Representative
Direct: +1 416 756 5465
Mobile: +1 416 629 4734
greg.racic@cushwake.com

MIKE BROWN

Senior Vice President
Sales Representative
Direct: +1 416 756 5416
Mobile: +1 647 802 8824
mike.brown@cushwake.com

MICHAEL WOOD

Associate
Mobile: +1 416 451 3535
Direct: +1 416 756 5406
michael.wood2@cushwake.com

1500 Don Mills Rd. Suite 401
Toronto, Ontario M3B 3K4
Direct: +1 416 494 9500
cushmanwakefield.com

©2025 Cushman & Wakefield ULC. All rights reserved. The information contained in this communication is strictly confidential. This information has been obtained from sources believed to be reliable but has not been verified. NO WARRANTY OR REPRESENTATION, EXPRESS OR IMPLIED, IS MADE AS TO THE CONDITION OF THE PROPERTY (OR PROPERTIES) REFERENCED HEREIN OR AS TO THE ACCURACY OR COMPLETENESS OF THE INFORMATION CONTAINED HEREIN, AND SAME IS SUBMITTED SUBJECT TO ERRORS, OMISSIONS, CHANGE OF PRICE, RENTAL OR OTHER CONDITIONS, WITHDRAWAL WITHOUT NOTICE, AND TO ANY SPECIAL LISTING CONDITIONS IMPOSED BY THE PROPERTY OWNER(S). ANY PROJECTIONS, OPINIONS OR ESTIMATES ARE SUBJECT TO UNCERTAINTY AND DO NOT SIGNIFY CURRENT OR FUTURE PROPERTY PERFORMANCE.

