

# FOR LEASE TERRACE PLAZA

5804 TERRACE ROAD, EDMONTON, AB



▷ 4,300 SF

▷ Mike Hoffert

Mike.Hoffert@  
MarcusMillichap.com  
+1 (587) 756 1550

Casey McClelland

Casey.McClelland@  
MarcusMillichap.com  
+1 (587) 756 1560

Kevin Glass

Kevin.Glass@  
MarcusMillichap.com  
+1 (587) 756 1570

## OPPORTUNITY

Terrace Plaza present an excellent commercial retail space available in Southeast Edmonton servicing the well established community. Take advantage of close proximity to Sherwood Park Freeway, 50th Street, and Capilano Mall.

## HIGHLIGHTS

- Commercial space: 4,300 SF available for lease
- Positioned within the well established Capilano community, greatly benefiting from access to major throughfares 50 Street and Terrace Road
- Average household income within the area is \$119,391 with an estimated population growth of 2.8% to 2023-2028
- Join Easy Financial, Panago, Subway, Mary Browns and more

**Marcus & Millichap**

**web:** MarcusMillichap.ca  
**email:** MGHretail@MarcusMillichap.com

# STATS + MAP / TERRACE PLAZA

5804 TERRACE ROAD, EDMONTON, AB

Terrace Plaza borders the Capilano neighbourhood of Edmonton and is surrounded by an abundance of commercial services, mature streets and a busy residential atmosphere. Located directly on along Terrace Road adjacent to Capilano Mall, a regional shopping centre located adjacent to the property, the area provides residents with a variety of commercial services within the immediate vicinity.

Capilano Mall	1 minute
50th Street	2 minutes
Bonnie Doon	8 minutes
Sherwood Park	9 minutes
Downtown Edmonton	10 minutes



**15,200**  
vehicles  
per day on  
Terrace Road



**EXPOSURE**  
58 Street &  
Terrace Road



**PARKING**  
ample street  
parking



**TRANSIT**  
directly in front  
of property



**\$119,391**  
household income  
average within 3 km



**30,788**  
daytime  
population



**MAIN  
FLOOR**  
commercial  
retail space

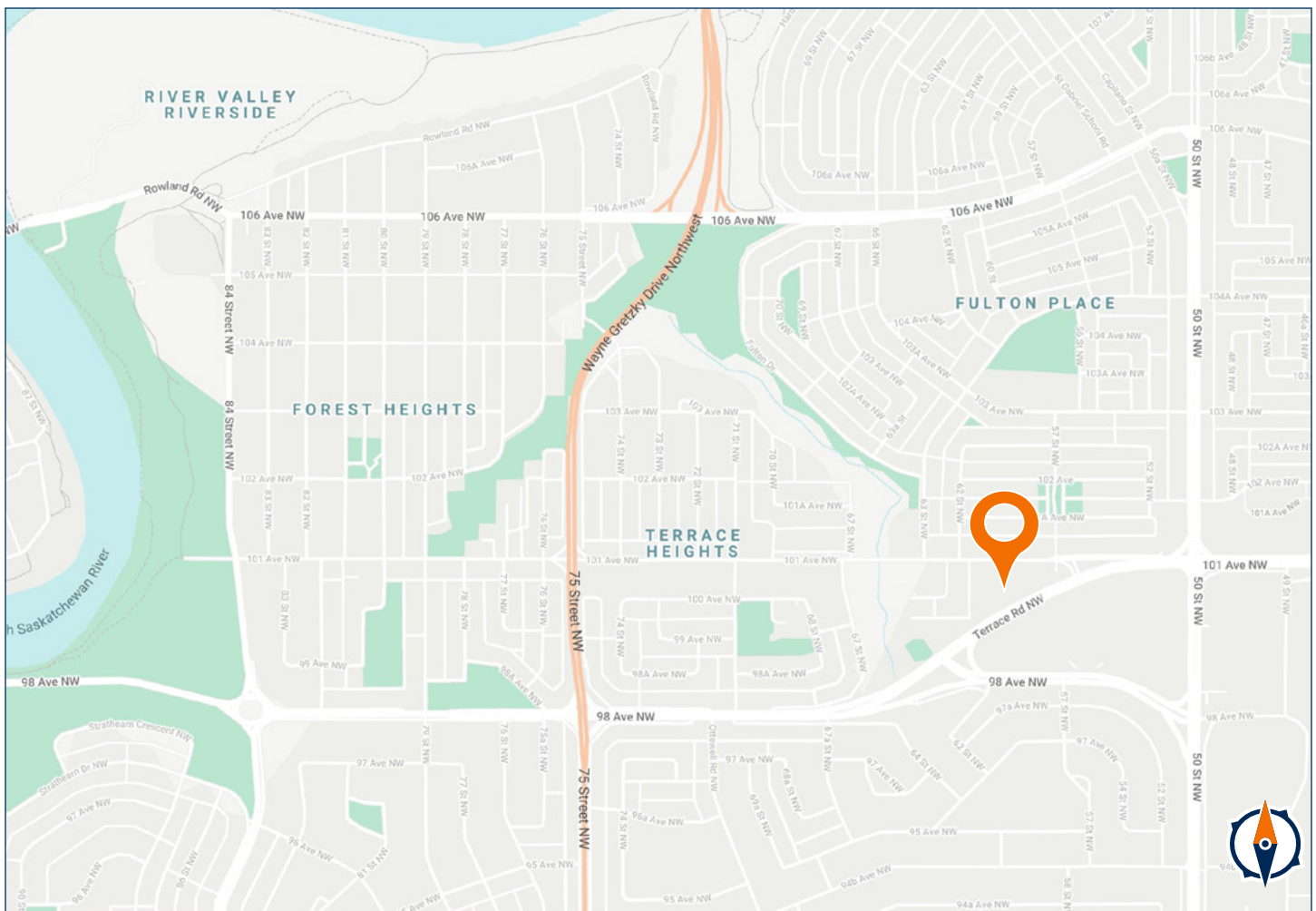



# SPECS + SITE PLAN / TERRACE PLAZA

5804 TERRACE ROAD, EDMONTON, AB

Municipal Address: 5804 Terrace Road, Edmonton

Lease Rate: Market

Legal Description: Plan 9220704, Block 2A, Lot 5

Units: 4,300 SF

Zoning: CSC - Commercial Shopping Centre

Available: Immediately

Operating Costs: \$10.48/SF (Estimate)

Parking: Ample Street Parking

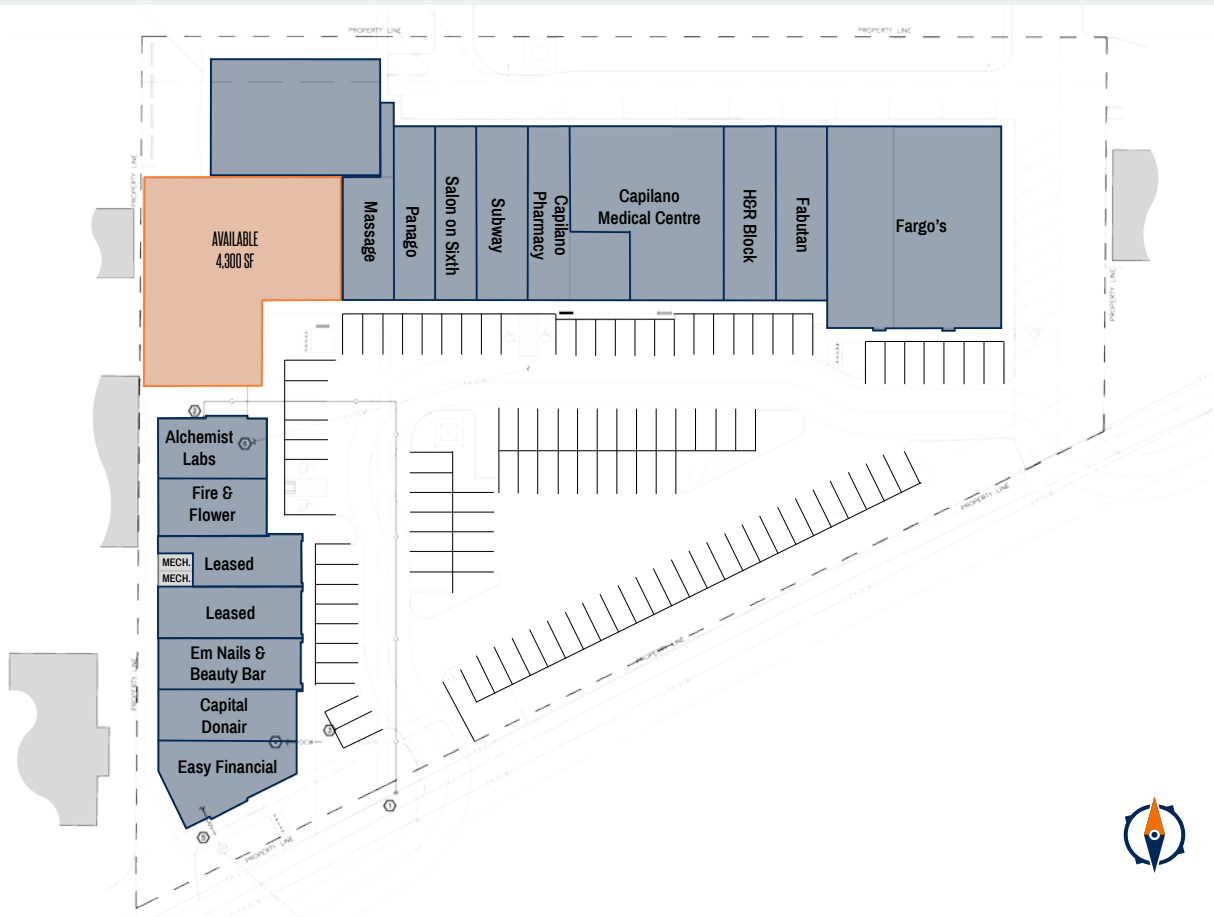





# Marcus & Millichap

Marcus & Millichap 10175 - 101 Street  
1820 Enbridge Centre Edmonton, AB T5J 0H3 +1 (587) 756 1600

Casey McClelland / Senior Vice President  
Casey.McClelland@  
MarcusMillichap.com  
+1 (587) 756 1560

Kevin Glass / Senior Associate  
Kevin.Glass@  
MarcusMillichap.com  
+1 (587) 756 1570

Mike Hoffer / Senior Associate  
Mike.Hoffer@  
MarcusMillichap.com  
+1 (587) 756 1550

The information contained in the following Marketing Brochure is proprietary and strictly confidential. It is intended to be reviewed only by the party receiving it from Marcus & Millichap Real Estate Investment Services Canada Inc. ("Marcus & Millichap") and should not be made available to any other person or entity without the written consent of Marcus & Millichap. This Marketing Brochure has been prepared to provide summary, unverified information to prospective purchasers, and to establish only a preliminary level of interest in the subject property. The information contained herein is not a substitute for a thorough due diligence investigation. Marcus & Millichap has not made any investigation, and makes no warranty or representation, with respect to the income or expenses for the subject property, the future projected financial performance of the property, the size and square footage of the property and improvements, the presence or absence of contaminating substances, PCB's or asbestos, the compliance with State and Federal regulations, the physical condition of the improvements thereon, or the financial condition or business prospects of any tenant, or any tenant's plans or intentions to continue its occupancy of the subject property. The information contained in this Marketing Brochure has been obtained from sources we believe to be reliable; however, Marcus & Millichap has not verified, and will not verify, any of the information contained herein, nor has Marcus & Millichap conducted any investigation regarding these matters and makes no warranty or representation whatsoever regarding the accuracy or completeness of the information provided. All potential buyers must take appropriate measures to verify all of the information set forth herein.

Marcus & Millichap is not affiliated with, sponsored by, or endorsed by any commercial tenant or lessee identified in this marketing package. The presence of any corporation's logo or name is not intended to indicate or imply affiliation with, or sponsorship or endorsement by, said corporation of Marcus & Millichap, its affiliates or subsidiaries, or any agent, product, service, or commercial listing of Marcus & Millichap, and is solely included for the purpose of providing tenant lessee information about this listing to prospective customers.

ALL PROPERTY SHOWINGS ARE BY APPOINTMENT ONLY. PLEASE CONSULT YOUR MARCUS & MILLICHAP AGENT FOR MORE DETAILS.

This information has been secured from sources we believe to be reliable, but we make no representations or warranties, expressed or implied, as to the accuracy of the information. References to square footage or age are approximate. Buyer must verify the information and bears all risk for any inaccuracies. Marcus & Millichap is a trademark of Marcus & Millichap Real Estate Investment Services, Inc. Used under license by Marcus & Millichap Real Estate Investment Services Canada Inc. © 2023 Marcus & Millichap. All rights reserved.