

For Lease



# 2130 South Service Road W

## Oakville, ON

- Available immediately
- 98,175 SF of warehouse and office space
- 4.43 acre single-tenant building on corner lot
- Excellent location fronting on QEW, great signage opportunity
- New roof completed in 2022
- 24' clear height
- Fully fenced shipping yard
- ESFR sprinkler system, T-8 lighting upgraded



Minutes away from major highways, public transit, 500m walk to Bronte GO Station.

For leasing  
opportunities

Kelly Willson Harvey, Director, Leasing | 647.642.6192 | [kwharvey@dream.ca](mailto:kwharvey@dream.ca)  
Andrew Cunningham, Associate VP | 905.601.2300 | [acunningham@dream.ca](mailto:acunningham@dream.ca)

Dream Industrial REIT  
[leasing.dream.ca](http://leasing.dream.ca)

# Floor Plan

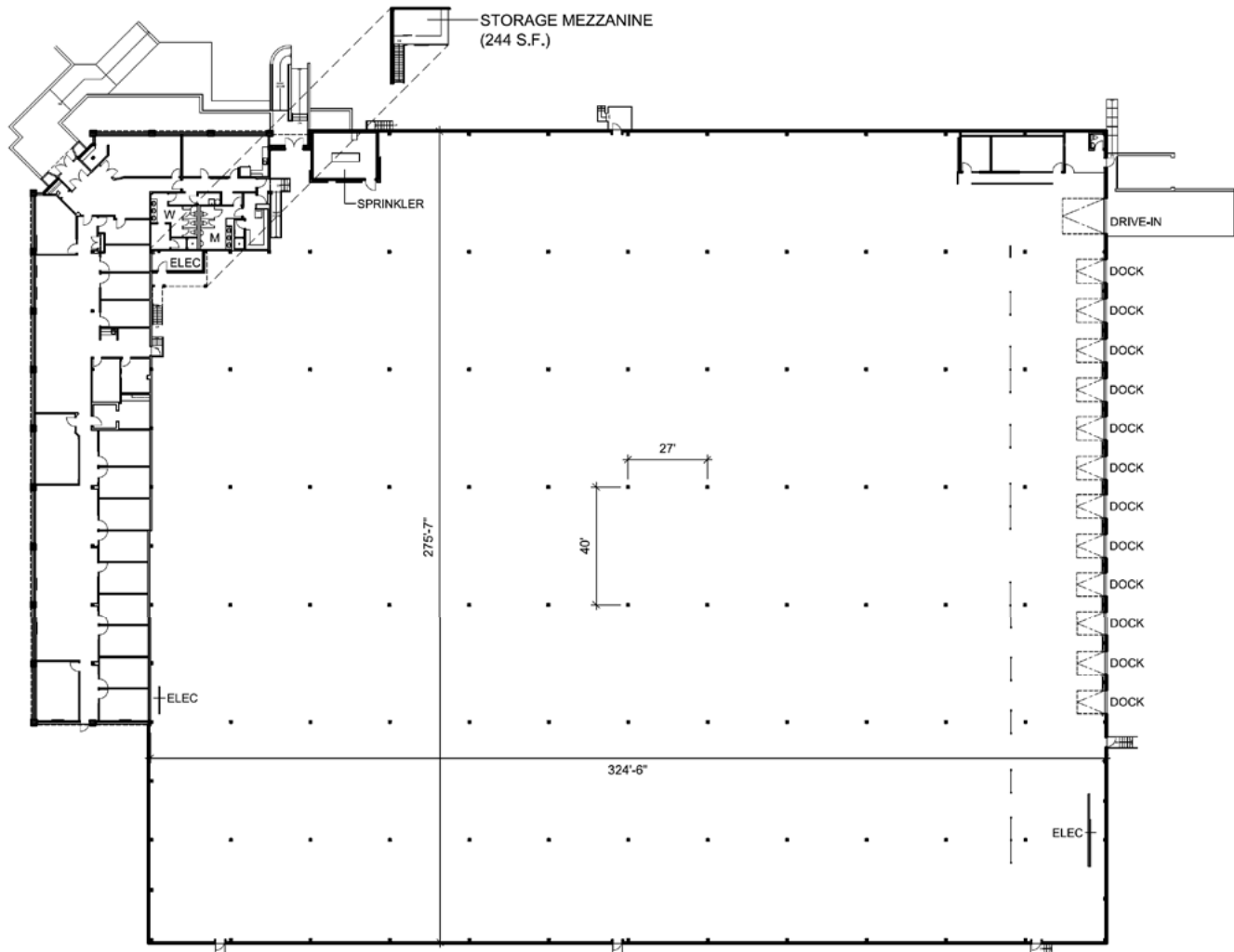

\*Floor plan may not be exactly as shown.

Available:	Total Warehouse area:	Clear Height:	Power:
<b>Immediately</b>	<b>88,735 SF</b>	<b>24"</b>	<b>400 Amps</b>
Loading:	Total Office area:	Additional Rent:	Zoning:
<b>10 dock-high doors, 2 drive-in door</b>	<b>9,440 SF</b>	<b>\$6.42 / SF</b>	<b>E2 SP:3</b>

# Photos



\*May not be exactly as shown.



\*May not be exactly as shown.