

Area Certification

As evidenced by our signature and in accordance with the BOMA Standard of Measurement for Industrial Buildings (ANSI/BOMA Z65.2-2012 Method A) we hereby certify that the Total Rentable Area of this premises is 9,503. Square Feet as indicated below.

*R. Schwanke*

KES Surveys Inc.

Note: As indicated by the red line in the drawing, all calculations are determined from the exterior finished surface of all exterior walls and center line of walls demising adjacent suites.

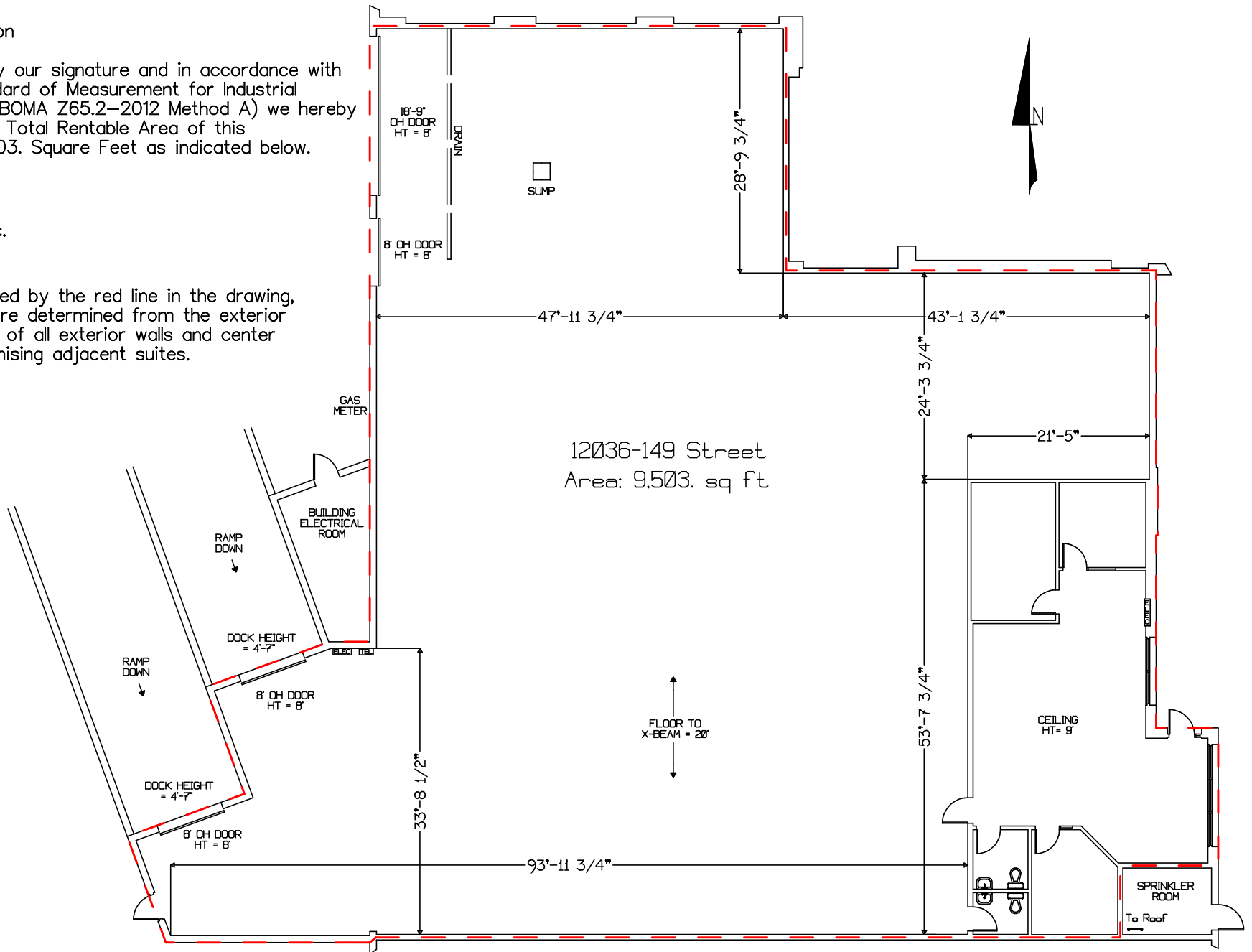

IMPERIAL EQUITIES INC  
 2150 Scotia Place  
 10060 Jasper Ave, Edmonton, AB

Drawing: 12036-149 St

Project: Coppertone V11  
 12036-149 Street  
 Edmonton, Alberta

Scale: Fit To Page

KES SURVEYS INC  
 t: 780-221-0206  
 e: kschwanke@shaw.ca

Drawn By: KS

Date: 4/27/20