

OFFICE SPACE  
FOR SUB-SUBLEASE

UNIT 801  
750 WEST  
PENDER  
VANCOUVER, BC

CBRE



## OFFICE SPACE | FOR SUB-SUBLEASE

8TH FLOOR  
3,603 SF



. Available Space  
**Unit 801**



. Availability  
**30 Days Notice**



. Size  
**3,603 SF**



. Sub-Sublease Expiry  
**May 29, 2027**



. Basic Rent  
**Contact Listing Broker**



. Furniture & Equipment  
**Available**



. Additional Rent  
**\$27.56 PSF (2024 estimate)**

## PRIME SUB-SUBLEASE OPPORTUNITY IN DOWNTOWN VANCOUVER'S BUSINESS CORE

Located in the heart of Downtown Vancouver's Central Business District, **750 West Pender Street** offers a prime sublease opportunity in a professionally managed, Class A office tower. This 17-storey building spans approximately 141,758 square feet and is home to a diverse mix of professional, government, and technical service tenants.

### PROPERTY HIGHLIGHTS



#### Financial District

Positioned in Vancouver's prestigious Financial District, 750 West Pender offers unmatched proximity to major corporate offices and businesses.



#### Dining

Steps from Vancouver's top eateries, 750 West Pender connects you to everything from fresh cafés to upscale global cuisine.



#### Entertainment

Enjoy access to a wide range of amenities across the CF portfolio, including premium fitness facilities and more.



#### Transit

Provides seamless underground connectivity to two SkyTrain lines—placing business, retail, and transit all within steps.



#### Shopping

750 West Pender offers direct lobby access to CF Pacific Centre

### FLOOR PLAN

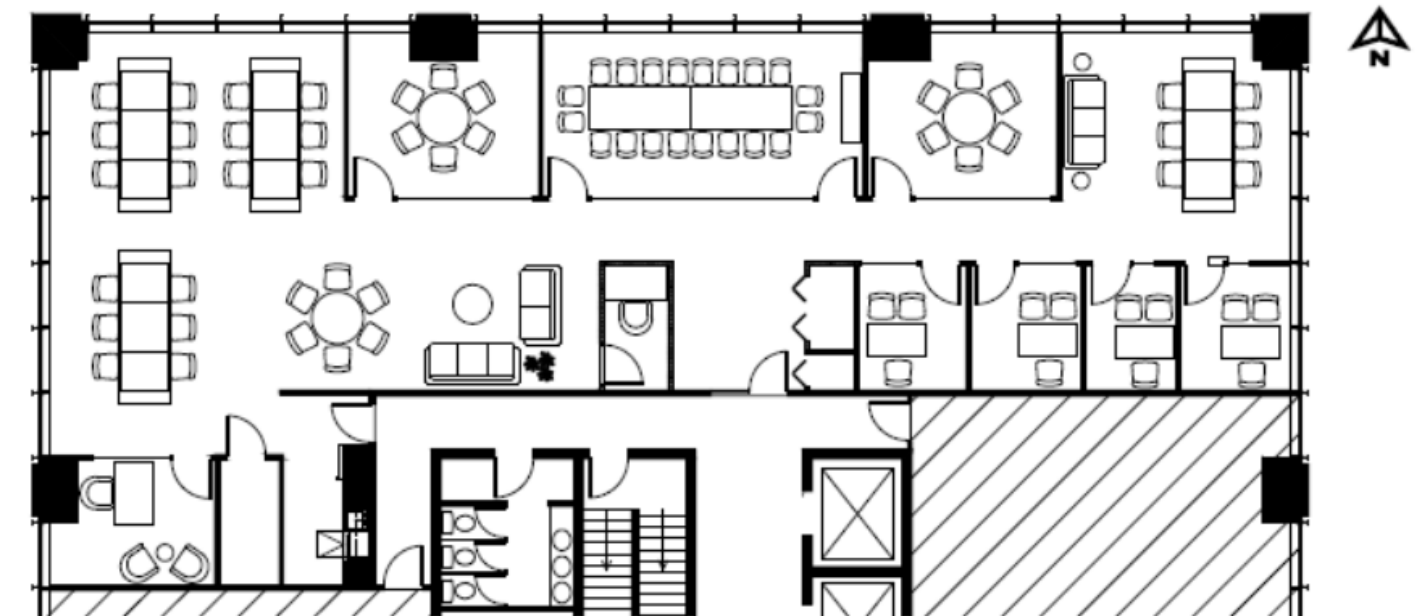

Floor plan not to scale

### SUITE HIGHLIGHTS

Elevator exposure

Five (5) offices

One (1) boardroom

Two (2) meeting rooms

Kitchen

Lounge

Call room

Storage

Open area with 24 workstations

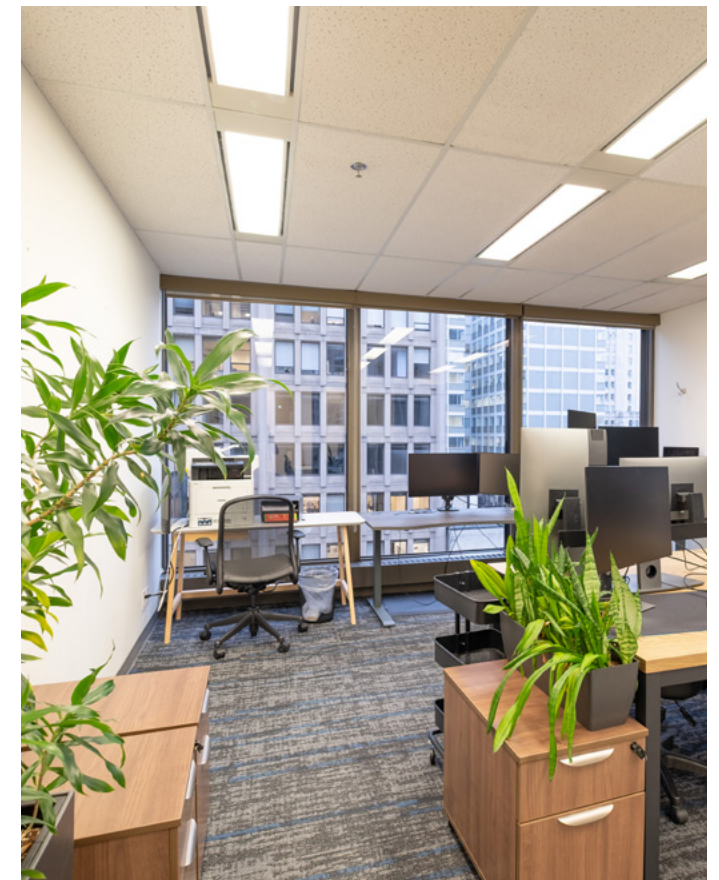

OFFICE SPACE | FOR SUB-SUBLEASE







8TH FLOOR  
3,603 SF





8TH FLOOR  
3,603 SF

# WHERE BUSINESS MEETS CONVENIENCE

Right in the heart of Vancouver's financial district, 750 West Pender offers a modern, 17-story office tower designed for today's professionals. Enjoy 24/7 access, secure lobby, and concierge services all in a space that feels both polished and practical. Step outside and you're connected to Pacific Centre Mall, SkyTrain, and Canada Line for effortless commuting. With underground parking, bike storage, a fitness centre, and even a tennis court, work-life balance has never been easier.

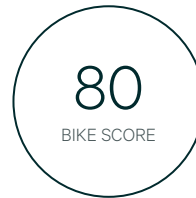
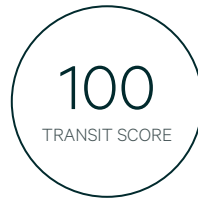
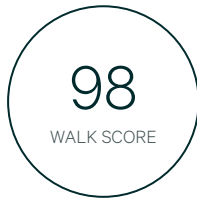
-  . SeaBus
-  . Bus
-  . SkyTrain
-  . WestCoast Express
-  . Sea Plane
-  . Helijet





## CONTACT

### **Brayden Sangha**

Personal Real Estate Corporation  
CBRE Limited | Office Leasing & Sales  
brayden.sangha@cbre.com  
604 662 5106

### **Graham Davidson**

Personal Real Estate Corporation  
604-916-6077  
Graham.davidson@colliers.com

# CBRE

CBRE Limited | 1021 West Hastings Street | #2500 | Vancouver, BC V6E 0C3 | [www.cbre.ca](http://www.cbre.ca)

This disclaimer shall apply to CBRE Limited, Real Estate Brokerage, and to all other divisions of the Corporation; to include all employees and independent contractors ("CBRE"). The information set out herein, including, without limitation, any projections, images, opinions, assumptions and estimates obtained from third parties (the "Information") has not been verified by CBRE, and CBRE does not represent, warrant or guarantee the accuracy, correctness and completeness of the Information. CBRE does not accept or assume any responsibility or liability, direct or consequential, for the Information or the recipient's reliance upon the Information. The recipient of the Information should take such steps as the recipient may deem necessary to verify the Information prior to placing any reliance upon the Information. The Information may change and any property described in the Information may be withdrawn from the market at any time without notice or obligation to the recipient from CBRE. CBRE and the CBRE logo are the service marks of CBRE Limited and/or its affiliated or related companies in other countries. All other marks displayed on this document are the property of their respective owners. All Rights Reserved.

Mapping Sources: Canadian Mapping Services [canadamapping@cbre.com](mailto:canadamapping@cbre.com); DMTI Spatial, Enviroics Analytics, Microsoft Bing, Google Earth.