

FOR LEASE

±4,500 Sq. Ft.

LIZOTTE

AND ASSOCIATES REAL ESTATE INC



Bay 5, 16638 - 110 Avenue, Edmonton, AB

OFFICE/WAREHOUSE

Property Highlights

- 3-ton overhead cranes with chain hoist
- 3 grade loading doors
- Floor drain
- Sump
- Washroom
- Quick access to 170 Street and Yellowhead Trail



780.488.0888



www.lizotterealestate.com



#1200, 10117 Jasper Avenue
Edmonton, AB T5J 1W8



No warranty or representation, expressed or implied, is made as to the accuracy of the information contained herein, and same is submitted subject to errors, omissions, change of price, rental or other conditions, withdrawal without notice, and to any specific listing condition, imposed by our principals.

FOR LEASE

West Sheffield Industrial Park

LIZOTTE
AND ASSOCIATES REAL ESTATE INC

Floor Plan

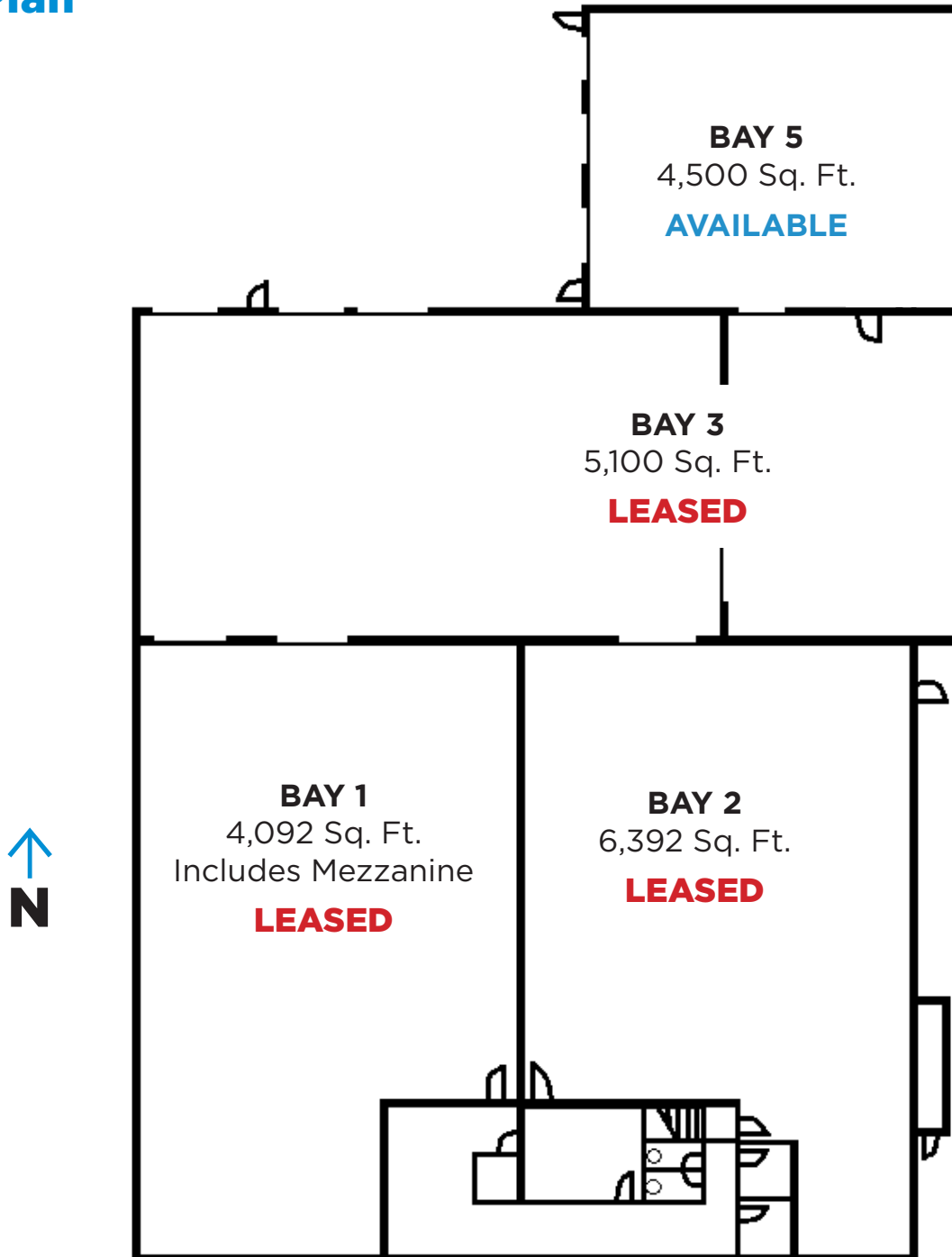

780.488.0888



www.lizotterealestate.com



#1200, 10117 Jasper Avenue
Edmonton, AB T5J 1W8

No warranty or representation, expressed or implied, is made as to the accuracy of the information contained herein, and same is submitted subject to errors, omissions, change of price, rental or other conditions, withdrawal without notice, and to any specific listing condition, imposed by our principals.

FOR LEASE

West Sheffield Industrial Park

LIZOTTE
AND ASSOCIATES REAL ESTATE INC

Property Information

Municipal Address: Bay 5, 16638 - 110 Avenue, Edmonton, AB

Legal Address: Lot 19, Block 5, Plan 2477KS

Size: 4,500 Sq. Ft. (+/-)

Zoning: IM (Medium Industrial)

Power: 225 Amp 120/240 Volt 3 Phase

Loading: (3) 16'x14' Grade

Heat: Forced Air/Radiant

Cranes: 3-ton

Ceiling Height: TBC

Parking: Surface parking

Possession: Immediate/ negotiable

\$\$\$

Lease Rate: \$11.00/Sq.Ft.

OP Cost: TBC

Contact

Richard Lizotte
President/Broker
Cell: 780.292.1871
Direct: 780.784.5360
richard@lizotterealestate.com

Lee Berger
Associate Broker
Cell: 587.983.6654
Direct: 780.784.5363
lee@lizotterealestate.com

