



*PHASE 2*  
**PIONEER CROSSING  
OPENING FALL 2026!**

**\$34 SF**

**PRIME 1,300 SF RETAIL OPPORTUNITY IN THE NEW  
BALLPARK DISTRICT**

**Ballpark Way, Spruce Grove, AB**

 **ROYAL LePAGE  
COMMERCIAL**

# FEATURES

- Phase 2 prime retail location at Pioneer Crossing
- Located in the heart of Spruce Grove's brand new Ballpark District
- High traffic volume: 25,000 +/- vehicles a day
- Direct access to Highway 16 & 7 minutes to West Edmonton
- Zoned C2- suitable for a variety of uses
- Situated next to the Myshak Ballpark Stadium

# SITE PLAN

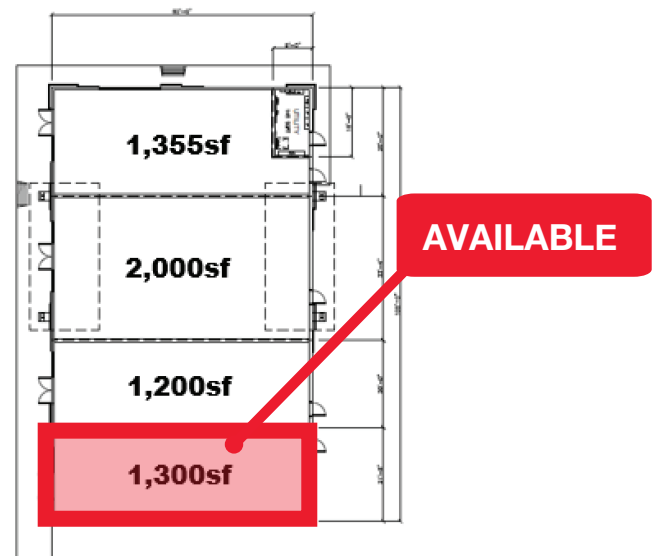
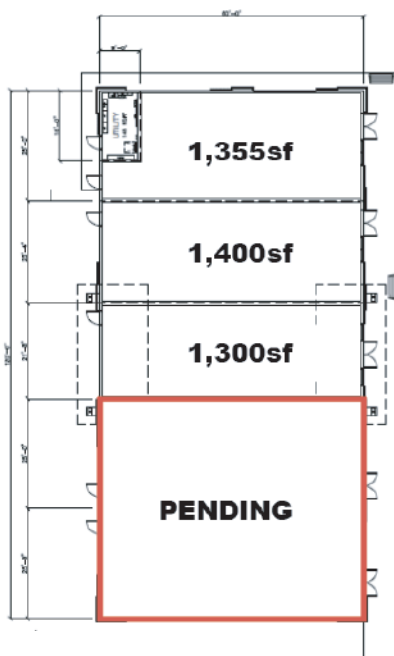
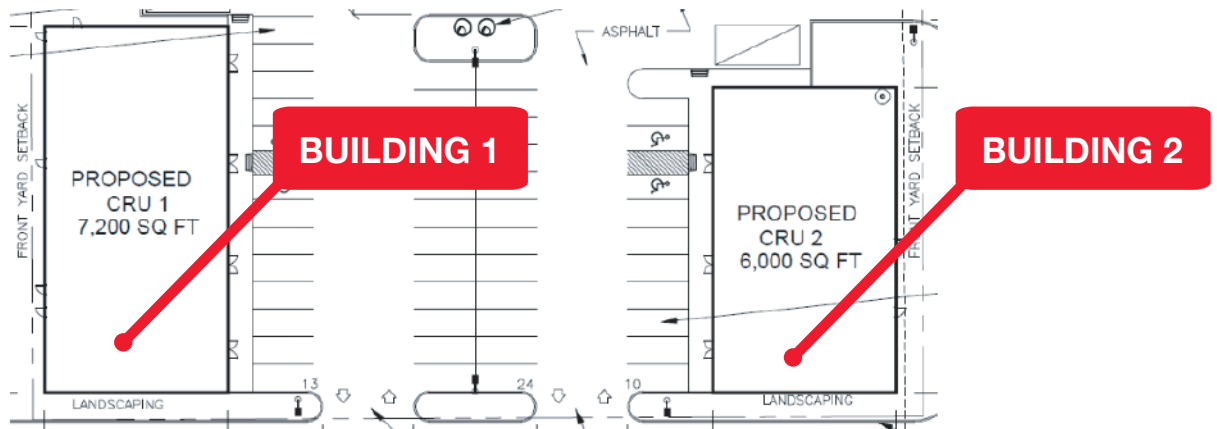

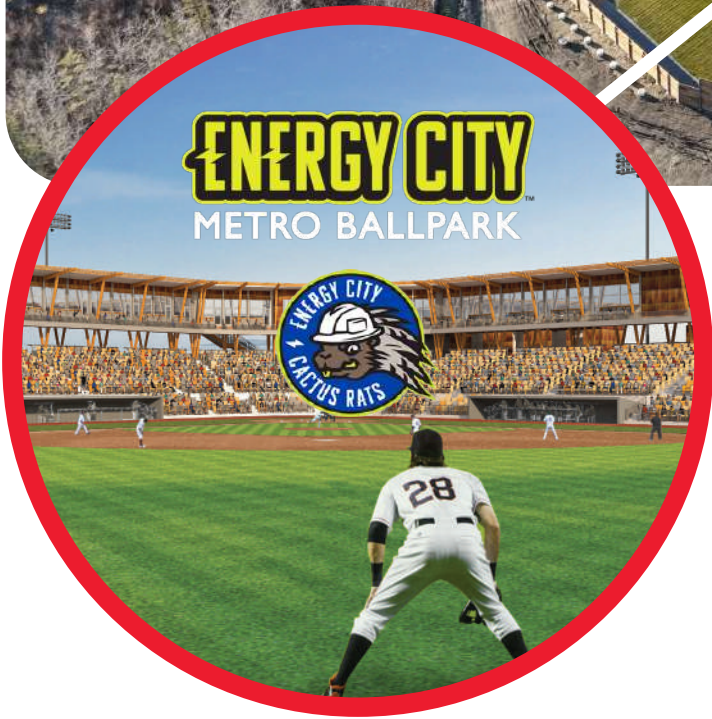

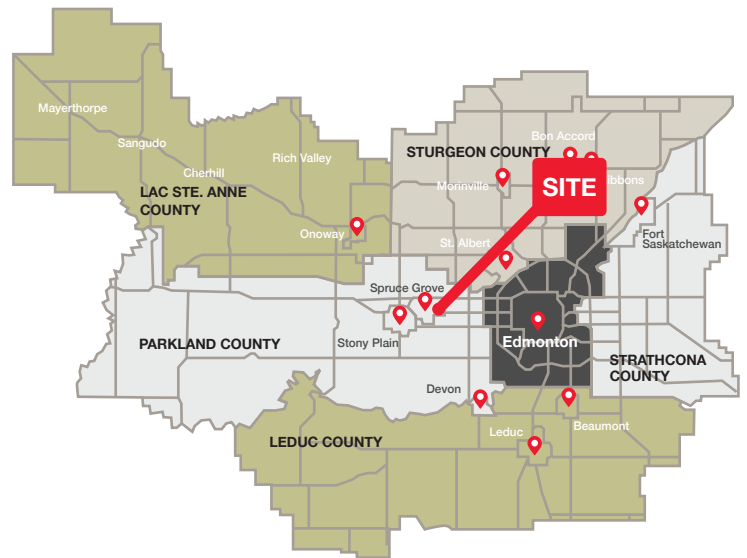

# Victor Moroz

ASSOCIATE BROKER

780.499.6400  
Victor@RoyalLePage.ca

**DEVELOPER & AGENT  
HERE TO MAXIMIZE  
YOUR COMMERCIAL VALUE**