

**FLOOR PLAN**

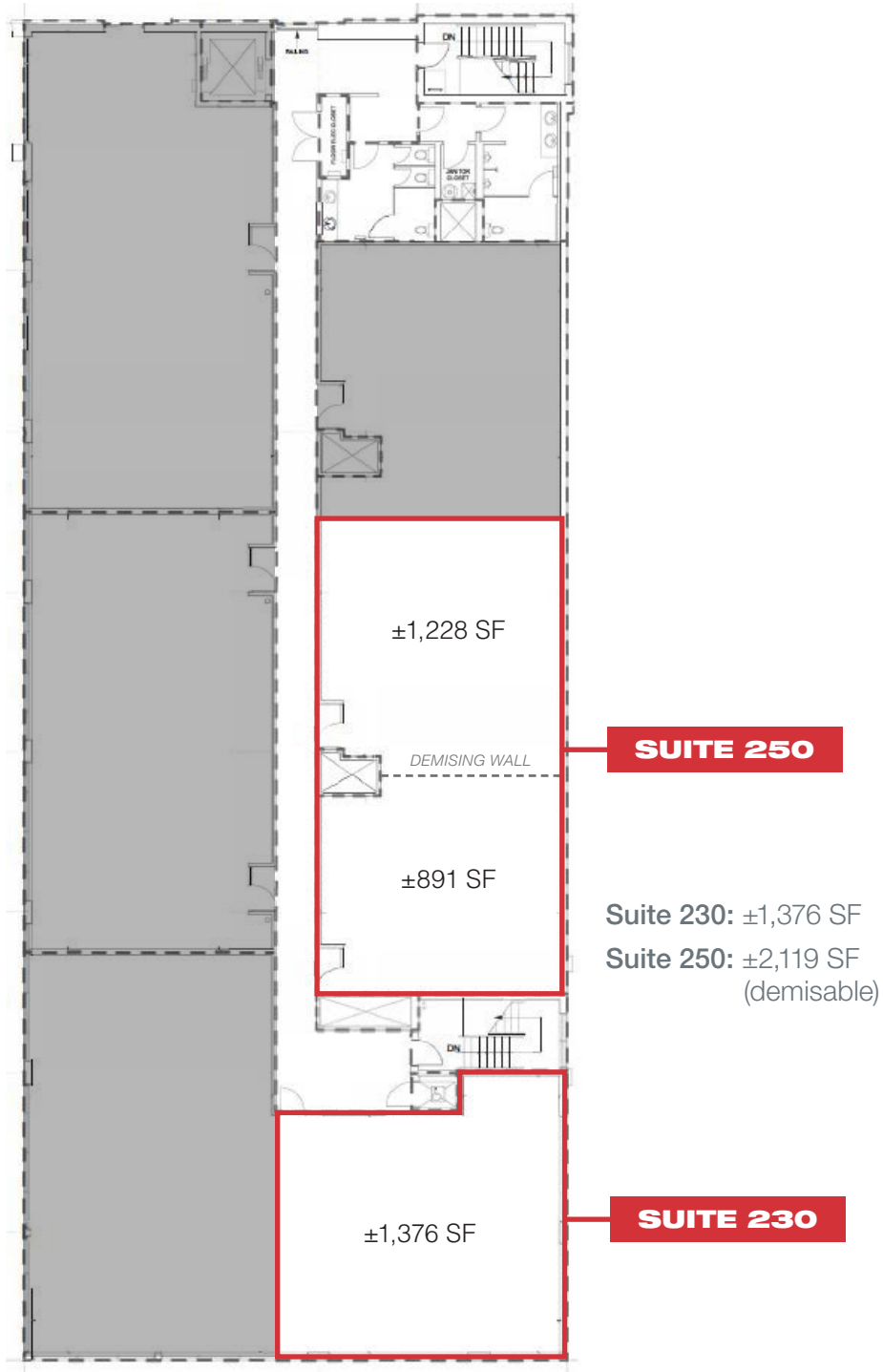

For more info,  
please contact:



**Stan Sandhu**  
+1 587-223-7653  
[stan@stansandhu.com](mailto:stan@stansandhu.com)

**Loveleen Bhatti, Executive VP**  
+1 403 973 4360  
[lbhatti@naiadvent.com](mailto:lbhatti@naiadvent.com)

**Roseleen Bhatti, Executive VP**  
+1 403 605 2294  
[rbhatti@naiadvent.com](mailto:rbhatti@naiadvent.com)