

# MAKE YOUR MARK

2630 + 2680

SKY MARK

MISSISSAUGA



LEASING AVAILABILITIES

CROWN



2630 and 2680 Skymark Avenue is a prominent two-tower Class A office complex in the Airport Corporate Centre totaling 250,233 sq. ft. The property has been recently revitalized with upgraded lobbies, washrooms, elevators, and elevator lobbies.

Tenants enjoy standout on-site amenities including a renovated lobby, fitness centre, full-service food provider, and an exclusive outdoor hub with seating and games. Ideally located with quick access to 400-series highways, public transit, and just 500 metres from the BRT, Skymark Avenue offers exceptional connectivity and a high-quality workplace designed to help your business stand out and make your mark.



# FIRST IMPRESSIONS MATTER

NEWLY RENOVATED LOBBY

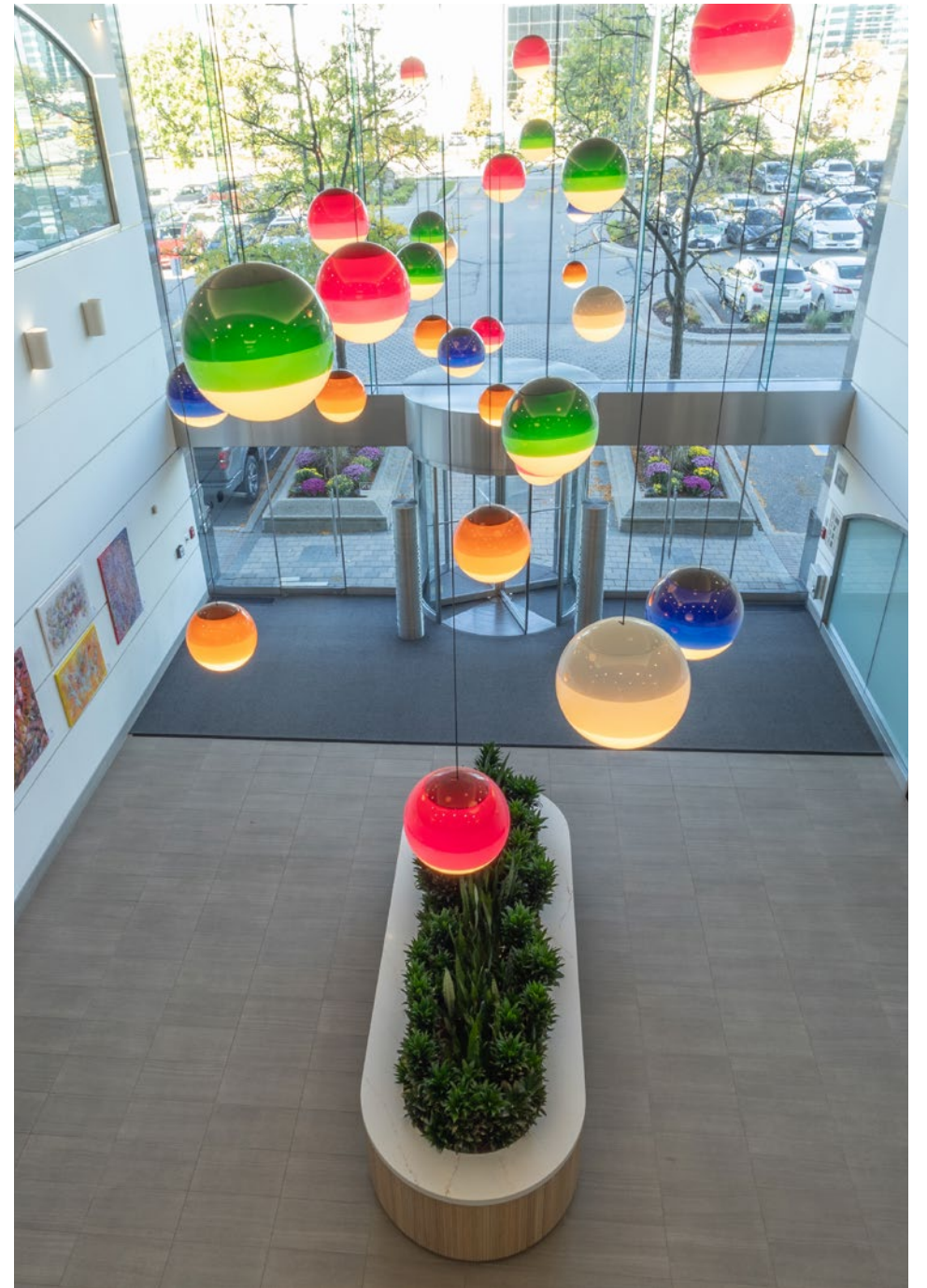
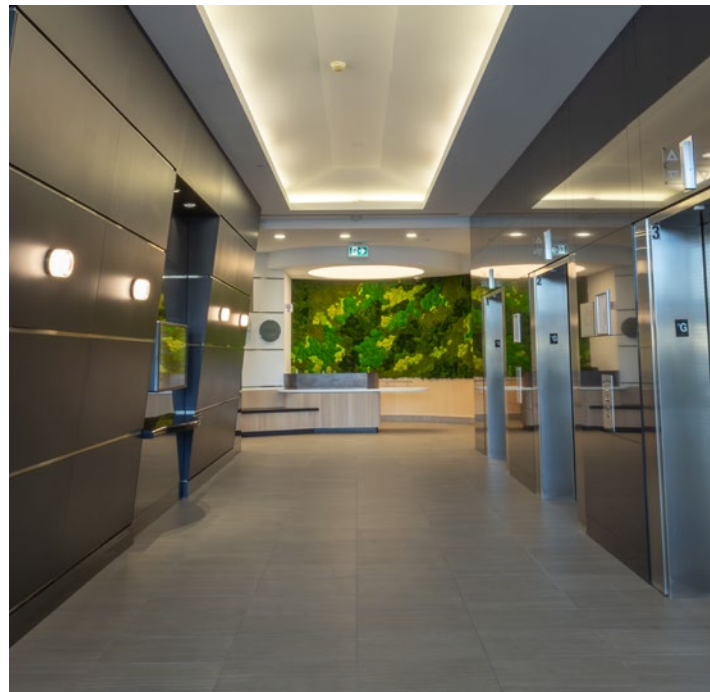

# WORKPLACE. COMMUNITY.



EXCEPTIONAL SPACE

Join a tech focused workplace community at 2630 and 2680 Skymark with brands such as Dell, Fiserv, DCR Industries and Primus calling the complex home. To enhance the 2630 and 2680 Skymark experience, Crown will be implementing a large-scale property repositioning which will include move-in ready model suites, collaborative areas among other upgrades!

MOVE-IN READY MODEL SUITES



PYLON SIGNAGE AVAILABLE

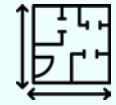

PLENTY OF SPACE  
OPTIONS AVAILABLE



MOVE-IN READY  
MODEL SUITES

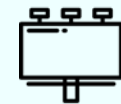

MAKE YOUR MARK WITH  
PYLON SIGNAGE

# EVERYTHING. HERE.

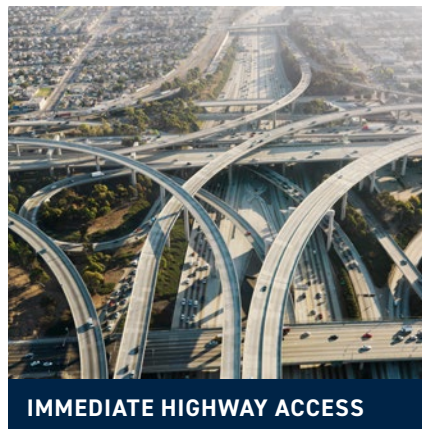
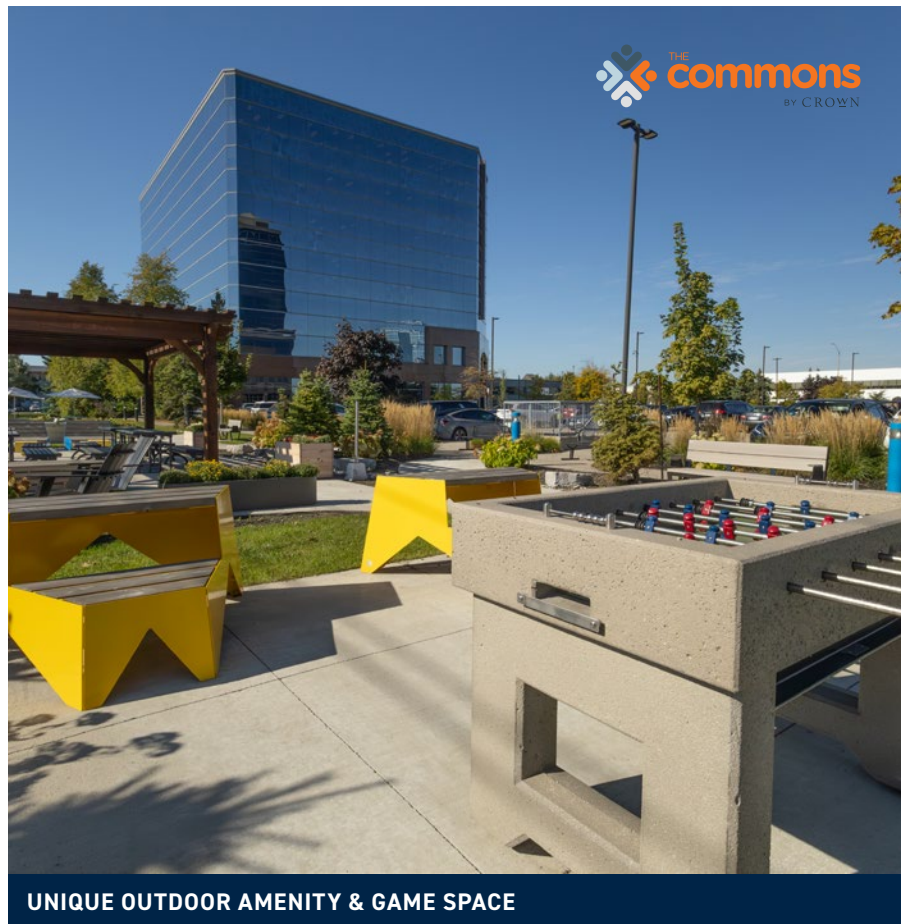

**ABUNDANT SURFACE PARKING  
& EV STATIONS**



**MINUTES FROM PEARSON  
INTERNATIONAL AIRPORT**



**AMAZING ON-SITE &  
AREA AMENITIES**

# AREA AMENITIES



Located in the Airport Corporate Centre - one of the most convenience locations in the GTA West node - 2630 and 2680 Skymark is moments from highways, transit lines and amazing amenities and conveniences, including restaurants, fitness centres, banks, hotels and parks. Only 10 minutes from Toronto's Pearson International Airport, 2630 and 2680 Skymark's location puts it in a convenient position for business travelers.

## TRANSIT ROUTES

- 1 RENFORTH STATION**  
MiWay: 7, 21, 24, 35, 35A, 39, 43, 87, 107, 109  
TTC: 32A, 112B  
GO Transit: Pearson Airport - Richmond Hill Square One/North York Finch Terminal
  - 2 ORBITOR STATION**  
MiWay: 35, 35A, 87, 107, 109
  - 3 SPECTRUM STATION**  
(MiWay - 35, 35A, 87, 107, 10)
-  **BRT 107/109, 35, 112** - every 8 minutes  
23 minutes to Square One  
15 minutes to Kipling Station
- ROUTE 7** - every 12 minutes  
15 minutes to Pearson International Airport

# BIG BLOCK OPPORTUNITIES



SCAN FOR OUR LATEST LEASING AVAILABILITIES

**Suite 300**  
**13,154 SF**

**Suite 200**  
**13,054 SF**

**Suite 101**  
**5,614 SF**  
**South Side**



FLEXIBLE SPACE



BUILD YOUR BRAND  
BUILD YOUR CULTURE



ROOM TO GROW

## ABOUT CROWN

Founded in 2001, Crown Realty Partners acquires, leases, manages and redevelops commercial real estate assets across Canada. Crown has a well established track record, an experienced team and takes a hands-on approach to provide superior returns for our investors and better workplaces for businesses operating within our portfolio.

The Partners of Crown co-invest alongside the corporations, institutions, pension funds and high net worth individuals that entrust us with their capital, ensuring strong alignment of interests.

CROWN

For more information about the property or to arrange a tour, please contact:

Ryan McAskile\*  
Director, Leasing  
647-727-4544

[rmcaskile@crp-cpmi.com](mailto:rmcaskile@crp-cpmi.com)

Henna Nankani\*\*  
Leasing Associate  
905.622.0650

[hnankani@crp-cpmi.com](mailto:hnankani@crp-cpmi.com)

[crownrealtypartners.com](http://crownrealtypartners.com) | [@CrownCRP](https://www.instagram.com/CrownCRP)



© 2026 CPMI Realty Inc., Brokerage. Location, buildout and features are subject to change without notice. Renderings are artist's concept and are subject to change. All dimensions are approximate and actual usable area may differ from that stated herein. \*Broker \*\*Sales Representative E.&O.E.

## TAKE CONTROL OF YOUR WORKDAY.

The **Connect by Crown** mobile app gives tenants on-demand access to amenities, communication with property management, and the office community.

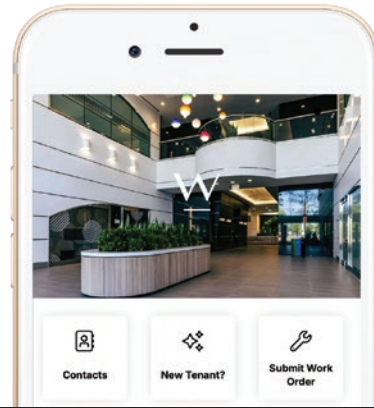

MAKE  
YOUR  
MARK