

UNION STATION

123 MAIN STREET, WINNIPEG

2nd Floor

Contiguous: **45,380 sf** (half of 3rd & entire 4th floor)
Largest contiguous: **77,591 sf** (half of 2nd, entire 3rd & 4th Floor)

- Unit 203: 1,150 sf – east view (south wing)
- Unit 201: 9,266 sf – corner unit north & west view (north wing)
- Unit 202: 5,127 sf – corner unit north & east view (north wing)
- Unit 201/02: 14,393 sf – entire north wing

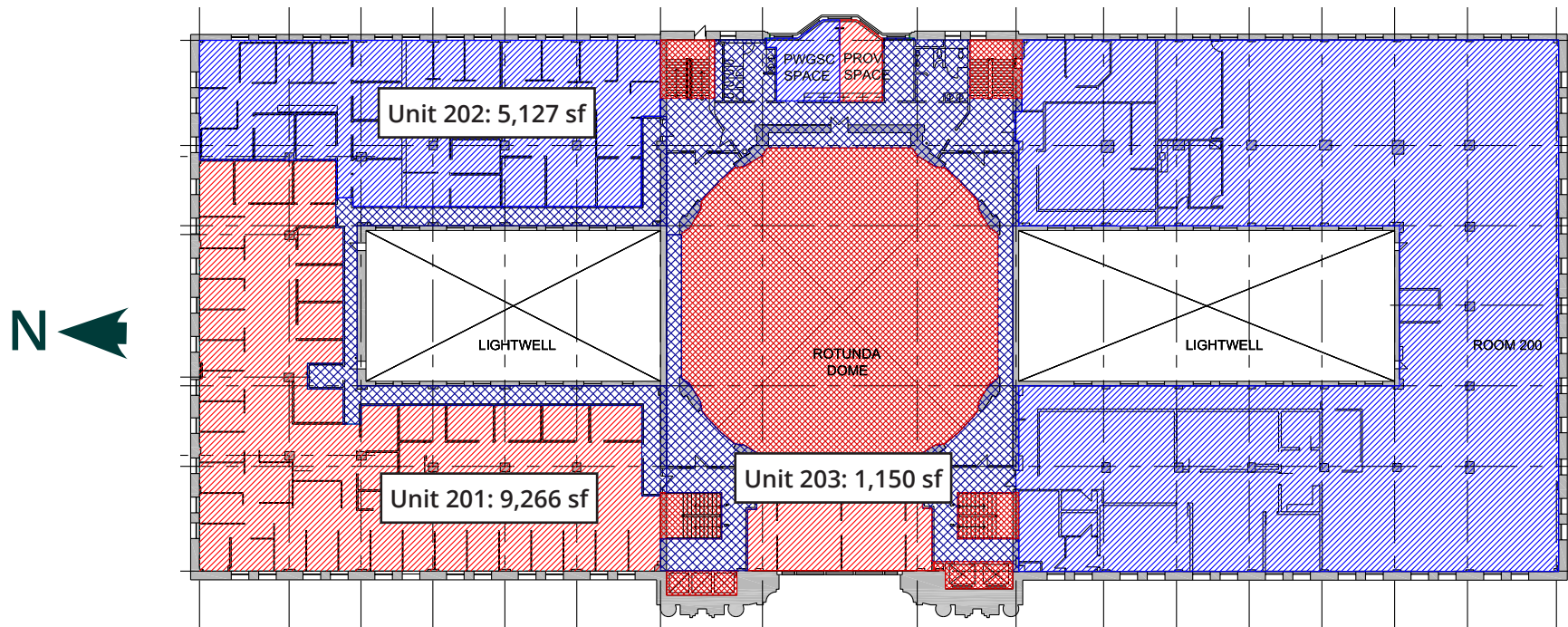

Wes Schollenberg

Managing Director, Broker
204.560.1501
wes.schollenberg@avisonyoung.com

Linda Capar

Vice President
204.560.1503
linda.capar@avisonyoung.com

Paul Douglas

Senior Associate
204.560.1504
paul.douglas@avisonyoung.com

Steven Luk Pat

Associate
204.560.1512
steven.lukpat@avisonyoung.com

**AVISON
YOUNG**

avisonyoung.com

UNION STATION

123 MAIN STREET, WINNIPEG

3rd Floor

Contiguous: **45,380 sf** (half of 3rd & entire 4th floor)
Largest contiguous: **77,591 sf** (half of 2nd, entire 3rd & 4th Floor)

- Unit 360: 5,863 sf – corner unit north and east view (north wing)
- Unit 350: 2,300 sf – corner unit northwest view (north wing)
- Unit 301: 2,415 sf – west view overlooking Main Street (north wing)
- Unit 310: 13,565 sf – entire north wing

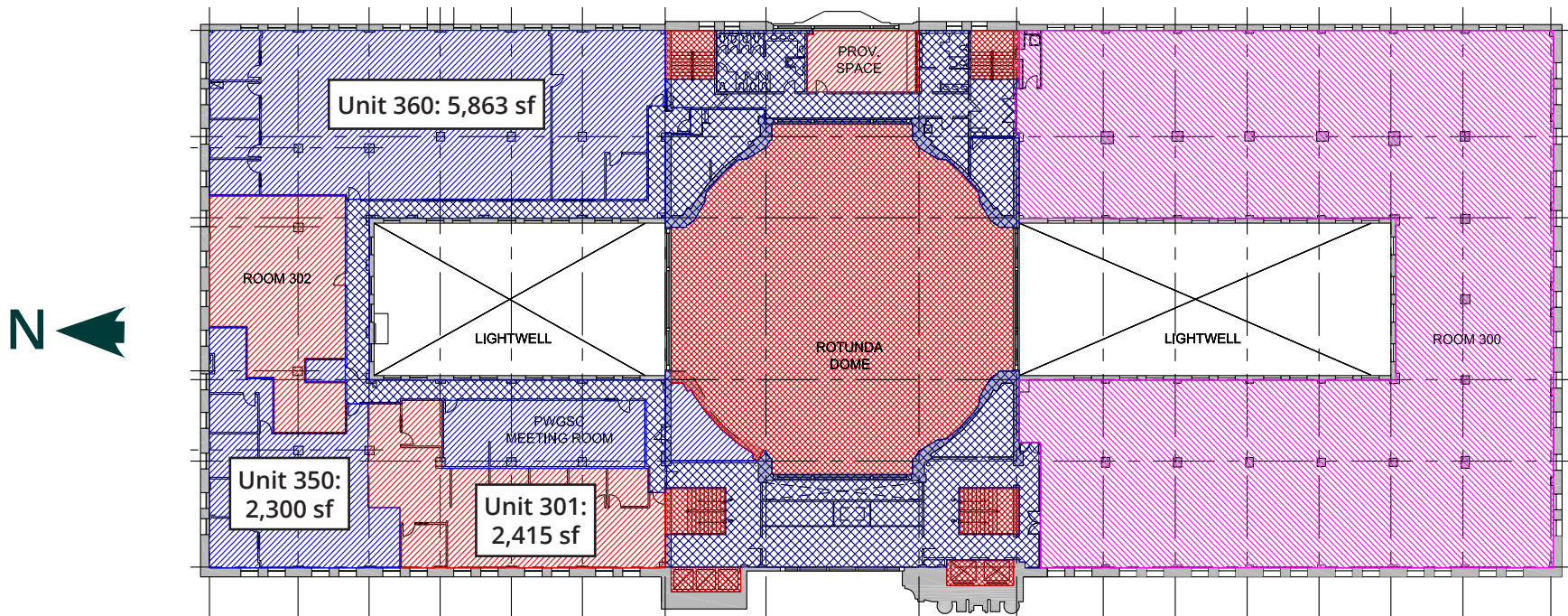

Conference room: 1,033 sf can be combined with any other unit

Wes Schollenberg

Managing Director, Broker
204.560.1501
wes.schollenberg@avisonyoung.com

Linda Capar

Vice President
204.560.1503
linda.capar@avisonyoung.com

Paul Douglas

Senior Associate
204.560.1504
paul.douglas@avisonyoung.com

Steven Luk Pat

Associate
204.560.1512
steven.lukpat@avisonyoung.com

**AVISON
YOUNG**

avisonyoung.com

© 2024 Avison Young Commercial Real Estate (MB) Inc.

All rights reserved. E. & O.E.: The information contained herein was obtained from sources which we deem reliable and, while thought to be correct, is not guaranteed by Avison Young Commercial Real Estate Services, LP.

UNION STATION

123 MAIN STREET, WINNIPEG

4th Floor

- Unit 400: 16,843 sf – entire south wing
- Unit 420: 14,972 sf – entire north wing
- Entire 4th floor: 31,815 sf

Contiguous: **45,380 sf** (half of 3rd & entire 4th floor)
Largest contiguous: **77,591 sf** (half of 2nd, entire 3rd & 4th Floor)

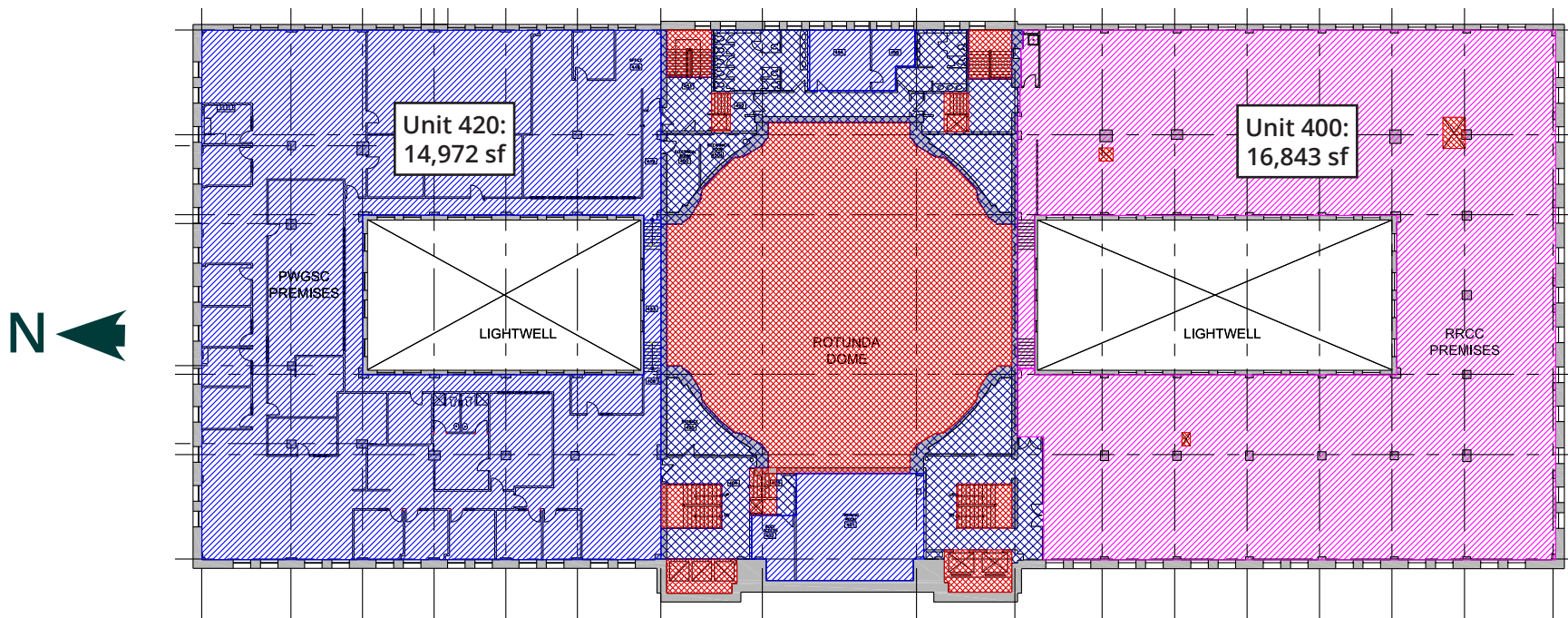

Wes Schollenberg

Managing Director, Broker
204.560.1501
wes.schollenberg@avisonyoung.com

Linda Capar

Vice President
204.560.1503
linda.capar@avisonyoung.com

Paul Douglas

Senior Associate
204.560.1504
paul.douglas@avisonyoung.com

Steven Luk Pat

Associate
204.560.1512
steven.lukpat@avisonyoung.com

**AVISON
YOUNG**

avisonyoung.com

© 2024 Avison Young Commercial Real Estate (MB) Inc.
All rights reserved. E. & O.E.: The information contained herein was obtained from sources which we deem reliable and, while thought to be correct, is not guaranteed by Avison Young Commercial Real Estate Services, LP.

UNION STATION

123 MAIN STREET, WINNIPEG

Lower Level

- Unit 0037: 2,716 sf

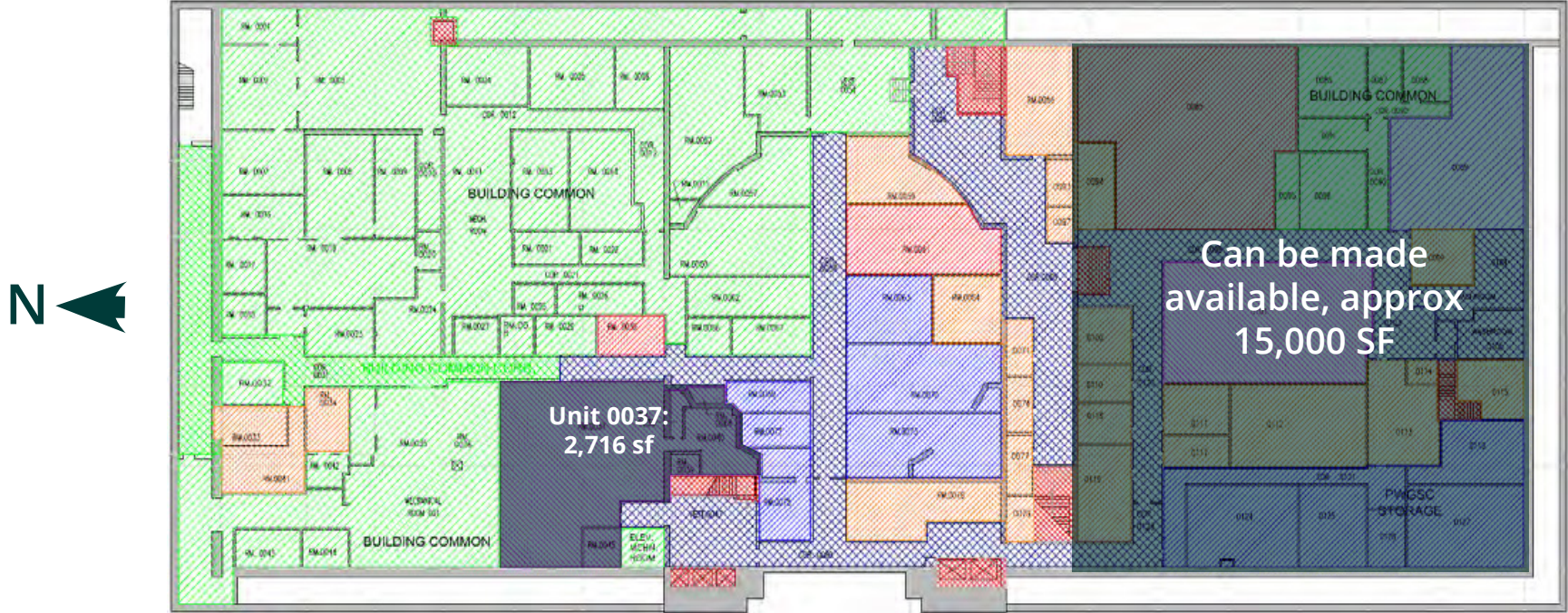

Wes Schollenberg

Managing Director, Broker
204.560.1501

wes.schollenberg@avisonyoung.com

Linda Capar

Vice President
204.560.1503

linda.capar@avisonyoung.com

Paul Douglas

Senior Associate
204.560.1504

paul.douglas@avisonyoung.com

Steven Luk Pat

Associate
204.560.1512

steven.lukpat@avisonyoung.com

**AVISON
YOUNG**

avisonyoung.com

© 2024 Avison Young Commercial Real Estate (MB) Inc.

All rights reserved. E. & O.E.: The information contained herein was obtained from sources which we deem reliable and, while thought to be correct, is not guaranteed by Avison Young Commercial Real Estate Services, LP.