

FOR SALE

4277 DAWSON STREET, BURNABY, B.C.

NEW-BUILD RETAIL UNIT IN MIXED-
USE DEVELOPMENT STEPS AWAY
FROM GILMORE SKYTRAIN STATION

- ▶ LAST REMAINING UNIT RELEASED BY DEVELOPER
- ▶ RELEASED 2,442 SF RETAIL UNIT
- ▶ EXCLUSIVE PARKING STALLS

Developed by:
IMANI

**A
KIM
BO**

Gilmore Place

T Gilmore
Skytrain Station

DAWSON ST

MADISON AVE

Jack Allpress
Personal Real Estate Corporation
Senior Managing Director Investments
(604) 638-1975
JAllpress@MarcusMillichap.com

David Morris
Personal Real Estate Corporation
Senior Managing Director Investments
(604) 638-2123
David.Morris@marcusmillichap.com

Marcus & Millichap

FOR SALE

4277 DAWSON STREET, BURNABY, B.C.



OPPORTUNITY

Akimbo is an exciting and rarely available opportunity to acquire and own strata retail and office space within the rapidly evolving Brentwood Town Centre of Burnaby. With the retail portion being completely sold out, this is the last chance for businesses and investors the chance to own their real estate within one of Metro Vancouver's most desirable and complete neighbourhoods.

SALIENT DETAILS

Municipal Address: [4277 Dawson Street, Burnaby, B.C.](#)

Zoning: CD Comprehensive Development

Availability: 2,442 SF

Parking: Please Contact Leasing Agents

Possession: Immediate

Asking Price: Please Contact Listing Agents



HIGHLIGHTS

The chance to own in a tightly held commercial real estate market with little to no strata space available.

Small and large format space available for both retail and office requirements.

In close proximity to two SkyTrain Stations: Gilmore Station (3 minute walking distance) & Brentwood Town Centre Station (8 minute walking distance).

Neighbour to massive mixed use projects such as Amazing Brentwood, Solo District, and Gilmore Place.

Amenity rich area:

- Whole Foods, Shoppers Drug Mart, BC Liquor - one block away.
- Save-On-Foods, Winners - one block away.
- Cactus Club, Joey, Browns - one block away.
- Steve Nash Fitness - two blocks away.
- Amazing Brentwood - One million square feet of high-end retail and entertainment.
- Gilmore Place - 450,000 square feet of transit-oriented retail space.

Thousands of residential condos have either been recently completed or are under construction with many more towers to come.

Between 2014-2019, the Brentwood Town Centre area saw a 10% increase in population.

1.5 km away from the British Columbia Institute of Technology and Burnaby General Hospital.

FOR SALE

4277 DAWSON STREET, BURNABY, B.C.

GROUND FLOOR RETAIL SITE PLAN

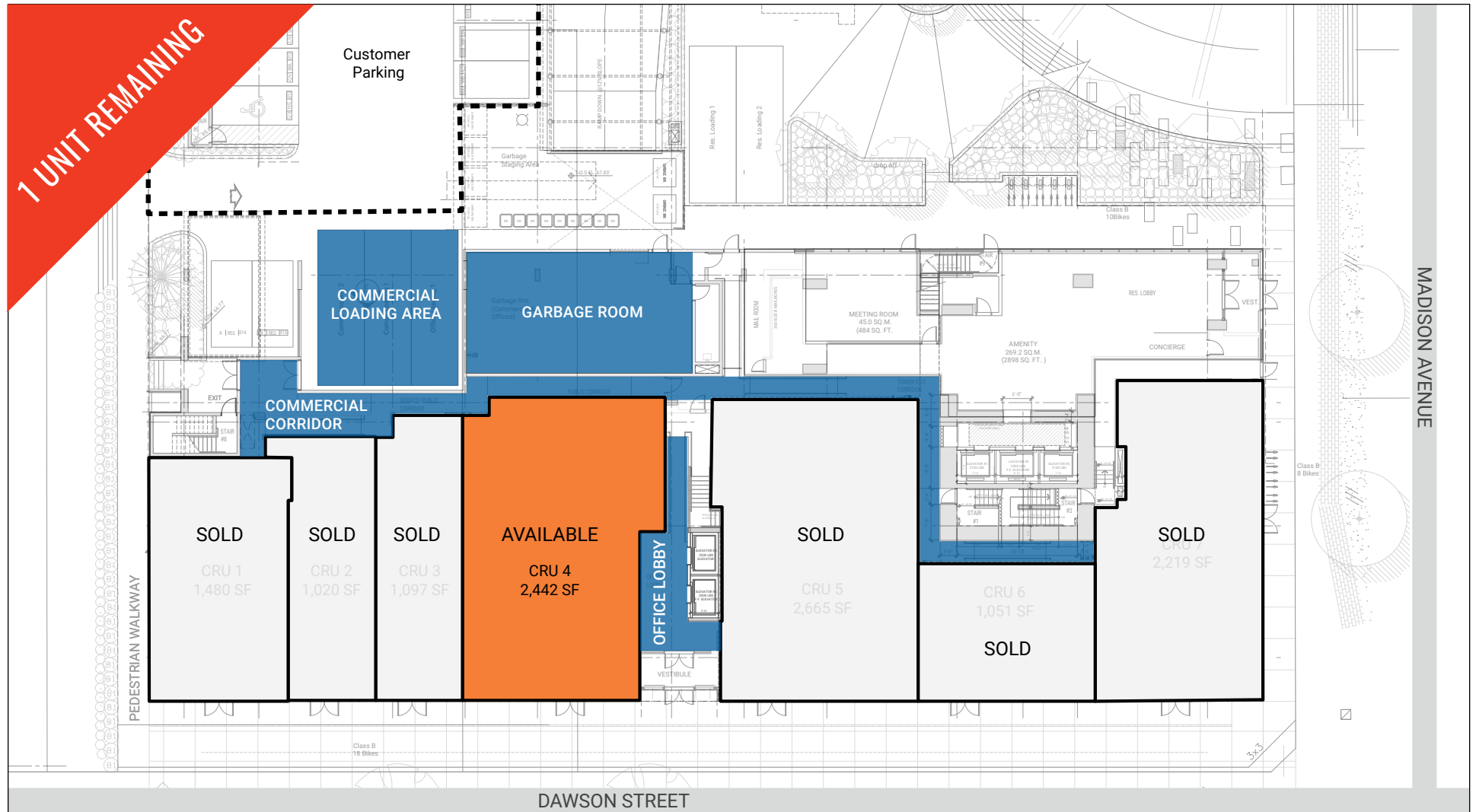

FOR SALE

4277 DAWSON STREET, BURNABY, B.C.

PROPERTY AMENITIES & FEATURURES



End-of-trip facilities:
Shower, change rooms, and bicycle lockers



Concrete construction and floor to ceiling glazing for
retail and office



Easy access to parking and transportation



High-speed elevators



Mixed-Use building with office and residential tenants



Visitor parking on-site



Efficient floor plates



Immediate area cafes and restaurant



Adjacent to major bike routes



Two minute drive to Highway 1



FOR SALE

4277 DAWSON STREET, BURNABY, B.C.



SURROUNDING DEVELOPMENTS

1	Subject Property - AKIMBO	350 Units
2	Aveira Condos by Ledingham McAllister	239 Units
3	Escala by Ledingham McAllister	520 Units
4	Triomphe by Millenium Development Group	340 Units
5	Gilmore Place by Onni Group of Companies	1,563 Units
6	Vantage by Embassy Development Corporation	185 Units
7	Madison & Dawson by Porte Communities	92 Units
8	Fulton House by Polygon Homes	303 Units

9	Motif at Citi by Appia Development	153 Units
10	SOLO District by Appia Development	280 Units
11	The Amazing Brentwood	600 Units
12	The Dawson by Amacon	62 Units
13	Juneau by Amacon	147 Units
14	South Yards by Anthem	1,450 Units
15	Lumina Brentwood by THIND	962 Units
16	Concord Brentwood by Concord Pacific	1,792 Units
17	Slate by Beedie	313 Units

FOR SALE

4277 DAWSON STREET, BURNABY, B.C.



<p>WALK SCORE VERY WALKABLE</p> <p>86*</p>	<p>BIKE SCORE BIKEABLE</p> <p>67*</p>	<p>TRANSIT SCORE EXCELLENT TRANSIT</p> <p>79*</p>
--	---	---

*For more information on scores and methodology visit <https://www.walkscore.com/methodology>

Demographics	1 KM	3 KM	5 KM	Burnaby
Population	13,583	111,774	308,204	265,924
Households	6,236	40,818	119,057	100,146
Average Household Income	\$100,571	\$105,564	\$97,133	\$99,600
Population Growth (2022-2027)	22.10%	7.10%	6.90%	8.10%



Gilmore Place

T
Gilmore
Skytrain Station

Marcus & Millichap

Marcus & Millichap
1100 - 1111 West Georgia Street
Vancouver, BC V6E 4M3

T (604) 638-2121
F (604) 638-2122

The information contained in this Marketing Brochure is proprietary and strictly confidential. It is intended to be reviewed only by the party receiving it from Marcus & Millichap and should not be made available to any other person or entity without the written consent of Marcus & Millichap. This Marketing Brochure has been prepared to provide summary, unverified information to prospective purchasers, and to establish only a preliminary level of interest in the subject property. The information contained herein is not a substitute for a thorough due diligence investigation. Marcus & Millichap has not made any investigation, and makes no warranty or representation, with respect to the income or expenses for the subject property, the future projected financial performance of the property, the size and square footage of the property and improvements, the presence or absence of contaminating substances, PCB's or asbestos, the compliance with State and Federal regulations, the physical condition of the improvements thereon, or the financial condition or business prospects of any tenant, or any tenant's plans or intentions to continue its occupancy of the subject property. The information contained in this Marketing Brochure has been obtained from sources we believe to be reliable; however, Marcus & Millichap has not verified, and will not verify, any of the information contained herein, nor has Marcus & Millichap conducted any investigation regarding these matters and makes no warranty or representation whatsoever regarding the accuracy or completeness of the information provided. All potential buyers must take appropriate measures to verify all of the information set forth herein.

Marcus & Millichap is not affiliated with, sponsored by, or endorsed by any commercial tenant or lessee identified in this marketing package. The presence of any corporation's logo or name is not intended to indicate or imply affiliation with, or sponsorship or endorsement by, said corporation of Marcus & Millichap, its affiliates or subsidiaries, or any agent, product, service, or commercial listing of Marcus & Millichap, and is solely included for the purpose of providing tenant lessee information about this listing to prospective customers.

This information has been secured from sources we believe to be reliable, but we make no representations or warranties, express or implied, as to the accuracy of the information. References to square footage or age are approximate. Buyer must verify the information and bears all risk for any inaccuracies. Marcus & Millichap is a trademark of Marcus & Millichap Real Estate Investment Services, Inc. Used under license by Marcus & Millichap Real Estate Investment Services Canada Inc. © 2025 Marcus & Millichap. All rights reserved.