

#301 - 938 HOWE STREET, VANCOUVER
OWNER-OCCUPIER OPPORTUNITY AT PACIFIC PLACE

**FOR
SALE**

BEST VALUE IN PACIFIC PLACE



WILLIAM | WRIGHT

MEG COONEY
meg@williamwright.ca
604.428.5255

RODERICK MACKAY
roderick@williamwright.ca
604.428.5255



PACIFIC PLACE

Office Opportunity

Owner-occupier opportunity! Unit #301 at Pacific Place offers a turn-key office space in an unbeatable downtown location—just steps from Robson Street, Pacific Centre, and the Vancouver Courthouse District. Enjoy the convenience of Waves Coffee at street level and an exceptional selection of nearby dining options, including Earls Test Kitchen, Zubu Ramen, Pacifico Pizzeria, and more.

This bright corner unit features abundant natural light, two private glass-enclosed offices, and high-quality laminate flooring throughout, creating a professional and inviting work environment.

Pacific Place Features



Located in the heart of Downtown Vancouver



Bright Welcoming Lobby



Transit Friendly



Steps from Vancouver Courthouse District, Pacific Centre, and Robson Street

UNIT 301: Bright corner unit featuring an abundance of natural light, two private glass-enclosed offices

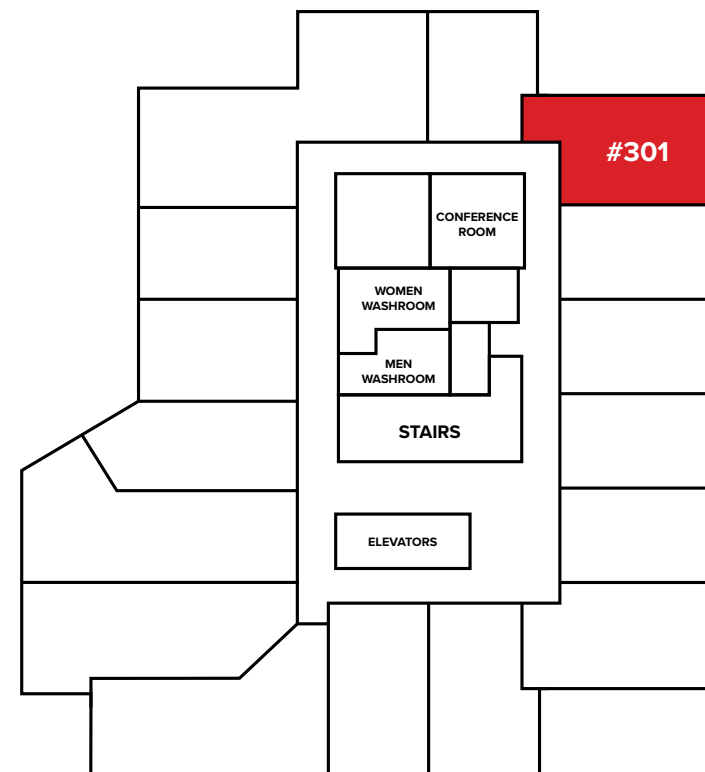

Salient Facts

UNIT	SIZE	PRICE	ZONING	PID	STRATA FEES	PROPERTY TAXES
301	± 301 SF	\$316,050	DD	023-100-028	\$278.64/month	\$3,797.24/yr

TENANCY DETAILS: Landlord's right to terminate with 3 months notice.

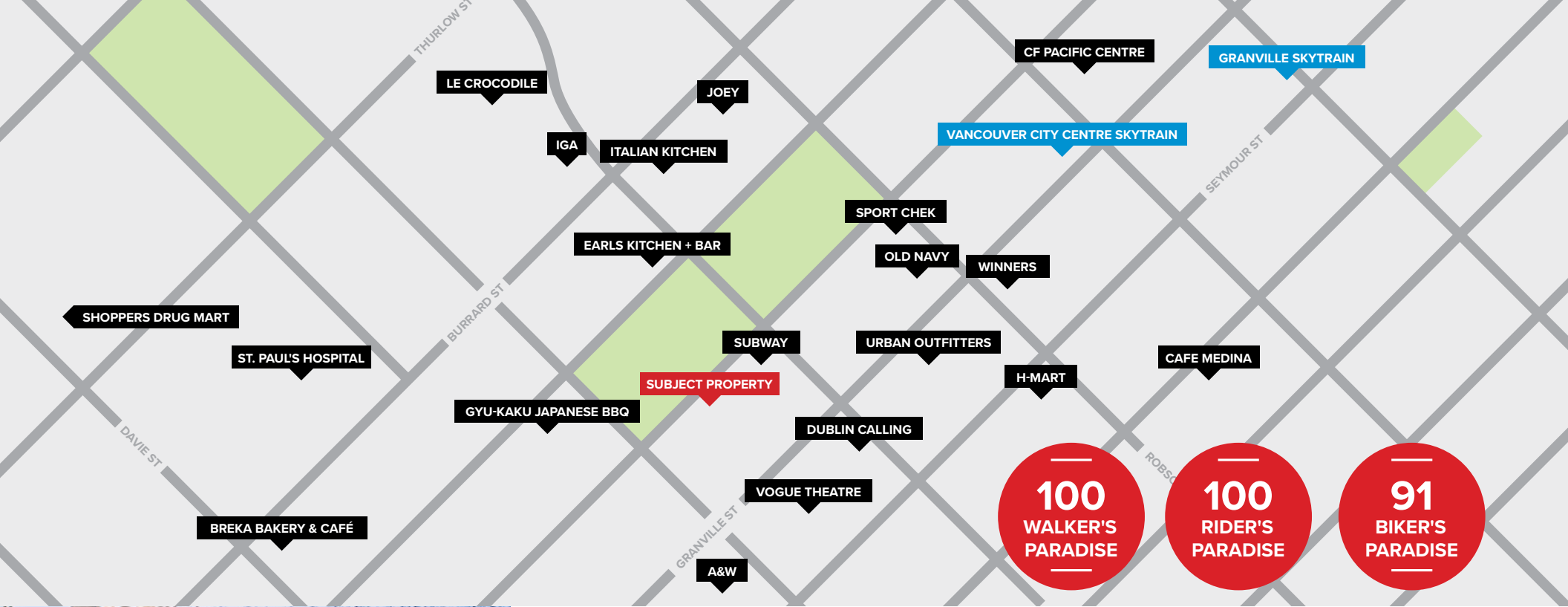

Location

This office is centrally located in the heart of downtown Vancouver; within walking distance of the business district, Granville entertainment district and Robson street's retail and restaurant experience. Located between the Burrard street bridge and the Granville street bridge, this office location is convient for both clients and owner's alike.

For More Information Contact

MEG COONEY
 meg@williamwright.ca
 604.428.5255

RODERICK MACKAY
 roderick@williamwright.ca
 604.428.5255