



# Industrial Distribution Space

## High Quality Improvements in Place

### SPACE OVERVIEW

- » Functional Industrial Bay located in Building 1 at the highly sought-after Canal108 development in SE Calgary
- » Modern warehouse construction with 32' clear ceiling height, ideal for racking, storage, or light industrial uses
- » Dock and/or grade loading configuration (efficient loading for last-mile, distribution, or service users)
- » ESFR sprinkler system (K-16.8) designed for high-pile storage and flexible racking layouts
- » LED high-bay lighting with motion sensors providing excellent warehouse illumination
- » Heavy-duty concrete slab (7" slab with estimated 850 lbs PSF load capacity)
- » Gas-fired unit heaters throughout the warehouse area
- » Clerestory windows providing natural light at the rear of the bay
- » Access to shared truck court with 129' depth and continuous concrete dolly pad
- » Fenced compound yard - 3,000 SF - double gated with drive-through capability. Can be used as 4 trailer stalls or fenced yard
- » **Racking and furniture negotiable**

### LEASE DETAILS

<b>TOTAL AREA</b>	<b>±10,547 SF</b>
<b>OFFICE AREA</b>	±3,000 SF
<b>WAREHOUSE AREA</b>	±7,547 SF
<b>SUBLEASE RATE</b>	Starting at \$16.48 PSF
<b>OP COST</b>	\$5.93 PSF (2026)
<b>SUBLEASE TERM</b>	until October 30, 2031
<b>ZONING</b>	I-G (Industrial General)
<b>LOADING</b>	2 Dock doors (9'x10') 1 Drive-In Door (12' x 14')
<b>CEILING HEIGHT</b>	32' clear (TBV)
<b>POWER</b>	347/600 volt, 3 phase, 200 amp service
<b>PARKING</b>	13 Assigned stalls (0.8 stalls/1,000 SF)
<b>PALLET RACKING</b>	24' high - Negotiable
<b>YARD AREA</b>	3,000 SF (\$600/month)
<b>AVAILABLE</b>	Negotiable

June 2, 2026

For more information,  
please contact:



**Kaile Landry**  
+1 403 984 9806  
[klandry@naiadvent.com](mailto:klandry@naiadvent.com)



**Jennifer Myles**  
+1 403 975 2616  
[jmyles@naiadvent.com](mailto:jmyles@naiadvent.com)



**Brody Butchart**  
+1 403 389 7857  
[bbutchart@naiadvent.com](mailto:bbutchart@naiadvent.com)



**Jamie Coulter, SIOR**  
+1 403 835 1535  
[jcoulter@naiadvent.com](mailto:jcoulter@naiadvent.com)

**SITE PLAN**

**BUILDING 1**  
7350 110TH AVE SE

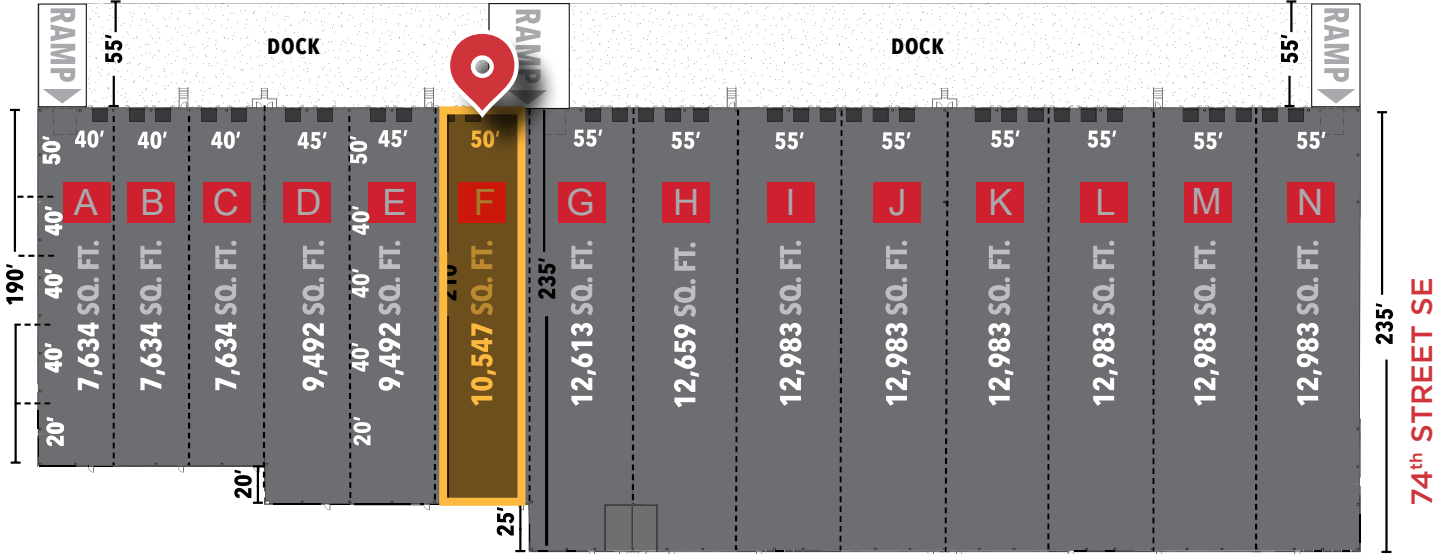

**RACK PLAN LAYOUT**

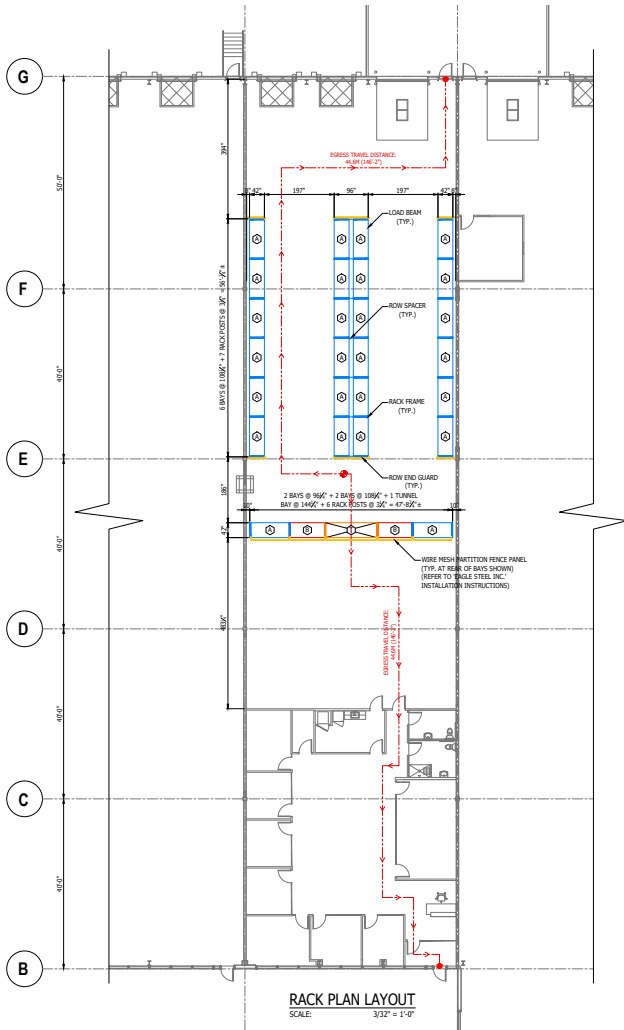

**OFFICE SPACE LAYOUT**

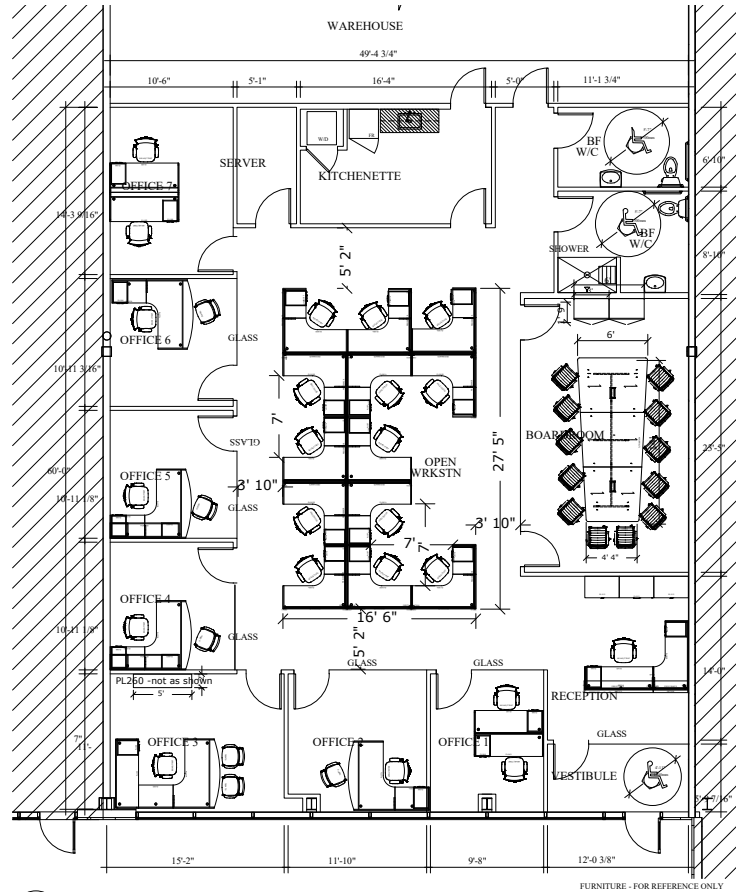

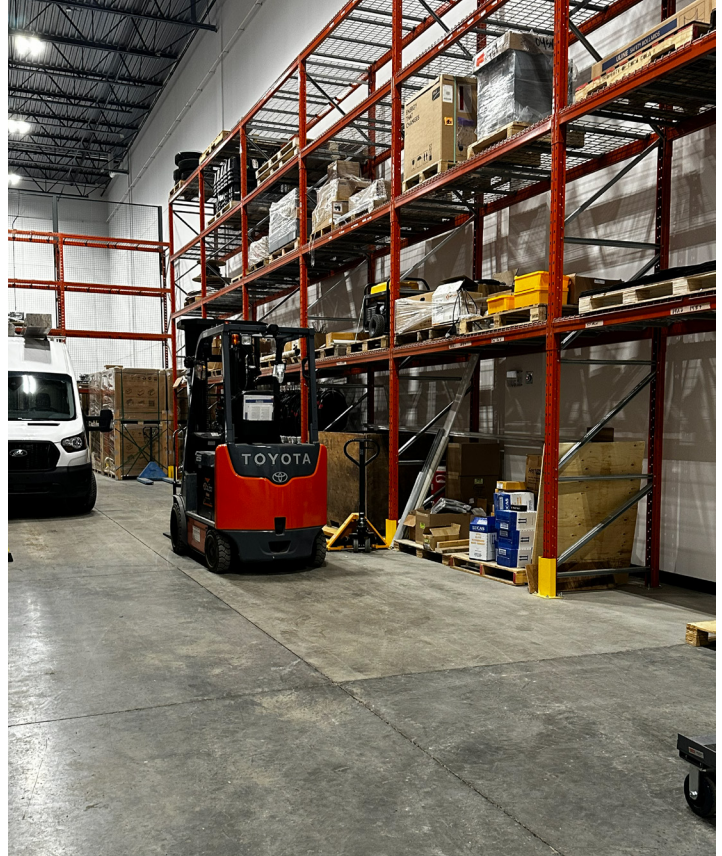



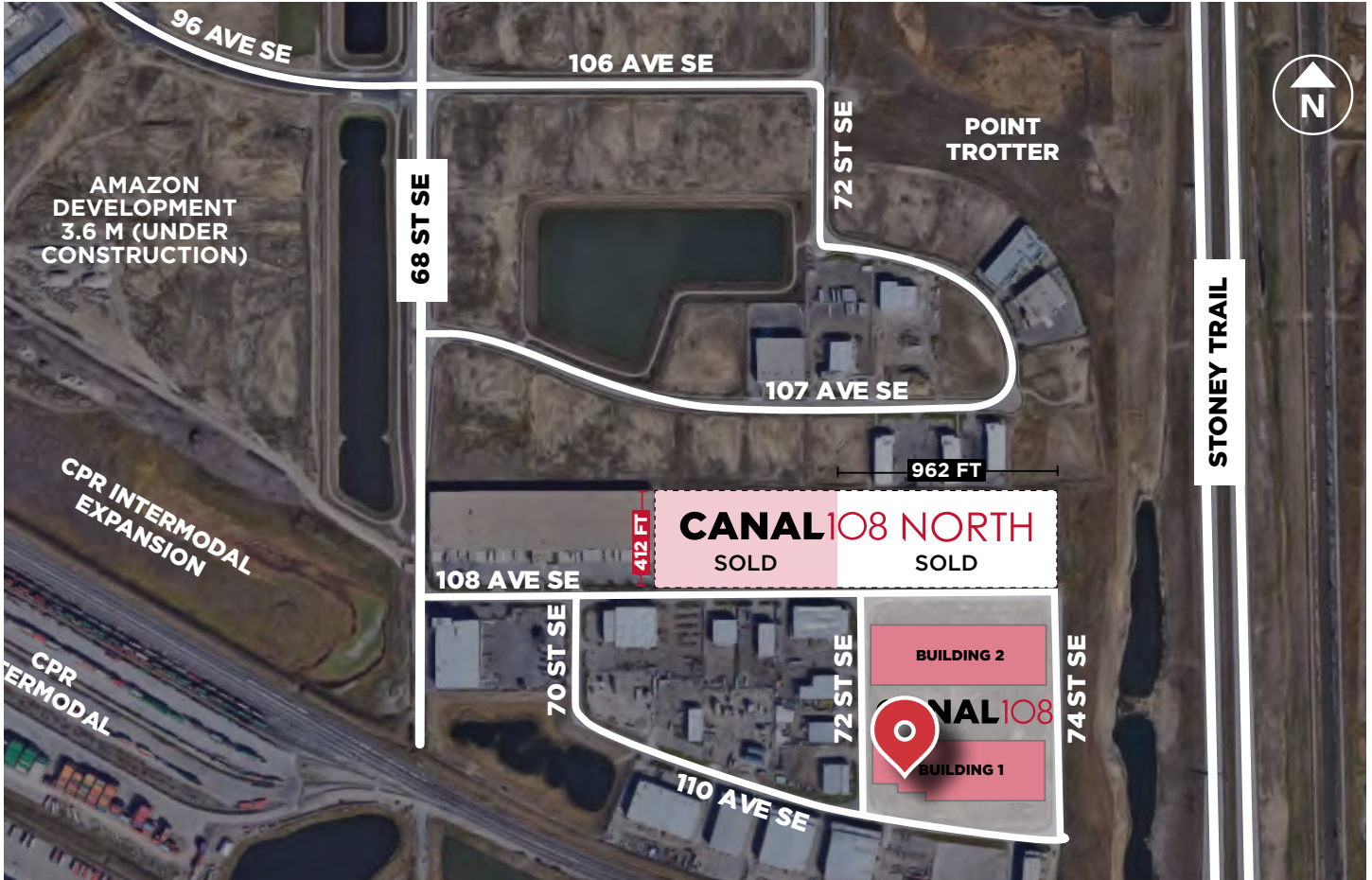

**AMENITIES**

- » Direct exposure and immediate access to Stoney Trail
- » Surrounded by major industrial users including logistics and distribution operations
- » Excellent connectivity via Glenmore Trail, 52nd Street SE, and 68th Street SE
- » Transit-accessible location with nearby bus routes: 149 (68th Street) and 23 & 150 (52nd Street)
- » Route 149 connects with Route 23 and 302 BRT
- » Numerous restaurants in area along 52nd Street
- » TELUS fibre to building
- » Part of a new-generation industrial park with strong tenant mix and professional curb appeal

THIS BROCHURE IS INTENDED FOR INFORMATION PURPOSES ONLY AND SHOULD NOT BE RELIED UPON FOR ACCURATE FACTUAL INFORMATION BY THE RECIPIENTS HEREOF. THE INFORMATION CONTAINED HEREIN IS BASED ON INFORMATION WHICH ADVENT COMMERCIAL REAL ESTATE CORP. OPERATING AS NAI ADVENT DEEMS RELIABLE, HOWEVER, ADVENT COMMERCIAL REAL ESTATE CORP. OPERATING AS NAI ADVENT ASSUMES NO RESPONSIBILITY FOR THE DEGREE OF ACCURACY OF SUCH INFORMATION, NOR DOES ADVENT COMMERCIAL REAL ESTATE CORP. OPERATING AS NAI ADVENT REPRESENT OR WARRANT THE INFORMATION CONTAINED HEREIN. RECIPIENTS HEREOF SHOULD CONDUCT THEIR OWN INVESTIGATIONS TO DETERMINE THE ACCURACY OF INFORMATION CONTAINED HEREIN. THE INFORMATION CONTAINED HEREIN IS SUBJECT TO CHANGE WITHOUT NOTICE. NAI ADVENT. ALL RIGHTS RESERVED. NO REPRODUCTION, DISTRIBUTION, OR TRANSMISSION OF THE COPYRIGHTED MATERIALS AT THIS SITE IS PERMITTED WITHOUT THE WRITTEN PERMISSION OF NAI ADVENT UNLESS OTHERWISE SPECIFIED. A LICENSED ASSOCIATE OF NAI ADVENT IS A PRINCIPAL OF THE OWNER OF THE PROPERTY.

For more information,  
please contact:



**Kaile Landry**  
+1 403 984 9806  
[klandry@naiadvent.com](mailto:klandry@naiadvent.com)



**Jennifer Myles**  
+1 403 975 2616  
[jmyles@naiadvent.com](mailto:jmyles@naiadvent.com)



**Brody Butchart**  
+1 403 389 7857  
[bbutchart@naiadvent.com](mailto:bbutchart@naiadvent.com)



**Jamie Coulter, SIOR**  
+1 403 835 1535  
[jcoulter@naiadvent.com](mailto:jcoulter@naiadvent.com)