

FOR SUBLEASE

# Canaccord Tower

## Portion of the 15th Floor - 609 Granville Street

Vancouver, BC

Premier view office space, furnished with modern improvements and flooded with natural light.

### SUITE FEATURES

- North east corner view premises
- Well improved with a boardroom, 2 offices, reception, kitchen and open area currently with 14 desks
- Elevator exposure

### BUILDING FEATURES

- Meeting & conference room facilities
- 24,000 sq.ft. CF terrace rooftop amenity
- Access to CF Fitness Centre
- Change rooms & shower facilities
- Bicycle storage
- 24-hour service center & security

### SALIENT DETAILS

RENTABLE AREA	2,096 sq.ft
AVAILABLE	Immediately
NET RENT	Please contact Listing Agents for details
ADDITIONAL RENT	\$28.66 per sq.ft (2025 Est.)
TERM EXPIRY	August 30, 2026
FURNITURE	Negotiable

### CONTACT

TARA FINNEGAN  
PERSONAL REAL ESTATE CORPORATION  
Senior Vice President | Office Properites  
604 662 5159  
tara.finnegan@cbre.com

ELLEN PINES  
Transaction Manager  
Office Properites  
604 704 9637  
ellen.pines@cbre.com







FOR SUBLEASE

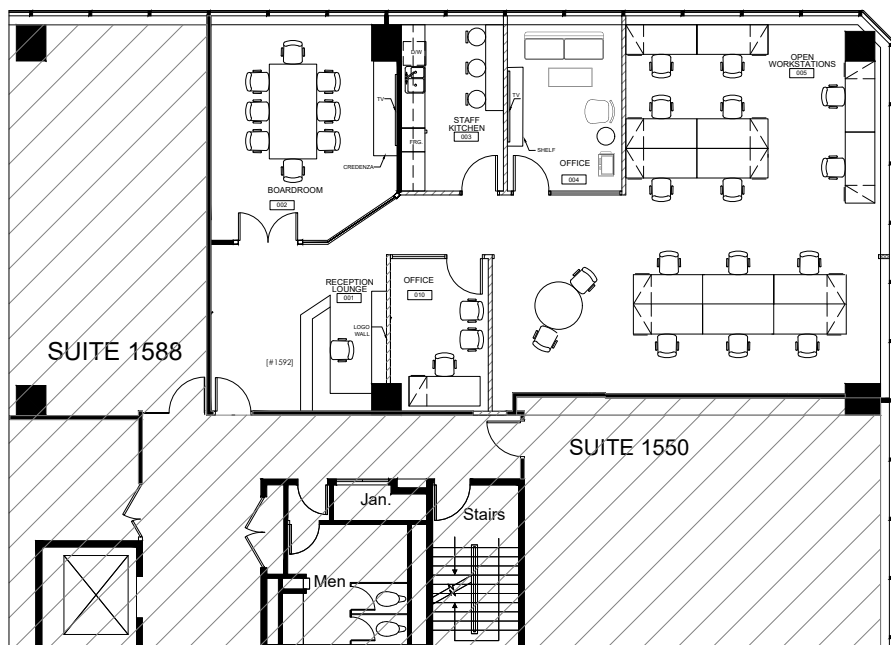

Not to scale - furniture not confirmed

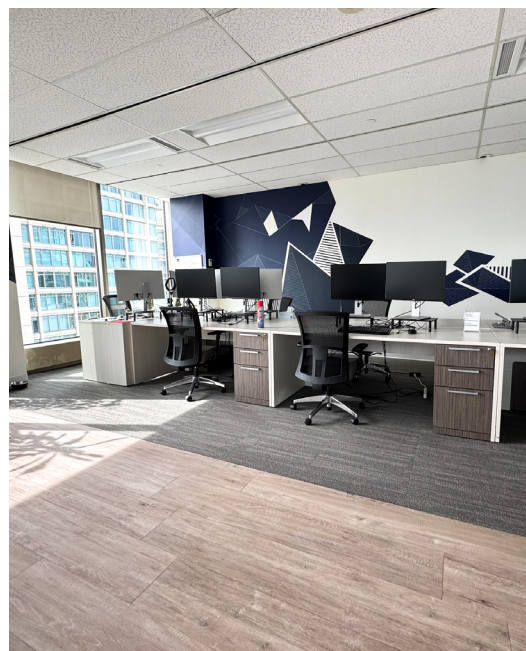

Central location in the  
Downtown core



Walking distance from  
Granville & Vancouver  
City Centre Stations



Bike and locker  
storage in the  
complex



Direct connection to  
Pacific Centre Mall &  
surrounding restaurants &  
shopping amenities

## ● FOR MORE INFORMATION PLEASE CONTACT

**TARA FINNEGAN**  
PERSONAL REAL ESTATE CORPORATION  
Senior Vice President | Office Properties  
604 662 5159  
tara.finnegan@cbre.com

**ELLEN PINES**  
Transaction Manager  
Office Properties  
604 704 9637  
ellen.pines@cbre.com

CBRE Limited | 1021 West Hastings Street Suite #2500, Vancouver, BC V6E 0C3

This disclaimer shall apply to CBRE Limited, Real Estate Brokerage, and to all other divisions of the Corporation; to include all employees and independent contractors ("CBRE"). All references to CBRE Limited herein shall be deemed to include CBRE, Inc. The information set out herein, including, without limitation, any projections, images, opinions, assumptions and estimates obtained from third parties (the "Information") has not been verified by CBRE, and CBRE does not represent, warrant or guarantee the accuracy, correctness and completeness of the Information. CBRE does not accept or assume any responsibility or liability, direct or consequential, for the Information or the recipient's reliance upon the Information. The recipient of the Information should take such steps as the recipient may deem necessary to verify the Information prior to placing any reliance upon the Information. The Information may change and any property described in the Information may be withdrawn from the market at any time without notice or obligation to the recipient from CBRE. CBRE and the CBRE logo are the service marks of CBRE Limited and/or its affiliated or related companies in other countries. All other marks displayed on this document are the property of their respective owners. All Rights Reserved.

Mapping Sources: Canadian Mapping Services [canadamapping@cbre.com](mailto:canadamapping@cbre.com); DMTI Spatial, Envrionics Analytics, Microsoft Bing, Google Earth.

**CBRE**