

NOTES:

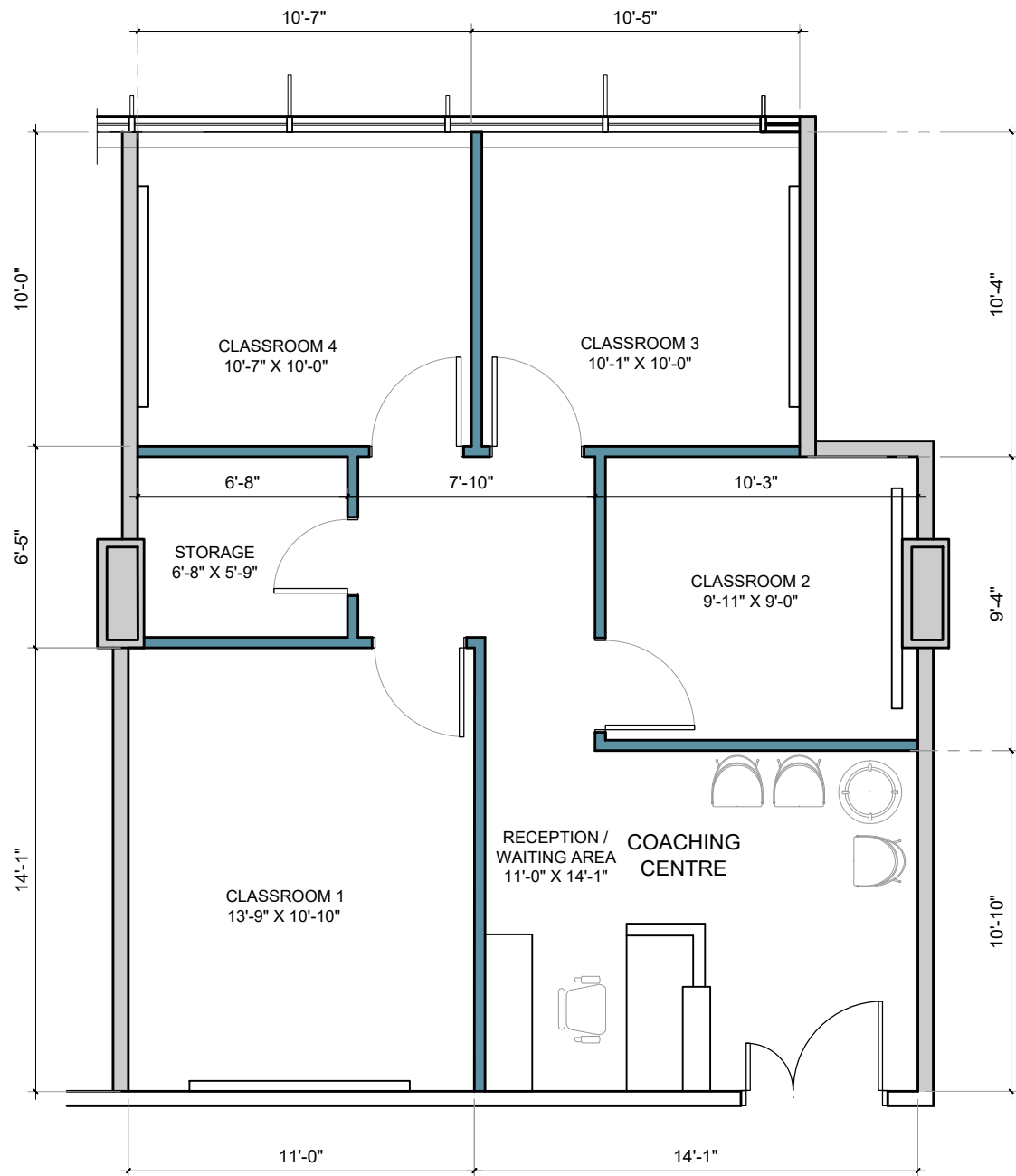

19-08-30	B	IFC
05-08-26	A	PRELIMINARY LAYOUT

df
ARCHITECTURE
inc.
1205-4871 SHELL ROAD,
RICHMOND, BRITISH COLUMBIA
CANADA V6X 3Z6
T (604)284-5194 F (604)284-5131
info@dfarchitecture.ca

PROJECT:
**PROPOSED IMMIGRATION OFFICE
UNIT # 407 and unit # 409
8318 120ST.
SURREY, BC**

CLIENT:
**AVTAR ARORA
12890 - 80TH AVENUE,
SURREY, BC.**

COPYRIGHT RESERVED. THIS PLAN AND
DESIGN ARE, AND AT ALL TIMES REMAIN THE
EXCLUSIVE PROPERTY OF DF ARCHITECTURE
INC. AND CANNOT BE USED OR REPRODUCED
WITHOUT THE ARCHITECT'S WRITTEN CONSENT.

DRAWN: MS	CHECKED: JA
SCALE: NTS	JOB No.: ID-001
DATE: 05 AUGUST 2019	

SHEET TITLE:

**COACHING CENTRE
WALL LAYOUT**

DRAWING NO.:	
A-202	B