

*For Lease*

# 1536 Brunswick Street

*Halifax, Nova Scotia*



**CBRE**

# The Opportunity

*Café/Retail*

Positioned at the vibrant corner of Brunswick and Doyle Street, **1536 Brunswick Street** presents a unique café and retail leasing opportunity in the heart of downtown Halifax. This space offers an inviting atmosphere well-suited to boutique food and beverage concepts or specialty retail operators seeking a distinctive urban presence.

Located adjacent to The Doyle—home to premium retailers such as Lululemon—and within walking distance of Citadel Hill, the property benefits from consistent foot traffic driven by both locals and visitors. The surrounding neighbourhood blends residential density, office users, and destination retail, creating a dynamic, all-day customer base.

The space itself offers a quaint yet highly functional layout, complemented by the potential for a seasonal patio, providing added visibility and customer appeal during the warmer months. This is a compelling opportunity to establish a presence in one of Halifax's most desirable and evolving downtown corridors.



### *Strong Foot Traffic*

Steps from Citadel Hill and central to a dense mix of residential, office, and tourist activity.



### *Prime Downtown Location*

Corner of Brunswick and Doyle Streets, surrounded by high-quality retailers, including Lululemon.



### *Charming Turnkey Space*

Quaint interior with character, ideal for café or retail concepts seeking a unique atmosphere.



### *Seasonal Patio Potential*

Opportunity to activate seasonal outdoor space in warmer months, further enhancing visibility



# Property Photos



# Floor Plan

1,000 sq. ft.

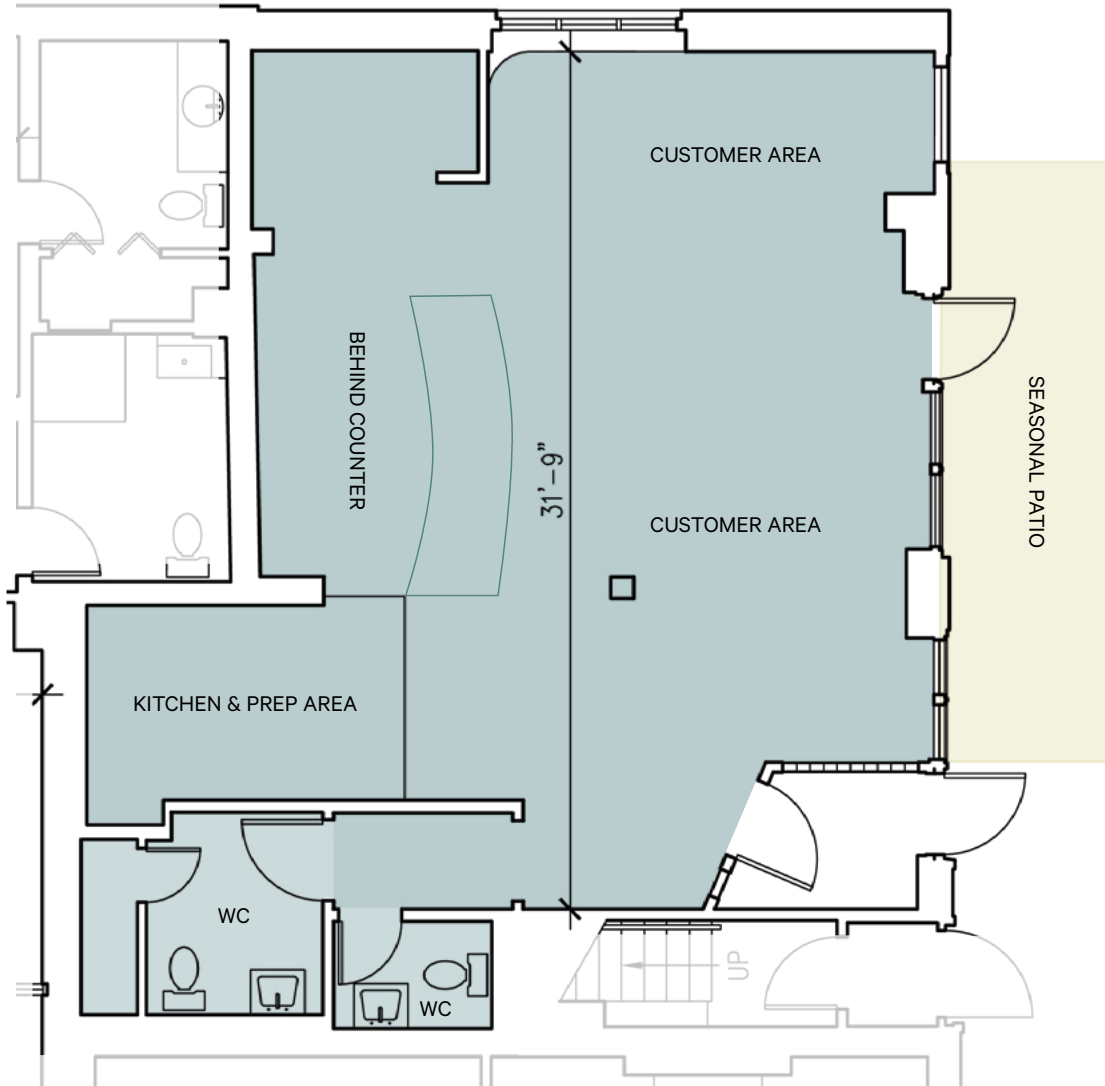

# Location Overview



**32.3 Yrs**

Median Age  
(StatsCan 2025)

**\$128M**

Annual Spend on Food  
(StatsCan 2025, 3km radius)

**\$103,543**

Average Household Income  
(StatsCan 2025)

**79,000+**

Population, 3km Radius  
(StatsCan 2025)

**23.3%**

Pop. Change, 3 km Radius  
(StatsCan 2020-2025)

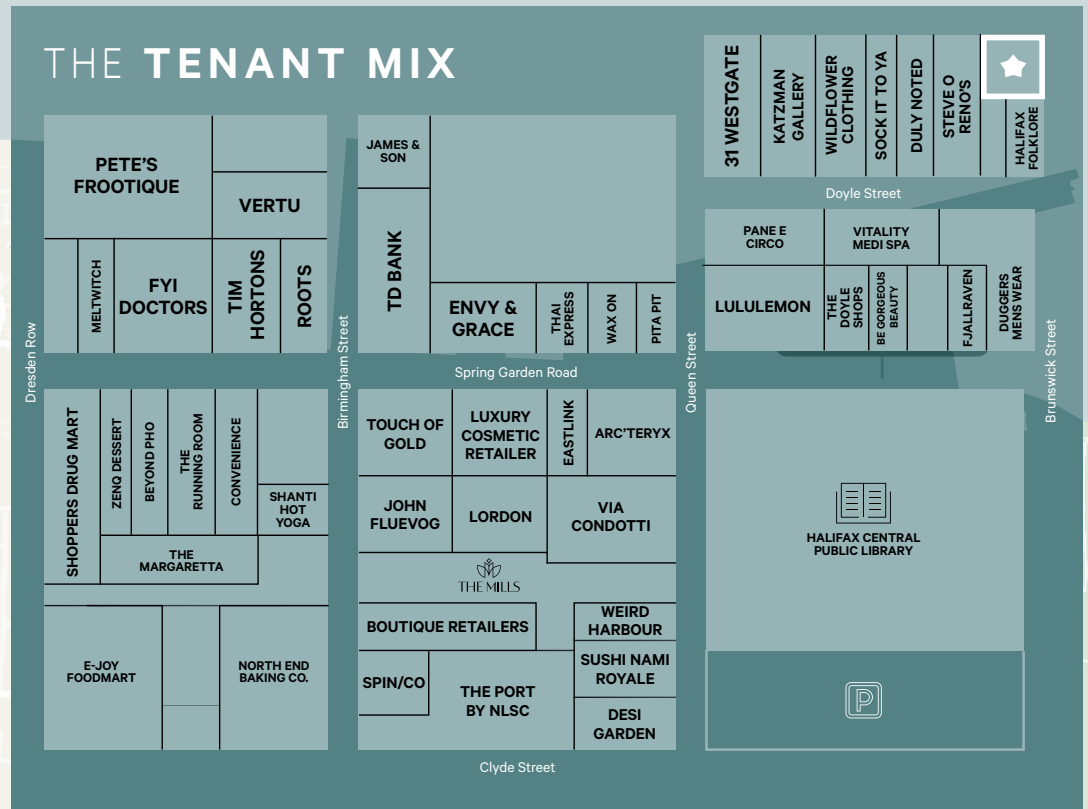

## For more information, please contact:

**Mat Houston**

Vice President

902 492 2074

mat.houston@cbre.com

**Breanna MacRury**

Sales Brokerage Associate

902 492 2082

breanna.macrury@cbre.com

This disclaimer shall apply to CBRE Limited, Real Estate Brokerage, and to all other divisions of the Corporation; to include all employees and independent contractors ("CBRE"). All references to CBRE Limited herein shall be deemed to include CBRE, Inc. The information set out herein, including, without limitation, any projections, images, opinions, assumptions and estimates obtained from third parties (the "Information") has not been verified by CBRE, and CBRE does not represent, warrant or guarantee the accuracy, correctness and completeness of the Information. CBRE does not accept or assume any responsibility or liability, direct or consequential, for the information or the recipient's reliance upon the Information. The recipient of the Information should take such steps as the recipient may deem necessary to verify the Information prior to placing any reliance upon the Information. The Information may change and any property described in the Information may be withdrawn from the market at any time without notice or obligation to the recipient from CBRE. CBRE and the CBRE logo are the service marks of CBRE Limited and/or its affiliated or related companies in other countries. All other marks displayed on this document are the property of their respective owners. All Rights Reserved.