

FOR SUBLEASE

CBRE



Suite 598

999 Canada Place

Vancouver, BC

PROPERTY OVERVIEW

Positioned within Vancouver's iconic Canada Place, this recently renovated furnished office features a polished, efficient layout with balcony access, offering seamless connectivity to transit, premier dining, and the city's vibrant waterfront business district.

Suite:	598
Size (Sq. Ft.): <i>(Approx rentable area)</i>	2,519 Sq. Ft.
Available:	Immediately
Sublease Expiry:	November 30, 2029
Basic Rent:	Contact Listing Agents
Additional Rent:	\$25.30 PSF (2026 est.)



SUITE FEATURES

- 3 Offices
- 6 Designated Workstations
- Meeting room
- Lounge Area
- Kitchenette
- Balcony



FLOOR PLAN

NOT TO SCALE

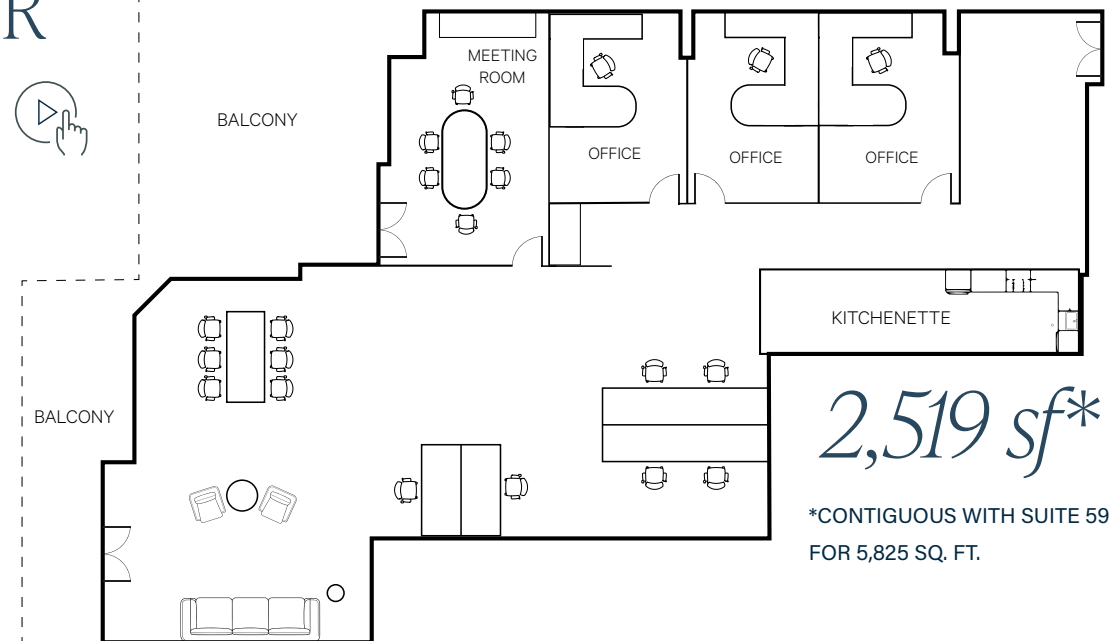

2,519 sf*

*CONTIGUOUS WITH SUITE 590 FOR 5,825 SQ. FT.

83



VERY BIKEABLE

97



WALKER'S PARADISE

100



EXCELLENT PARADISE

Source: Walkscore.com



Steps from WATERFRONT STATION

Connecting you to:

- Expo-Line
- SeaBus Terminal
- West Coast Express

CLOSE BY:



RETAIL

- Waterfront Station Retail Concourse
- CF Pacific Centre Mall
- Bentall Centre Retail
- Shoppers Drug Mart / Rexall Drugs



RESTAURANTS

- JOEY Bentall One
- Cactus Club Coal Harbour
- Tap and Barrel
- Starbucks Coffee



AMENITIES

- Coal Harbour Sea Wall
- Vancouver Convention Centre
- Fairmont Pacific Rim
- Club16 Trevor Linden Fitness



999 Canada Place

LISTING AGENT

Michael White

Vice President
 Advisory and Transaction Services
 604 662 5120
 michael.rm.white@cbre.com

This disclaimer shall apply to CBRE Limited, Real Estate Brokerage, and to all other divisions of the Corporation; to include all employees and independent contractors ("CBRE"). The information set out herein, including, without limitation, any projections, images, opinions, assumptions and estimates obtained from third parties (the "Information") has not been verified by CBRE, and CBRE does not represent, warrant or guarantee the accuracy, correctness and completeness of the Information. CBRE does not accept or assume any responsibility or liability, direct or consequential, for the Information or the recipient's reliance upon the Information. The recipient of the Information should take such steps as the recipient may deem necessary to verify the Information prior to placing any reliance upon the Information. The Information may change and any property described in the Information may be withdrawn from the market at any time without notice or obligation to the recipient from CBRE. CBRE and the CBRE logo are the service marks of CBRE Limited and/or its affiliated or related companies in other countries. All other marks displayed on this document are the property of their respective owners. All Rights Reserved. Mapping Sources: Canadian Mapping Services canadamapping@cbre.com; DMTI Spatial, Environics Analytics, Microsoft Bing, Google Earth. Properties and details may change or be withdrawn without notice. Some content may have been generated in whole or in part using generative AI (Artificial Intelligence).