

Updated: 2026

For Lease

Western Business Park

3495 Laird Road
Mississauga, ON



Unit 19

Total Square Feet
2,676 SF

Availability: March 1, 2026

Key features:

- 408 SF of office area
- 16'2" clear height
- 1 loading dock door
- Net Rent : \$20.50 PSF
- 2026 TMI: \$6.75 PSF

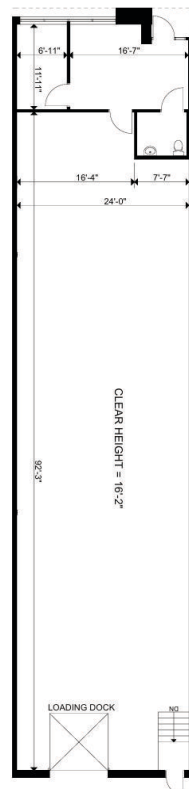

Dimpal Bulsara
Leasing Manager
Sales Representative
QuadReal Property Group, Brokerage

T 905 798 7426
E Dimpal.Bulsara@quadreal.com
W www.quadreal.com

