

SUITE 1900 TELUS SKY

Exceptional Workspace.

A fully fitted, design-forward floor on Calgary's downtown skyline - engineered around collaboration, focus, and the people who do their best work in beautiful spaces.

THE OPPORTUNITY

Suite 1900 | 16,278 SF
Full Floor or Shared Space
Flexible Sublease Term to 2031

CORE
COMMERCIAL
REAL ESTATE





The modern office is a strategic asset. It shapes culture, drives collaboration, and helps recruit and retain the people you want to keep. Suite 1900 is a rare opportunity to occupy a fully improved, design-forward floor inside TELUS Sky.

AT A GLANCE

Suite 1900 16,278 SF
Full floor or shared space opportunity

Furnished and wired - plug and play

Bistro kitchen and lounge areas designed for collaboration

Flexible term to November 2031

Exceptional workplaces help attract and retain exceptional people.

Thoughtfully curated lounge areas, informal collaboration zones, abundant natural light, and contemporary furnishings create an environment that is both highly productive and genuinely inviting - designed to attract, engage, and retain today's workforce.



One Floor. Multiple Occupancy Strategies.

Full-Floor Headquarters or Flexible Shared Space.

Flexible Term

Premium office space that adapts to the way your organization works today—and grows tomorrow.

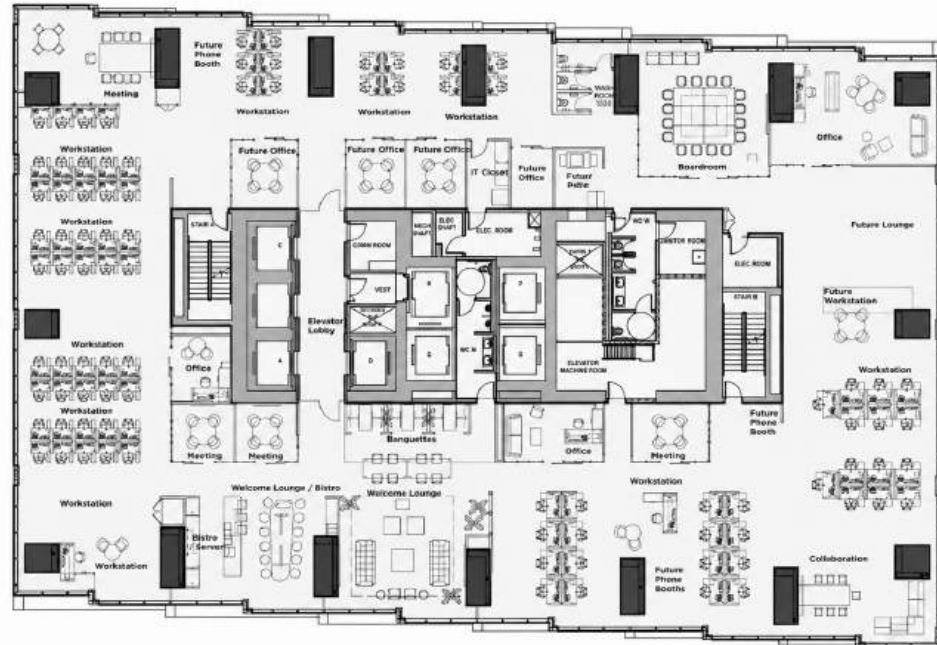

**Built for the way
teams actually work.**

From the executive boardroom to glass-walled meeting rooms, offices, and open area work zones, every space has been intentionally designed to support both formal collaboration and the quick, informal touchpoints that drive teams forward.



SUBLEASE TERMS

Sublandlord:	Bolster Built Inc.
Net Rent:	Market Sublease Rate
Op. Costs & Taxes:	\$26.52 / SF
Term Expiry:	Flexible until November 30, 2031
Possession:	30 – 60 Days
Parking:	3 Unreserved Stalls

THE BUILDING

Landlord:	TELUS Sky LP
Constructed:	2019
Office Floors:	28
HVAC:	M–F 7:30–18:00 Sat 8:00–15:00

BUILDING AMENITIES

Tenant fitness facility
Conference centre
Secure indoor bike storage with end-of-trip facilities
Plus15 connectivity
Direct C-train access

CONTACT

Lori King
Lori@COREcommercial.ca
403.618.8545

Jeff Thomson
Jeff@CORECommercial.ca
587.224.3550