

FOR LEASE WYE VILLAGE

967 ORDZE ROAD, SHERWOOD PARK, AB



Casey McClelland
Senior Managing Director
Casey.McClelland@MarcusMillichap.com

Kevin Glass
Director
Kevin.Glass@MarcusMillichap.com

Mike Hoffert
Director
Mike.Hoffert@MarcusMillichap.com

Marcus & Millichap

OVERVIEW / WYE VILLAGE

967 ORDZE ROAD, SHERWOOD PARK, AB

OPPORTUNITY

Presenting an opportunity to lease 1,137 SF CRU that is conveniently situated along Ordze Road and Wye Road (Sherwood Park Freeway), an essential arterial throughfare connecting Edmonton as well as Anthony Henday Drive to the area. Highlight your business alongside various local and national retailers such as Boston Pizza at this shopping centre. Outstanding exposure that reaches 32,021 vehicles per day and ample on-site surface parking will allow your business to succeed.



HIGHLIGHTS

- 1,137 SF available for lease
- Exposure to over 32,021 vehicles per day along Wye Road
- Wye Road connects to Edmonton and Anthony Henday Drive and is considered a major arterial throughfare
- Location achieves an impressive daily total of 29,653 daytime population
- 21,751 population within 3 km

DETAILS + SITE MAP / WYE VILLAGE

967 ORDZE ROAD, SHERWOOD PARK, AB

SALIENT DETAILS

Municipal Address:	967 Ordze Road, Sherwood Park
Legal Description:	Plan 1125MC; Lot 4
Unit Sizes:	1,137 SF
Availability:	Immediately
Zoning:	C2 - Arterial Commercial
Asking Rent:	Market
Additional Rent:	\$9.10/SF



SITE PLAN

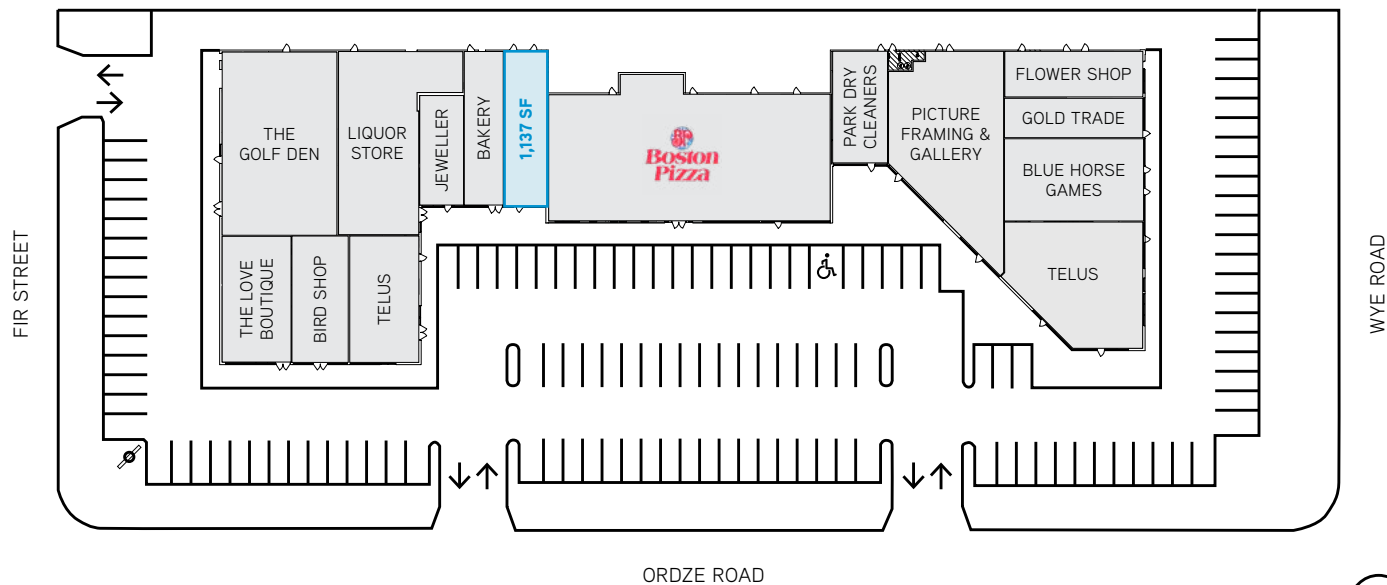

FLOOR PLAN / WYE VILLAGE

967 ORDZE ROAD, SHERWOOD PARK, AB

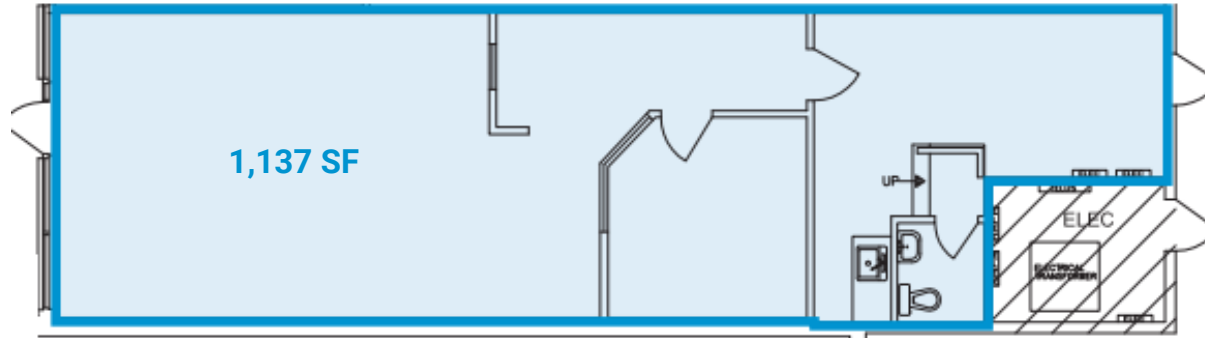

AREA + STATS / WYE VILLAGE

967 ORDZE ROAD, SHERWOOD PARK, AB



MAIN FLOOR

Commercial Retail Space



PARKING

Street Parking And Paid Lots



32,021

Vehicles Per Day



EXPOSURE

Ordze Road & Wye Road



TRANSIT

In Convenient Proximity



21,751

Population Within 3 KM



\$136,700

Household Income Average Within 3KM



2.5

Average Persons per Household



Prime positioning along Wye Road, a natural extension from Sherwood Park Freeway coming into Sherwood Park from Edmonton. Sherwood Park is recognized as an urban service area in Strathcona County and has become a community of choice for those wanting to live in a smaller community close to Edmonton. A growing population with high household income averages, it is an excellent choice to locate your new business.

Anthony Henday Drive	2 minutes
Baseline Road	5 minutes
Yellowhead Highway	7 minutes
Downtown Edmonton	20 minutes
Forst Saskatchewan	24 minutes



FOR LEASE WYE VILLAGE

Casey McClelland
Senior Managing Director
Casey.McClelland@MarcusMillichap.com

Kevin Glass
Director
Kevin.Glass@MarcusMillichap.com

Mike Hoffert
Director
Mike.Hoffert@MarcusMillichap.com

Marcus & Millichap

The information contained in the following Marketing Proposal is proprietary and strictly confidential. It is intended to be reviewed only by the party receiving it from Marcus & Millichap and should not be made available to any other person or entity without the written consent of Marcus & Millichap. This Marketing Proposal has been prepared to provide summary, unverified information to prospective sellers, and to establish only a preliminary level of interest in the subject property. The information contained herein is not a substitute for a thorough due diligence investigation. Marcus & Millichap has not made any investigation, and makes no warranty or representation, with respect to the income or expenses for the subject property, the future projected financial performance of the property, the size and square footage of the property and improvements, the presence or absence of contaminating substances, PCB's or asbestos, the compliance with State and Federal regulations, the physical condition of the improvements thereon, or the financial condition or business prospects of any tenant, or any tenant's plans or intentions to continue its occupancy of the subject property. The information contained in this Marketing Proposal has been obtained from sources we believe to be reliable; however, Marcus & Millichap has not verified, and will not verify, any of the information contained herein, nor has Marcus & Millichap conducted any investigation regarding these matters and makes no warranty or representation whatsoever regarding the accuracy or completeness of the information provided. All potential sellers must take appropriate measures to verify all of the information set forth herein.

Marcus & Millichap is not affiliated with, sponsored by, or endorsed by any commercial tenant or lessee identified in this marketing package. The presence of any corporation's logo or name is not intended to indicate or imply affiliation with, or sponsorship or endorsement by, said corporation of Marcus & Millichap, its affiliates or subsidiaries, or any agent, product, service, or commercial listing of Marcus & Millichap, and is solely included for the purpose of providing tenant lessee information about this listing to prospective customers.

This information has been secured from sources we believe to be reliable, but we make no representations or warranties, express or implied, as to the accuracy of the information. References to square footage or age are approximate. Buyer must verify the information and bears all risk for any inaccuracies. Marcus & Millichap is a trademark of Marcus & Millichap Real Estate Investment Services, Inc. Used under license by Marcus & Millichap Real Estate Investment Services Canada Inc. © 2026 Marcus & Millichap. All rights reserved.