



# INGLEWOOD SQUARE

UNIT 5 - 19 BELLEROSE DR, ST. ALBERT, AB

FOR SUBLEASE

**NICK FISHER**  
Personal Real Estate Corporation  
604.724.8892  
nick@sitings.ca

**SITINGS REALTY LTD.**  
SITINGS.CA / 604.684.6767  
1595 - 650 West Georgia Street, Vancouver, BC V6B 4N8

# PROJECT SUMMARY

Opportunity to sublease 15,252 SF of large-format retail space within the Inglewood Square in St. Albert, AB, a well-established neighbourhood retail centre anchored by Planet Fitness and shadow-anchored by Safeway, RBC and Dollarama.

Highlights include:

- ✚ St. Albert has an average household income of \$170,278, significantly higher than the Canadian average of \$128,578
- ✚ Ample on-site parking for customers and staff
- ✚ Flexible layout for a variety of retail and service-oriented uses
- ✚ Strong exposure with direct access off St. Albert Trail, one of St. Albert's busiest thoroughfares.



UNIT SIZE:  
15,252 SF

# AERIAL



This document/email has been prepared by Sitings Realty Ltd. for advertising and general information only. Although information contained herein is from sources we believe reliable, Sitings Realty Ltd. makes no guarantees, representations or warranties of any kind, expressed or implied, regarding the information including, but not limited to, warranties of content, accuracy and reliability. This document/email is subject to errors and omissions and any interested party should undertake their own inquiries as to the accuracy of the information. Sitings Realty Ltd. excludes unequivocally all inferred or implied terms, conditions and warranties arising out of this document and excludes all liability for loss and damages arising there from. All areas, measurements and dimension herein are approximate, interested parties/tenant are to verify measurements if important to them. This document/email is not an inducement representation.

# ZOOMED AERIAL



## DETAILS

✦ Size: 15,252 SF

✦ Commercial Parking: Ample storefront parking

✦ Base Rent: Contact Listing Agent

✦ Available: Immediately

✦ Additional Rent: Contact Listing Agent

✦ Sublease Term: June 30, 2033

## AREA TENANTS



## DEMOGRAPHICS

DRIVE TIME	3 MIN	5 MIN	10MIN
2025 Population	2,857	24,741	82,902
2030 Populations Projections	3,148	25,790	87,600
2025 Average HH Income	\$135,735	\$162,133	\$176,8067
2025 Daytime Population	2,857	24,741	82,902

## CONTACT

**NICK FISHER**

Personal Real Estate Corporation  
Sitings Realty Ltd

604.724.8892  
nick@sitings.ca

# SITE PLAN

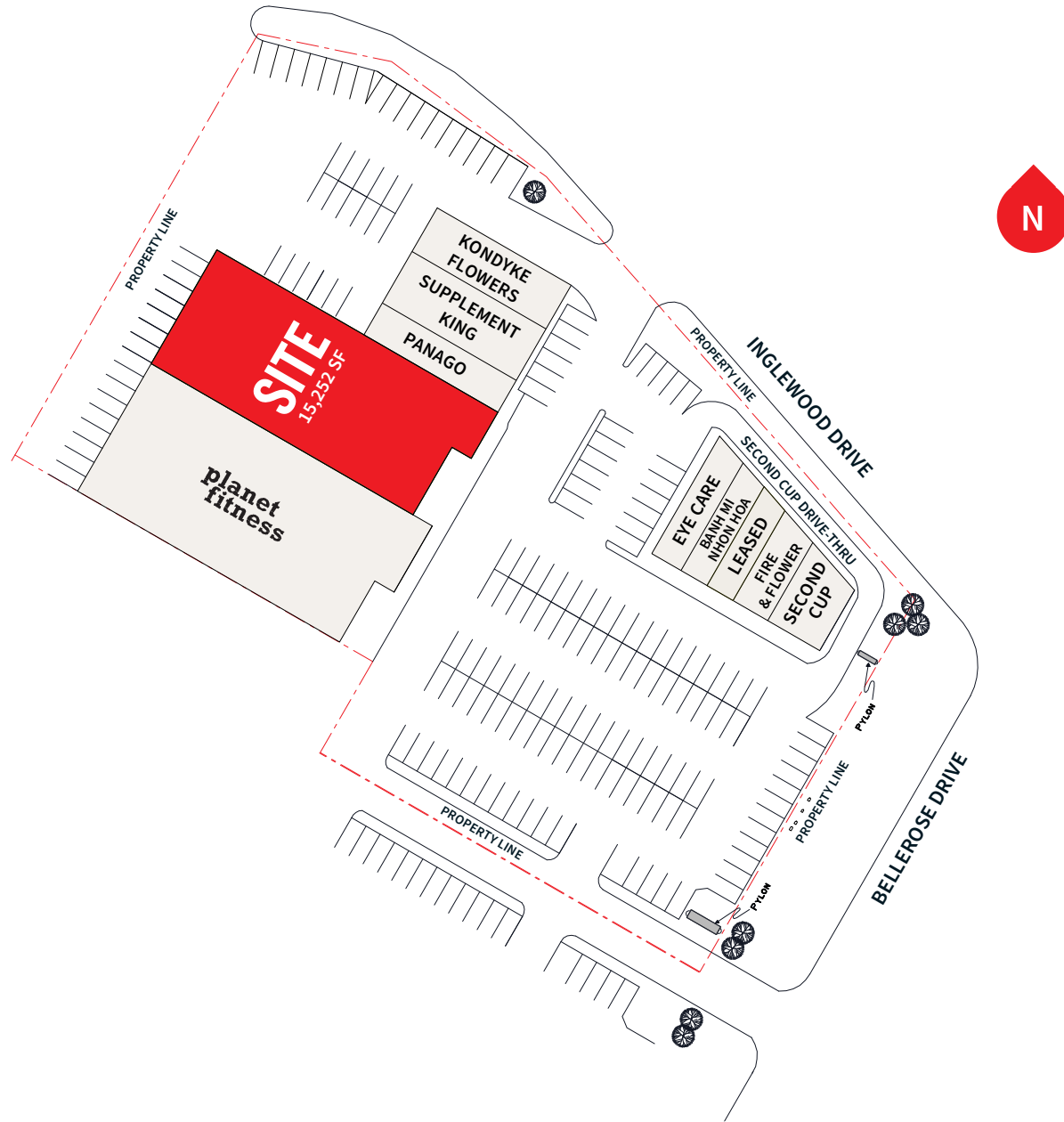

# EXTERIOR PHOTOS



# INTERIOR PHOTOS



# THE NEIGHBOURHOOD

St. Albert is a well-established and affluent municipality within the Edmonton Metropolitan Region, consistently recognized for strong household incomes, high population growth, and a stable economic base. The city features a predominantly residential demographic supported by well-developed retail, education, and civic infrastructure. Its proximity to Edmonton, access to major transportation corridors, and concentration of neighbourhood and regional shopping centres make St. Albert a proven market for retail, service, and commercial users seeking long-term stability and consistent consumer demand.

