

UNIT 7

19102 27th Avenue

SURREY, BC

TURN-KEY SMALL-BAY WAREHOUSE WITH OFFICE IN CAMPBELL HEIGHTS



For more information, contact:

Travis Blanleil

Personal Real Estate Corporation

Vice President

Industrial Properties Group

+1 604 662 5100

travis.blanleil@cbre.com

Vaibhav Seth

Sales Associate

Industrial Properties

+1 778 316 7513

vaibhav.seth@cbre.com

The Opportunity

CBRE is pleased to present the opportunity to lease Unit 7 at 19102 27 Avenue, Surrey, BC (the "Property"), comprising 2,071 SF of functional ground-floor flex industrial space. The unit features built-out and fully furnished office improvements, including two private offices, reception, kitchenette, and a washroom, complemented by a warehouse area with 22' clear height and energy-efficient LED lighting.

Offered as a turn-key, move-in-ready small-bay warehouse and office, the Property is ideally suited for a range of service and light industrial users. Strategically located in South Surrey's Campbell Heights industrial area, the Property provides excellent access to Highway 15, Highway 99, and the U.S. border, supporting efficient regional and cross-border connectivity.

NET RENT
\$19.95 PSF

ADDITIONAL RENT
\$8.66 PSF
(2026 EST.)

Features

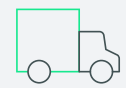

1 Grade Door
(12' x 14')



22' Clear
Ceiling Height



LED Lighting



HVAC in Office



120/240 V
200 A



2 Parking Stalls



Available
Immediately



IB-1 Zoning



Furnished &
Move-In Ready



UNIT EXTERIOR



RECEPTION

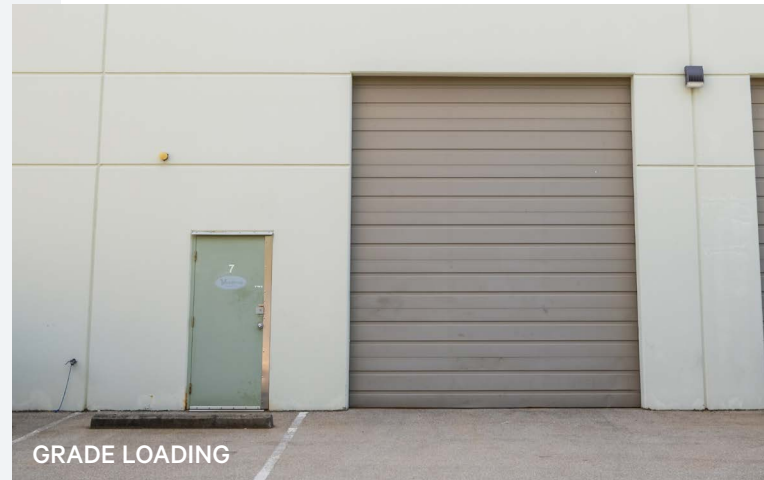

GRADE LOADING



PRIVATE OFFICES



WAREHOUSE

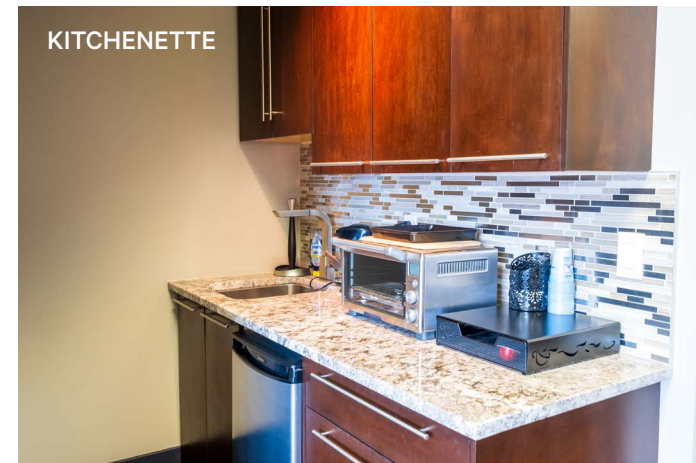

KITCHENETTE

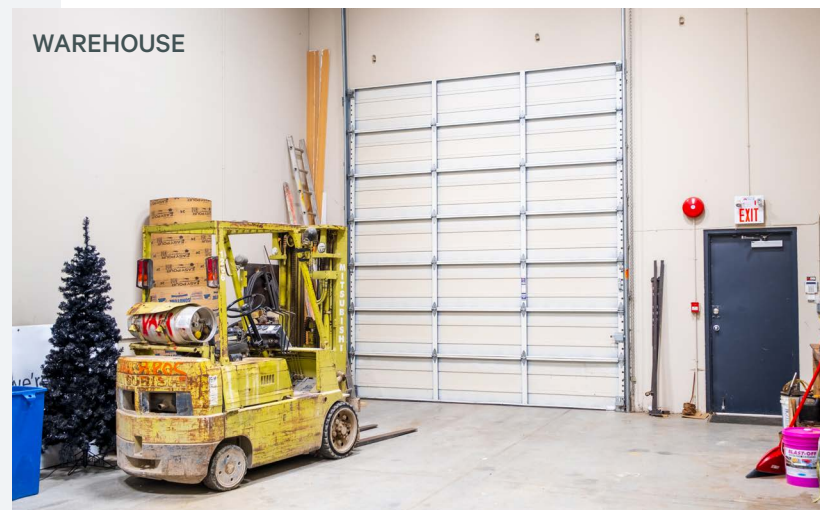

WAREHOUSE



BUSINESS COURT

Floor Plan

NOT TO SCALE

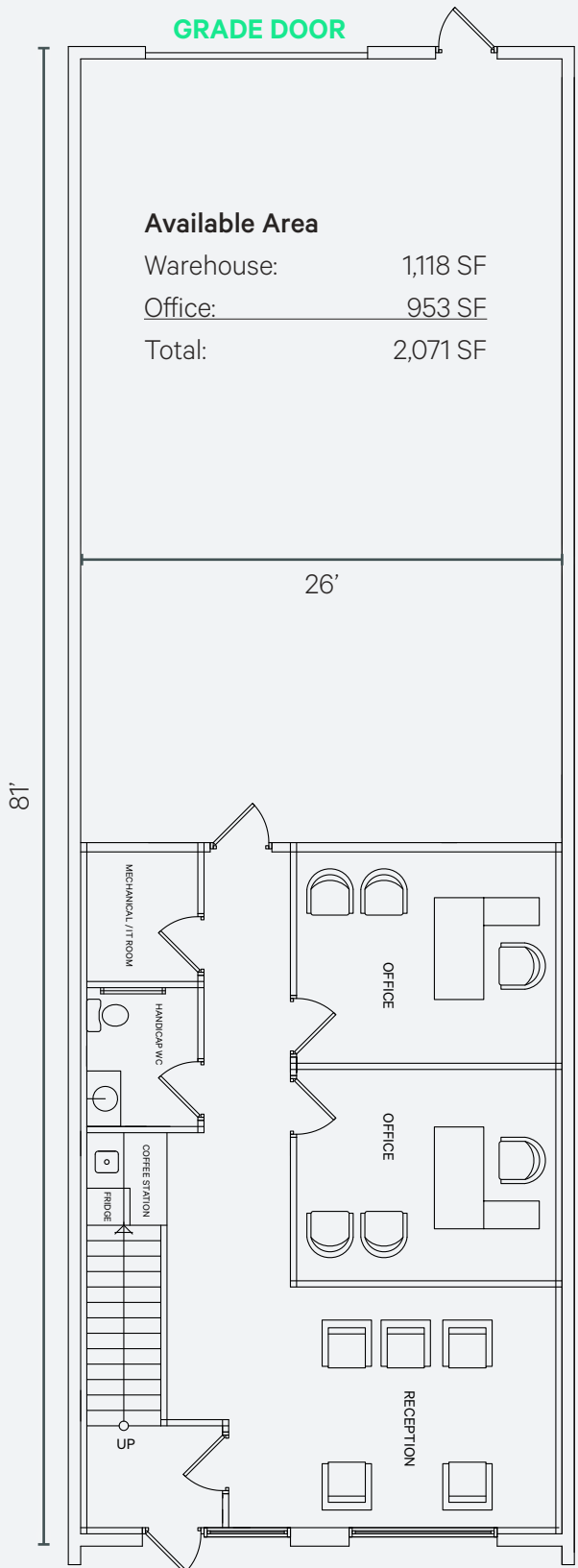

*All values are approximate and subject to verification

Industrial | For Lease

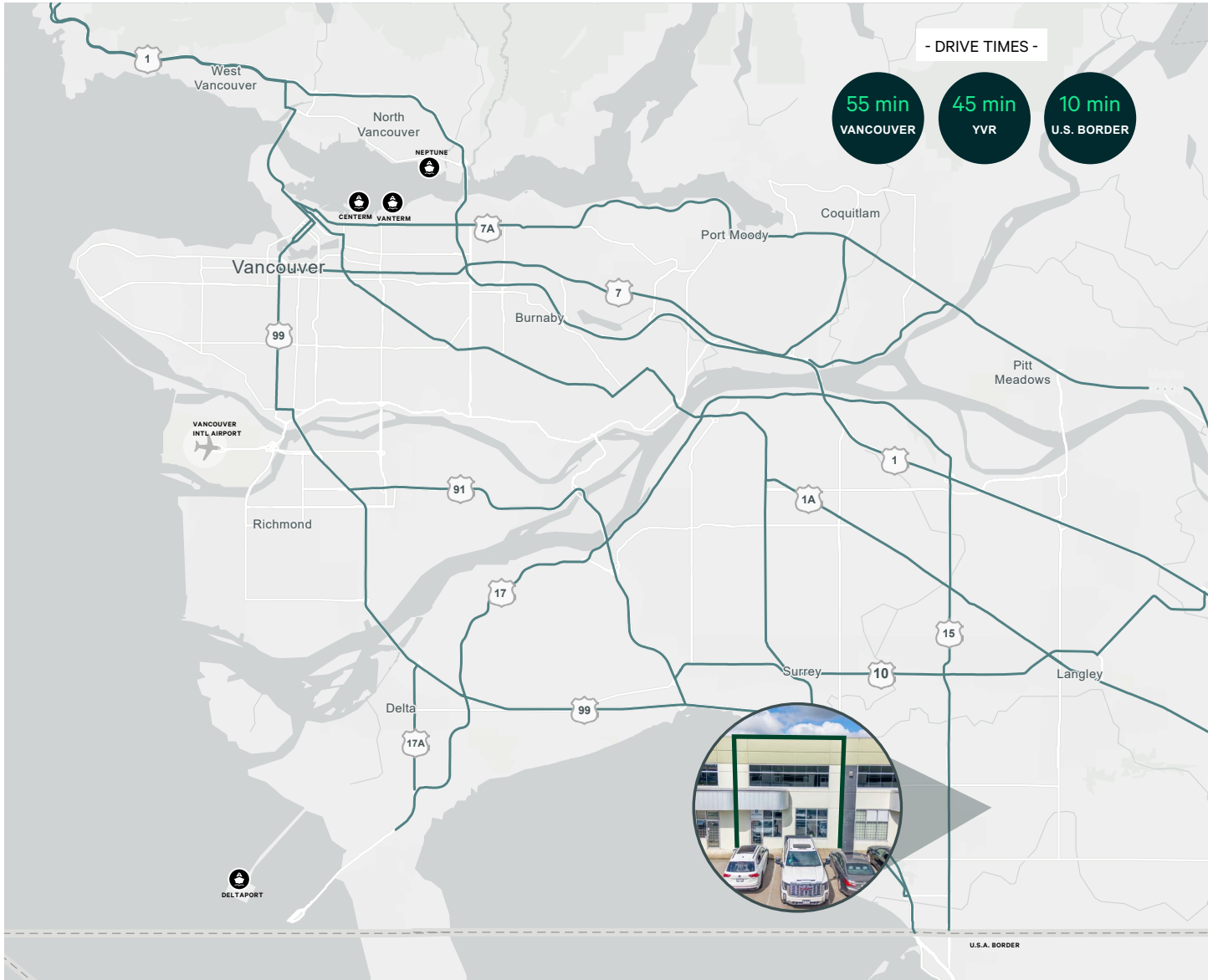

UNIT 7

19102 27th Avenue

Surrey, BC

CBRE

cbre.ca/properties

For more information, contact:

Travis Blanleil

Personal Real Estate Corporation

Vice President

Industrial Properties Group

+1 604 662 5100

travis.blanleil@cbre.com

Vaibhav Seth

Sales Associate

Industrial Properties

+1 778 316 7513

vaibhav.seth@cbre.com

CBRE Limited | 1021 West Hastings Street | #2500 | Vancouver, BC V6E 0C3

This disclaimer shall apply to CBRE Limited, Real Estate Brokerage, and to all other divisions of the Corporation; to include all employees and independent contractors ("CBRE"). The information set out herein, including, without limitation, any projections, images, opinions, assumptions and estimates obtained from third parties (the "Information") has not been verified by CBRE, and CBRE does not represent, warrant or guarantee the accuracy, correctness and completeness of the Information. CBRE does not accept or assume any responsibility or liability, direct or consequential, for the Information or the recipient's reliance upon the Information. The recipient of the Information should take such steps as the recipient may deem necessary to verify the Information prior to placing any reliance upon the Information. The Information may change and any property described in the Information may be withdrawn from the market at any time without notice or obligation to the recipient from CBRE. CBRE and the CBRE logo are the service marks of CBRE Limited and/or its affiliated or related companies in other countries. All other marks displayed on this document are the property of their respective owners. All Rights Reserved. Mapping Sources: Canadian Mapping Services canadamapping@cbre.com; DMTI Spatial, Environics Analytics, Microsoft Bing, Google Earth.