

FOR LEASE

450 SARAH ROAD, INVERMERE, B.C.

1,556 SF NEW BUILD RETAIL OPPORTUNITY

SUBJECT SITE



ATHALMER ROAD



Kootenay
Coffee Works



KOOTENAY HIGHWAY

KOOTENAY HIGHWAY

Robert Hamilton
Senior Associate
(604) 398-2773
RHamilton@MarcusMillichap.com

Marcus & Millichap

FOR LEASE

450 SARAH ROAD, INVERMERE, B.C.

OPPORTUNITY

Excellent opportunity to lease a newly built endcap unit adjacent to Mark's Work Warehouse in Invermere, B.C. Situated in a retail plaza directly positioned in front of anchor tenant Canadian Tire, the unit boasts prime exposure to vehicular traffic along Athalmer Road with proximity to the Kootenay Highway intersection.

INVERMERE

Located in the Columbia Valley between the Purcells and the Rocky Mountains, the town of Invermere can be found upon the northwest shore of Windermere Lake. Invermere boasts a reputation for its temperate climate. Shielded by the imposing Rocky Mountains to the east, the town enjoys respite from harsh Arctic winds in winter. Its proximity to the British Columbia-Alberta border renders Invermere a bustling hub, catering to travelers entering and exiting the province.

HIGHLIGHTS



Opportunity for signage



Ample parking



Proximity to major retailers such as Canadian Tire, No Frills, Tim Hortons, Sobey's and Kicking Horse Cafe



SALIENT DETAILS

Civic Address:	450 Sarah Road, Invermere, B.C.
Leasable Area:	1,556 SF
Zoning:	C-3 (Regional Commercial Zone)
Occupancy:	Immediately
Access:	Direct egress to the Columbia River Bridge westward and Kootenay Highway eastward
Operating Costs:	Please Contact Listing Agents
Lease Rate:	Please Contact Listing Agents

FOR LEASE

450 SARAH ROAD, INVERMERE, B.C.

SITE PLAN

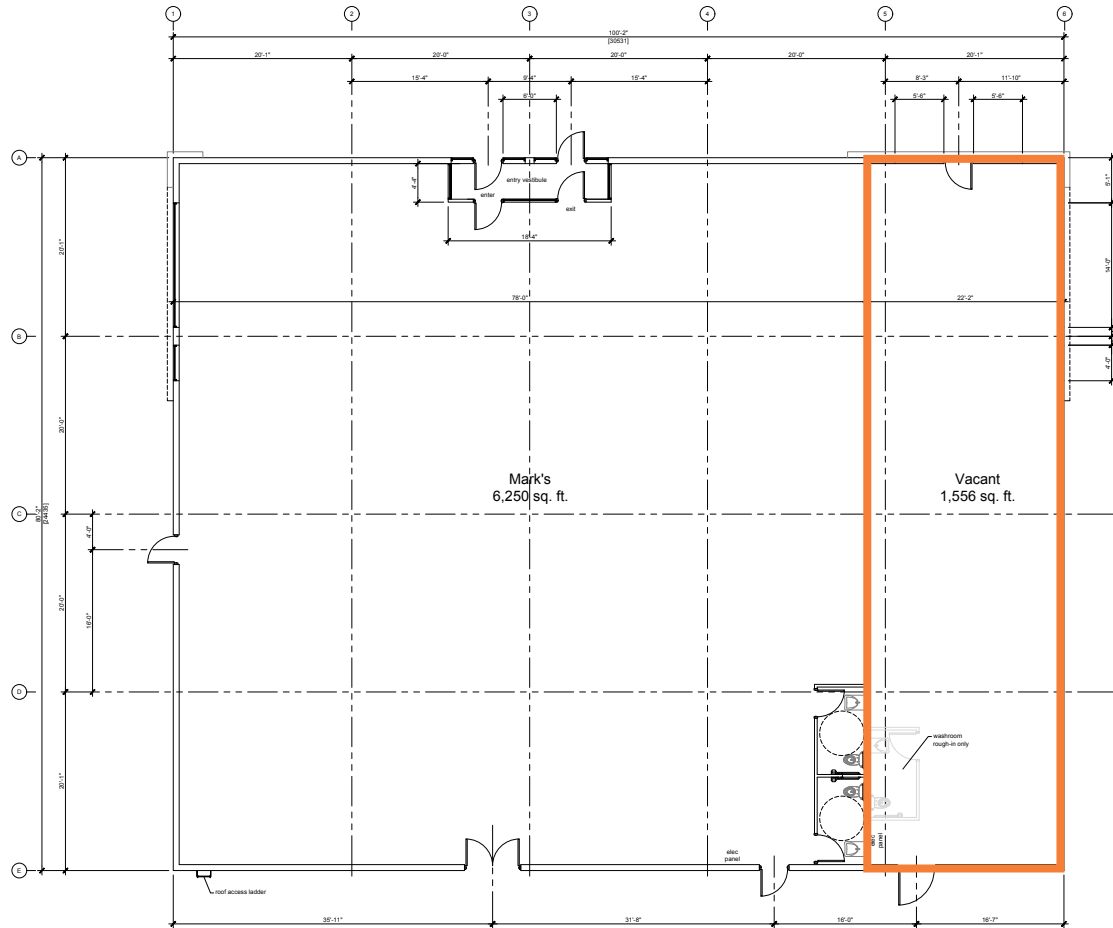

1 FLOOR PLAN
SCALE: 3/16" = 1'-0"

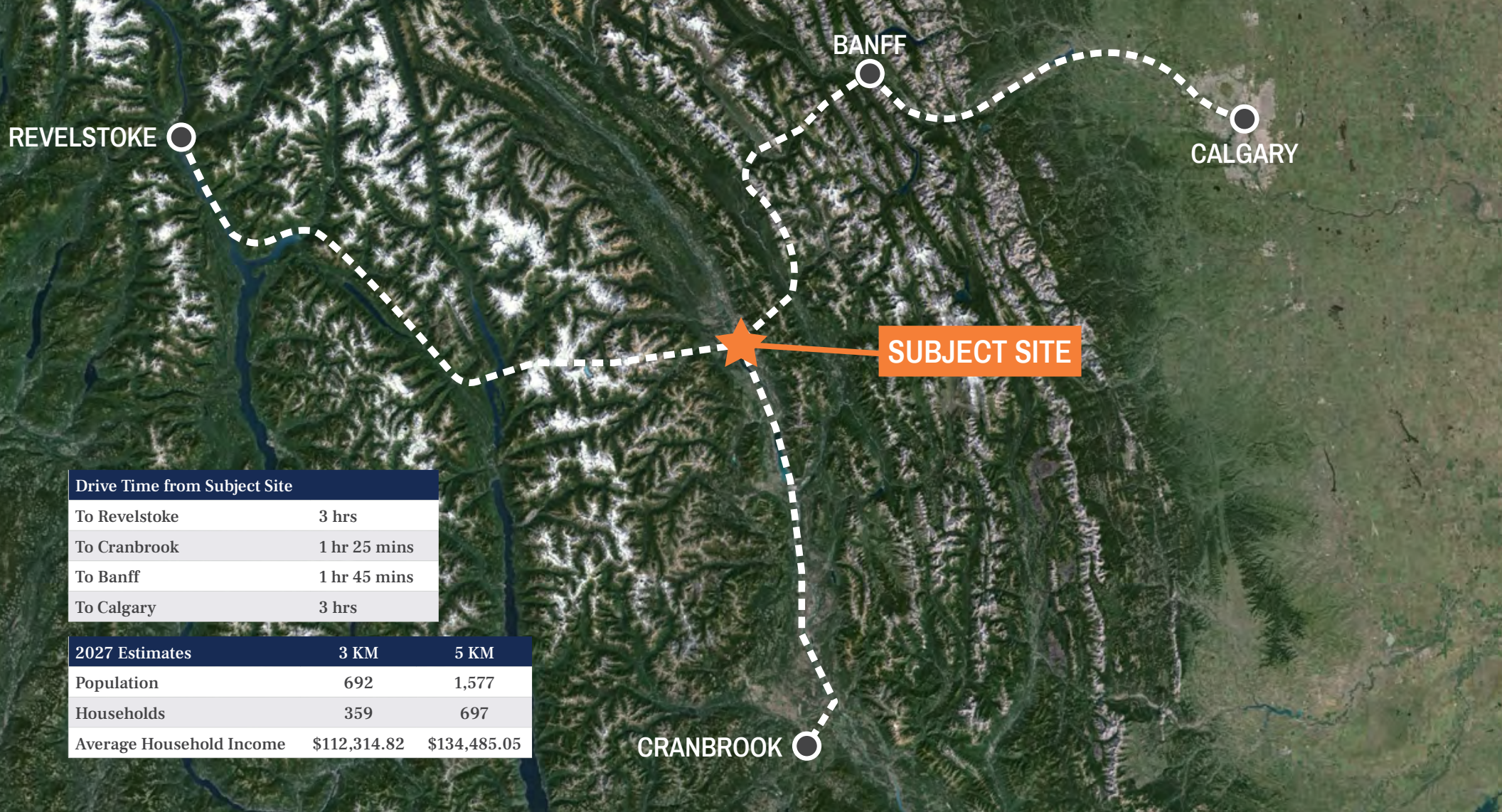

Drive Time from Subject Site	
To Revelstoke	3 hrs
To Cranbrook	1 hr 25 mins
To Banff	1 hr 45 mins
To Calgary	3 hrs

2027 Estimates	3 KM	5 KM
Population	692	1,577
Households	359	697
Average Household Income	\$112,314.82	\$134,485.05

Marcus & Millichap

1100 - 1111 West Georgia Street
Vancouver, BC V6E 4M3

T (604) 638-2121

The information contained in this Marketing Brochure is proprietary and strictly confidential. It is intended to be reviewed only by the party receiving it from Marcus & Millichap and should not be made available to any other person or entity without the written consent of Marcus & Millichap. This Marketing Brochure has been prepared to provide summary, unverified information to prospective purchasers, and to establish only a preliminary level of interest in the subject property. The information contained herein is not a substitute for a thorough due diligence investigation. Marcus & Millichap has not made any investigation, and makes no warranty or representation, with respect to the income or expenses for the subject property, the future projected financial performance of the property, the size and square footage of the property and improvements, the presence or absence of contaminating substances, PCB's or asbestos, the compliance with State and Federal regulations, the physical condition of the improvements thereon, or the financial condition or business prospects of any tenant, or any tenant's plans or intentions to continue its occupancy of the subject property. The information contained in this Marketing Brochure has been obtained from sources we believe to be reliable; however, Marcus & Millichap has not verified, and will not verify, any of the information contained herein, nor has Marcus & Millichap conducted any investigation regarding these matters and makes no warranty or representation whatsoever regarding the accuracy or completeness of the information provided. All potential buyers must take appropriate measures to verify all of the information set forth herein.

Marcus & Millichap is not affiliated with, sponsored by, or endorsed by any commercial tenant or lessee identified in this marketing package. The presence of any corporation's logo or name is not intended to indicate or imply affiliation with, or sponsorship or endorsement by, said corporation of Marcus & Millichap, its affiliates or subsidiaries, or any agent, product, service, or commercial listing of Marcus & Millichap, and is solely included for the purpose of providing tenant lessee information about this listing to prospective customers.

This information has been secured from sources we believe to be reliable, but we make no representations or warranties, express or implied, as to the accuracy of the information. References to square footage or age are approximate. Buyer must verify the information and bears all risk for any inaccuracies. Marcus & Millichap is a trademark of Marcus & Millichap Real Estate Investment Services, Inc. Used under license by Marcus & Millichap Real Estate Investment Services Canada Inc. © 2024 Marcus & Millichap. All rights reserved.