

FOR LEASE

POPLAR BUSINESS CENTRE

NAI Commercial



8703 & 8705 - 50 STREET | EDMONTON, AB | MAIN FLOOR OFFICE/WAREHOUSE

PROPERTY HIGHLIGHTS

- From 2,800 sq. ft. up to 8,167 sq. ft. of flex space available
- Currently under renovation to provide a 2,800 sq. ft.± show suite with new paint, LED lighting, tbar, accessible washroom, and warehouse finishes
- Other bay is mostly wide open ready for tenant improvements
- Grade loading bays
- Economical lease rates
- Large surface paved parking lot

CHAD SNOW

Broker, President
780 436 7410
csnow@naiedmonton.com

KARI MARTIN

Senior Associate
780 435 5301
kmartin@naiedmonton.com

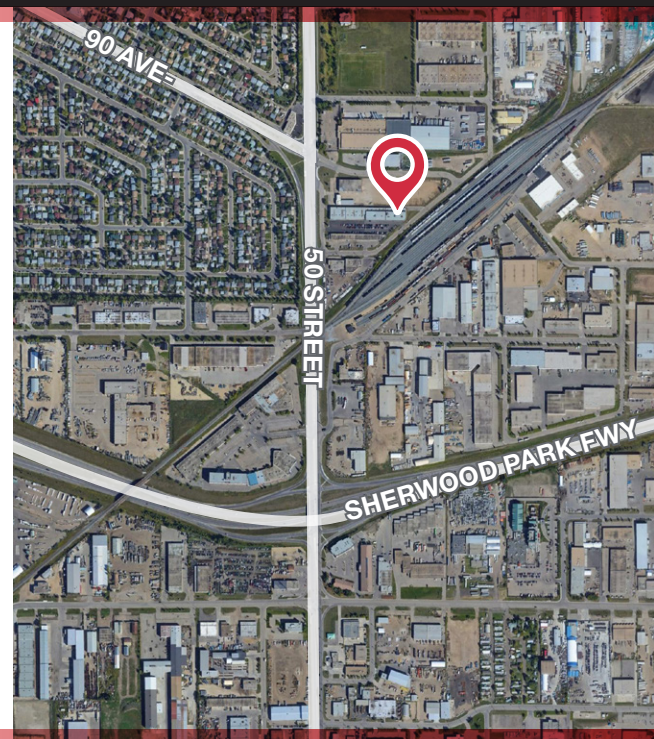

NAI COMMERCIAL REAL ESTATE INC.
4601 99 STREET NW, EDMONTON AB, T6E 4Y1



780 436 7410



NAIEDMONTON.COM



ADDITIONAL INFORMATION

SIZES AVAILABLE 8703: 5,375 sq. ft. ±
 8705: 2,800 sq. ft. ±
 Up to 8,167 sq.ft.±
**to be remeasured after demising wall between bays is constructed*

LEGAL DESCRIPTION Plan 2586KS, Lot B

ZONING BE (Business Employment Zone)

LOADING One grade door per bay

CEILING HEIGHT Warehouse ceiling height 11'±

PYLON SIGNAGE Exposure to 50th Street - Market rates

AVAILABLE Immediately

LEASE TERM 3 - 5 Years

NET RENTAL RATE Starting at \$8.00 per sq. ft. per annum

OPERATING COSTS \$8.14 psf/annum (2026 estimate) Includes common area maintenance, property taxes, building insurance, management, water, and power. Tenant pays separately metered natural gas over and above.

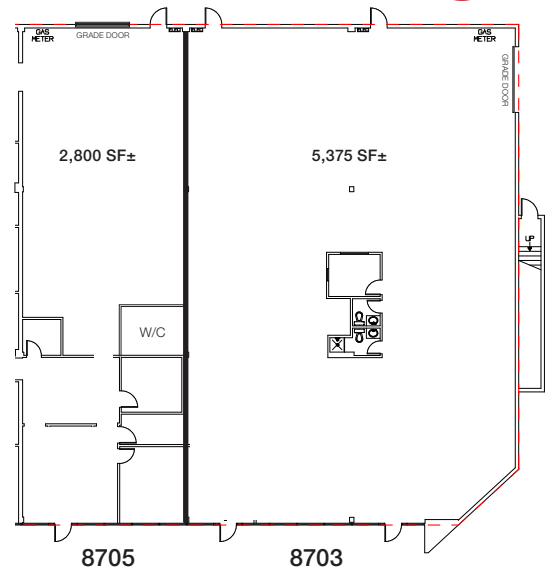

FOR ILLUSTRATIVE PURPOSES ONLY • MAY NOT BE EXACT

