

#210 4940 No.3 Road,  
Richmond B.C.

Occupant Area: 1,293 sq.ft.

Ceiling Height: 8'-4"

Rentable Area: 1,494 sq. ft.

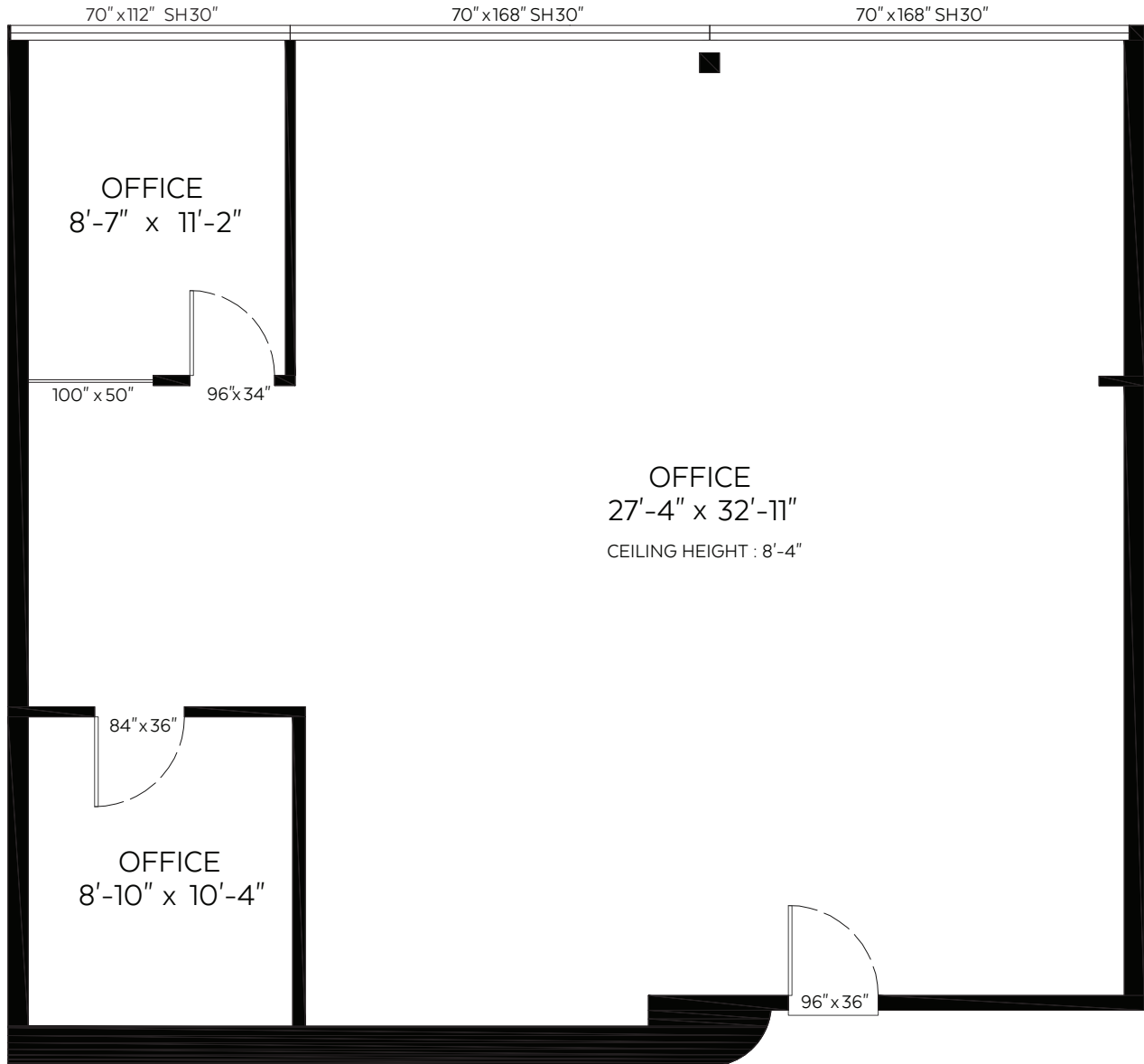

The floor plan is suitable for architectural/construction and is covered under E&O. © Excelsior Measuring Inc. 2019. All rights reserved for Excelsior Measuring Inc. Users shall not publish and distribute such material (in whole or in part) and/or incorporate it in other works in any form.



NORTH