

FOR LEASE | INDUSTRIAL
#303 - 17280 HEATHER DRIVE
SURREY, BC

 **LEE &
ASSOCIATES**
COMMERCIAL REAL ESTATE SERVICES



- ▶ **3,750 SF New Construction Industrial Unit in the Centre of the Fraser Valley**
- ▶ **Immediate Access to Highway 10 and Highway 15**

Ryan Barichello
D 604.630.3371 C 604.889.4146
ryan.barichello@lee-associates.com

CELEBRATING OVER

YEARS IN VANCOUVER

Location

IntraUrban Crossroads is located in the centre of the Fraser Valley with easy access to regional city centres, transportation hubs, border crossings, the Ferry Terminal, and beyond. The location offers immediate access to Highway 10 and Highway 15. IntraUrban Crossroads is walking distance (only a block away) to shopping, dining, and services at the new Cloverdale Town Centre urban commercial hub.

Features

- ▶ 4 parking stalls plus loading area
- ▶ 26' clear warehouse
- ▶ Steel and concrete mezzanine
- ▶ 3-phase power (200 Amp, 208/120V)
- ▶ 500 lbs PSF floor load on main
- ▶ 10' x 12' grade loading door
- ▶ Main floor washrooms
- ▶ HVAC system on second floor
- ▶ ESRF Sprinklers
- ▶ Walking distance to Cloverdale restaurants and coffee shops
- ▶ 6 minutes to Langley
- ▶ 15 minutes to US Border Truck Crossing
- ▶ Convenient access west to Abbotsford and west to Vancouver

Zoning

CD (Highway-Commercial)

Available Area

Ground floor	2,898 SF
Mezzanine/second floor	852 SF
Total	3,750 SF

Asking Lease Rate

\$18.50 PSF

Taxes & Operating Costs

\$7.94 PSF (2026 estimate)

Total Monthly Rent

\$8,262.50 Plus GST and utilities

Availability

December 1, 2026



Site Plan

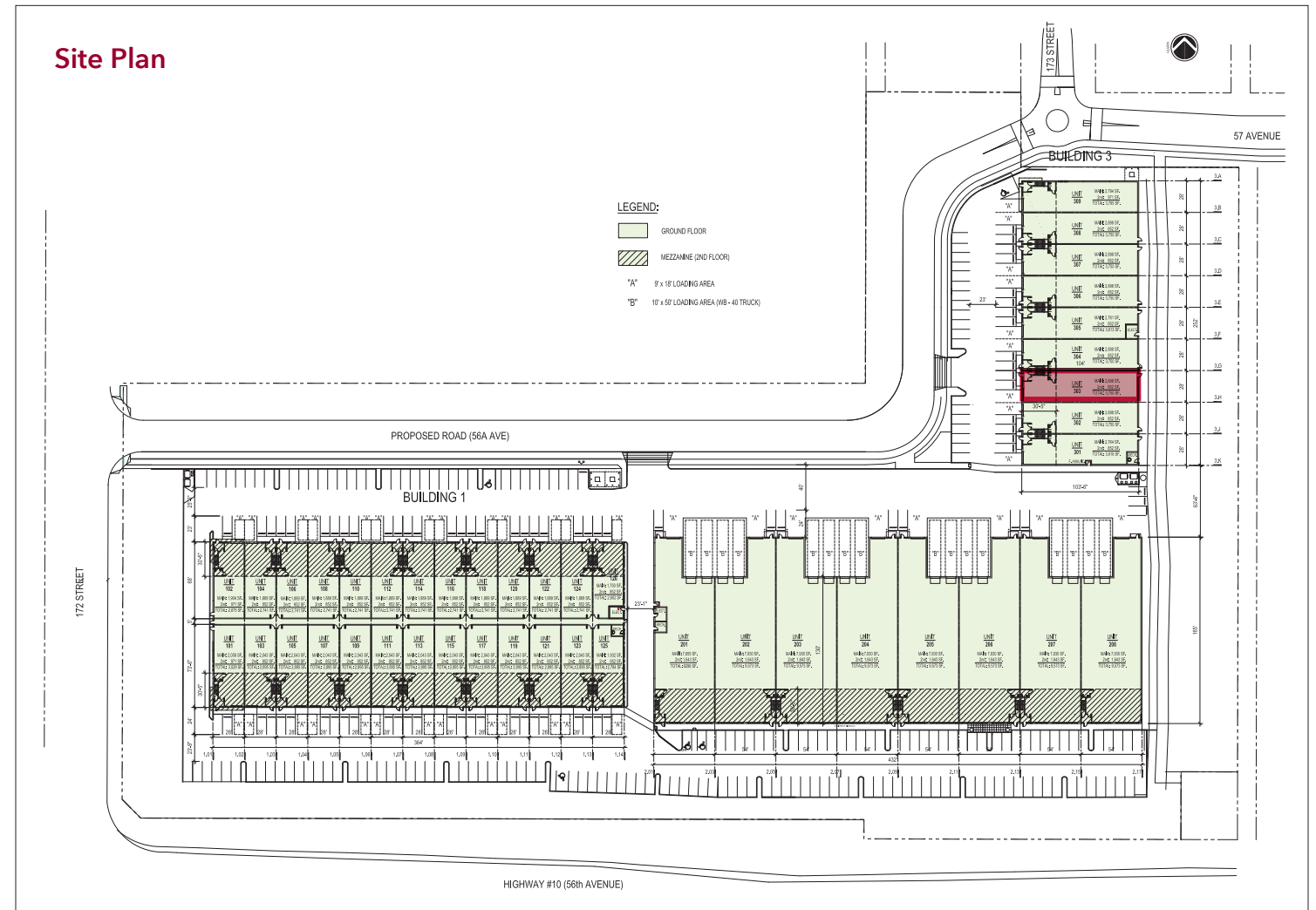



Ryan Barichello
 D 604.630.3371 C 604.889.4146
 ryan.barichello@lee-associates.com

© 2026 Lee & Associates Commercial Real Estate (BC) Ltd. ("Lee & Associates Vancouver"). All Rights Reserved. 608. E. & O.E.: Although the information contained within is from sources believed to be reliable, no warranty or representation is made by Lee & Associates Vancouver as to its accuracy being subject to errors, omissions, conditions, prior lease, withdrawal or other changes without notice and same should not be relied upon without independent verification.

