

FOR LEASE

2721 CLARKE STREET, PORT MOODY, B.C.

OPPORTUNITY IN PORT MOODY MIXED-USE DEVELOPMENT

platform
CLARKE & MOODY

Developed by:

ARAGON



1,766 SF AVAILABLE

CLARKE STREET

Jack Allpress
Personal Real Estate Corporation
(604) 638-1975
JAllpress@MarcusMillichap.com

Robert Hamilton
Personal Real Estate Corporation
(604) 398-2773
RHamilton@MarcusMillichap.com

Marcus & Millichap

FOR LEASE

2721 CLARKE STREET, PORT MOODY, B.C.

MARKET OVERVIEW







Platform is a 6-storey mixed-use building with 104 residential units, and approximately 17,000 SF of ground floor retail and commercial space. Platform is strategically positioned to service existing density and additional residential growth within an immense yet highly affluent trade area.

SALIENT DETAILS

Address:	2721 Clarke Street, Port Moody, B.C.
Availability:	Total: 1,766 SF Mezzanine: 438 SF Main Floor: 1,328 SF
Timing:	Contact Listing Agent
Parking:	38 dedicated underground commercial stalls and 10 street-front stalls
Traffic Counts:	Total: +/- 50,484 VPD Clarke St: +/- 14,274 VPD St. Johns St: +/- 36,210 VPD
Additional Rent:	Contact Listing Agent
Asking Rent:	Contact Listing Agent



PROPERTY HIGHLIGHTS

-  Excellent exposure to pedestrian and vehicular traffic, with St. Johns Street exceeding 36,000 VPD
-  Platform sits at the northwest corner of Clarke Street and Moody Street in the Moody Centre area of Port Moody
-  Centrally located in the heart of an emerging craft beer and restaurant node with several breweries in the immediate area
-  Situated within a 5 minute walk of Moody Centre Station, the property benefits from exceptional connectivity to rapid transit via the Millennium SkyTrain Line and the West Coast Express
-  The \$1.4 billion Evergreen Extension provides the site accessibility from Vancouver, Burnaby, and Coquitlam with an average ridership reaching 40,000 daily commuters
-  Platform is a mixed-use development featuring a collection of 104 boutique homes as part of its residential component
-  Average household income within a 3km radius of the Property is \$147,819

FOR LEASE

2721 CLARKE STREET, PORT MOODY, B.C.

SITE PLAN

For Lease
 Under Contract
 Leased

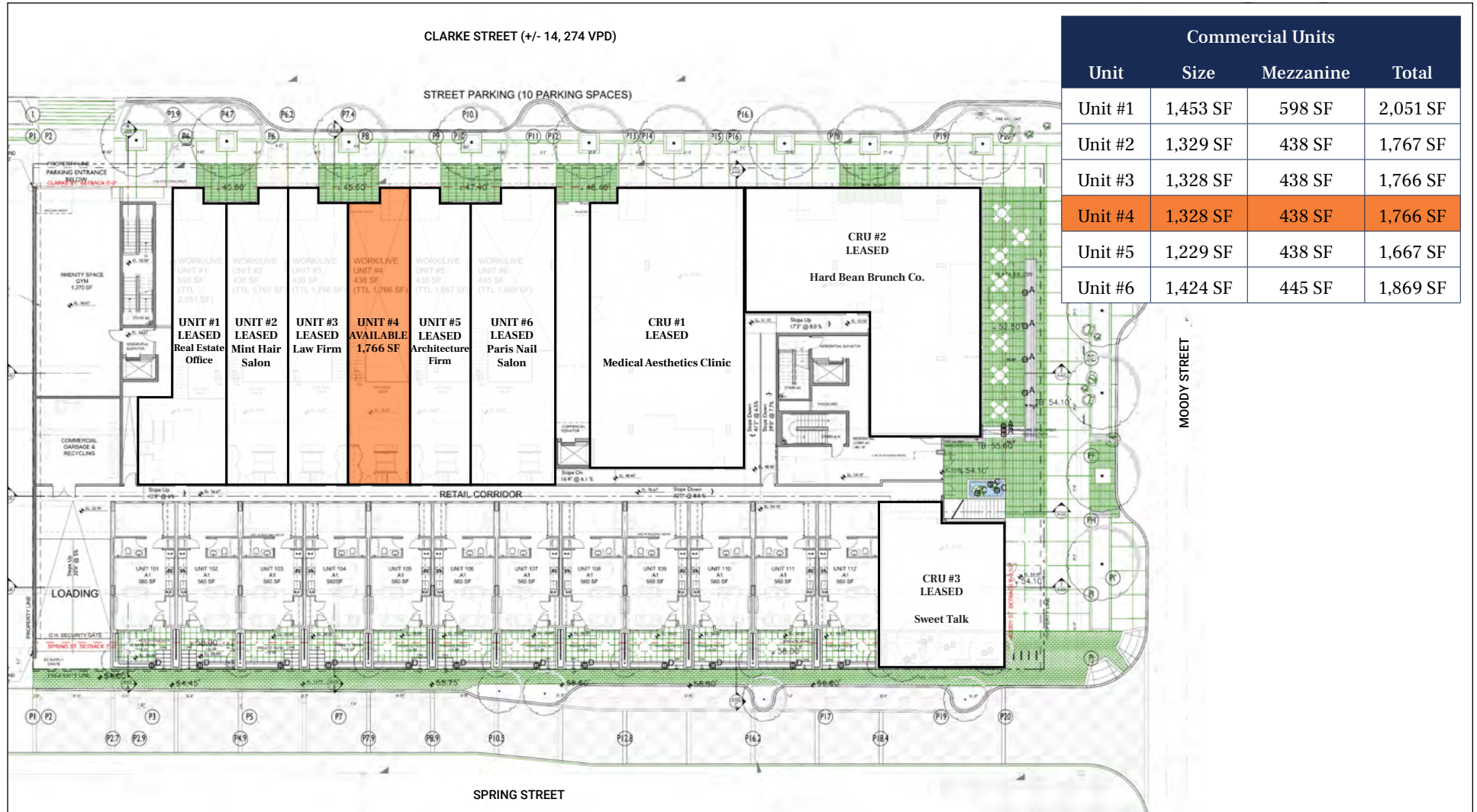

Commercial Units			
Unit	Size	Mezzanine	Total
Unit #1	1,453 SF	598 SF	2,051 SF
Unit #2	1,329 SF	438 SF	1,767 SF
Unit #3	1,328 SF	438 SF	1,766 SF
Unit #4	1,328 SF	438 SF	1,766 SF
Unit #5	1,229 SF	438 SF	1,667 SF
Unit #6	1,424 SF	445 SF	1,869 SF

FOR LEASE

2721 CLARKE STREET, PORT MOODY, B.C.

2025 Demographics	3 min radius	5 min radius	10 min radius
2025 Avg. Household Income	\$147,819	\$154,391	\$137,814
2025 Total Population	9,104	27,532	163,866
% Pop. Change (2025-2030)	12.9%	11.7%	8.3%
2025 Households	5,185	12,509	69,649

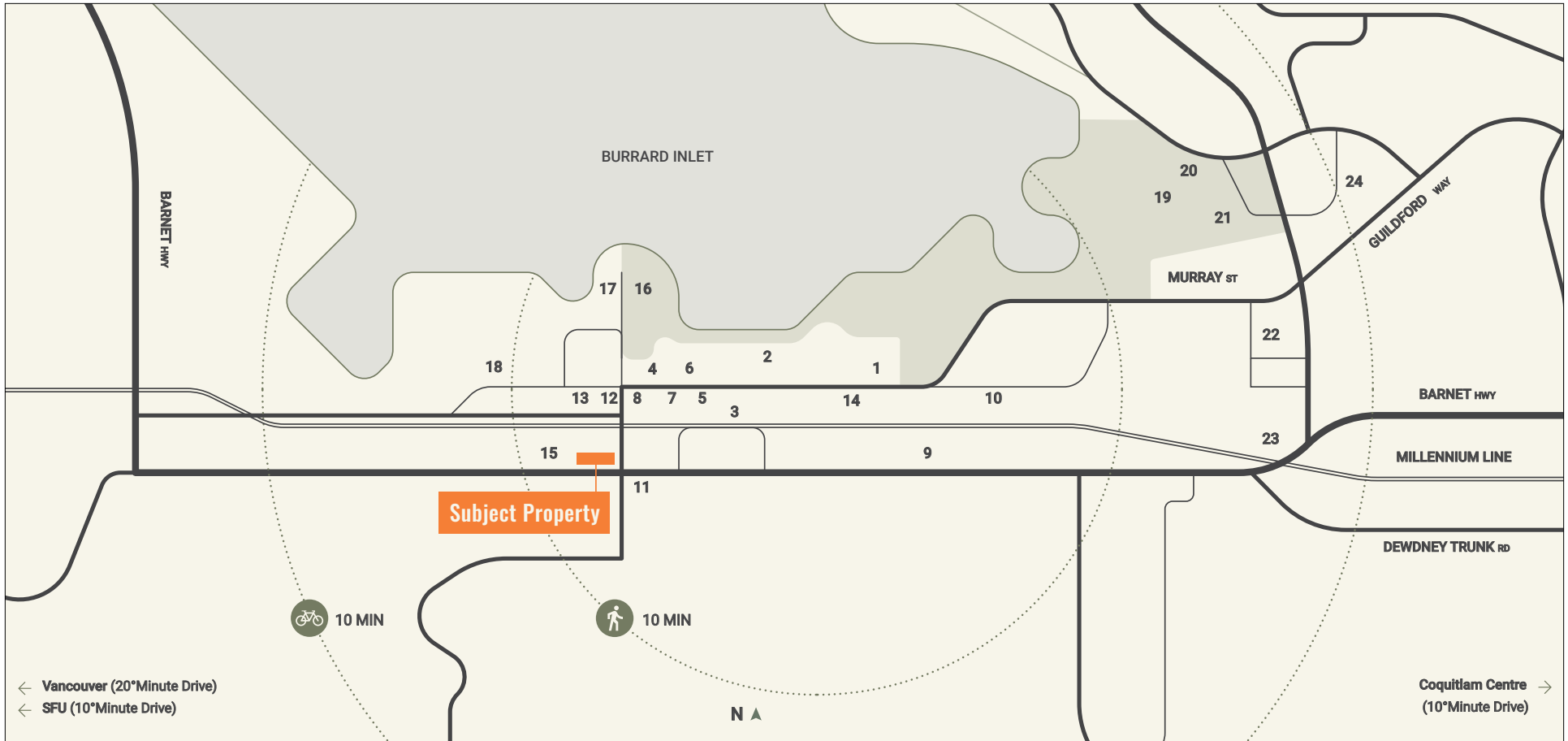

- | | | | | |
|----------------------------------|---------------------------|-----------------------------------|-----------------------------------|-----------------------------------|
| 1. Inlet Park | 6. EV charging station | 11. Pizzeria Spacca Napoli | 16. Rocky Point Park | 21. Port Moody Public Library |
| 2. Shoreline Trail | 7. Yellow Dog Brewing Co. | 12. Innovative Fitness Port Moody | 17. The Boathouse Restaurant | 22. Suter Brook Village |
| 3. Moody Centre SkyTrain Station | 8. Rocky Point Spirits | 13. The Parkside Brewery | 18. Moody Ales | 23. Inlet Centre SkyTrain Station |
| 4. Rocky Point Ice Cream | 9. Matsuzushi | 14. Moody Yards | 19. Port Moody Farmers Market | 24. Newport Village |
| 5. Twin Sails Brewing | 10. Caffé Divano | 15. KAFFI Espresso Bar | 20. Port Moody Recreation Complex | |

Marcus & Millichap

Marcus & Millichap
1100 - 1111 West Georgia Street
Vancouver, BC V6E 4M3

T (604) 638-2121
F (604) 638-2122

MarcusMillichap.ca

The information contained in the following Marketing Brochure is proprietary and strictly confidential. It is intended to be reviewed only by the party receiving it from Marcus & Millichap and should not be made available to any other person or entity without the written consent of Marcus & Millichap. This Marketing Brochure has been prepared to provide summary, unverified information to prospective purchasers, and to establish only a preliminary level of interest in the subject property. The information contained herein is not a substitute for a thorough due diligence investigation. Marcus & Millichap has not made any investigation, and makes no warranty or representation, with respect to the income or expenses for the subject property, the future projected financial performance of the property, the size and square footage of the property and improvements, the presence or absence of contaminating substances, PCB's or asbestos, the compliance with State and Federal regulations, the physical condition of the improvements thereon, or the financial condition or business prospects of any tenant, or any tenant's plans or intentions to continue its occupancy of the subject property. The information contained in this Marketing Brochure has been obtained from sources we believe to be reliable; however, Marcus & Millichap has not verified, and will not verify, any of the information contained herein, nor has Marcus & Millichap conducted any investigation regarding these matters and makes no warranty or representation whatsoever regarding the accuracy or completeness of the information provided. All potential buyers must take appropriate measures to verify all of the information set forth herein.

Marcus & Millichap is not affiliated with, sponsored by, or endorsed by any commercial tenant or lessee identified in this marketing package. The presence of any corporation's logo or name is not intended to indicate or imply affiliation with, or sponsorship or endorsement by, said corporation of Marcus & Millichap, its affiliates or subsidiaries, or any agent, product, service, or commercial listing of Marcus & Millichap, and is solely included for the purpose of providing tenant lessee information about this listing to prospective customers.

This information has been secured from sources we believe to be reliable, but we make no representations or warranties, express or implied, as to the accuracy of the information. References to square footage or age are approximate. Buyer must verify the information and bears all risk for any inaccuracies. Marcus & Millichap is a trademark of Marcus & Millichap Real Estate Investment Services, Inc. Used under license by Marcus & Millichap Real Estate Investment Services Canada Inc. © 2026 Marcus & Millichap. All rights reserved.