



OFFICE / SHOWROOM /  
WAREHOUSE SPACE

FOR LEASE

## 43 Grenfell Crescent, Bay 2, Nepean, ON K2G 0G3

### BUILDING FEATURES

- Total Area: 3,740 sq. ft.
- Reception, showroom and 5 offices
  - 28 ft. 11 inches by 49 ft.
- AC in office area only
- Warehouse area
- 1 Garage door
  - 9 ft. 4 inches (W) by 9 ft. 10 inches (H)
- 12 ft. ceiling height
- Two electrical services
  - 60 Amp 120/208 volt 3 phase
  - 225 Amp 120/208 3 phase

### LEASE DETAILS

ADDRESS	43 Grenfell Crescent, Bay 2, Nepean, ON K2G 0G3
RENTAL RATE PER SQ. FT.	\$19.00
RECOVERABLE COSTS PER SQ. FT.	\$8.77
WAREHOUSE SPACE	Approx. 2,320 sq. ft.
OFFICE SPACE	Approx. 1,420 sq. ft.
LEASE TERM	3 – 5 Years
ZONING CODE	IP[178]
OCCUPANCY	Dec 1, 2025



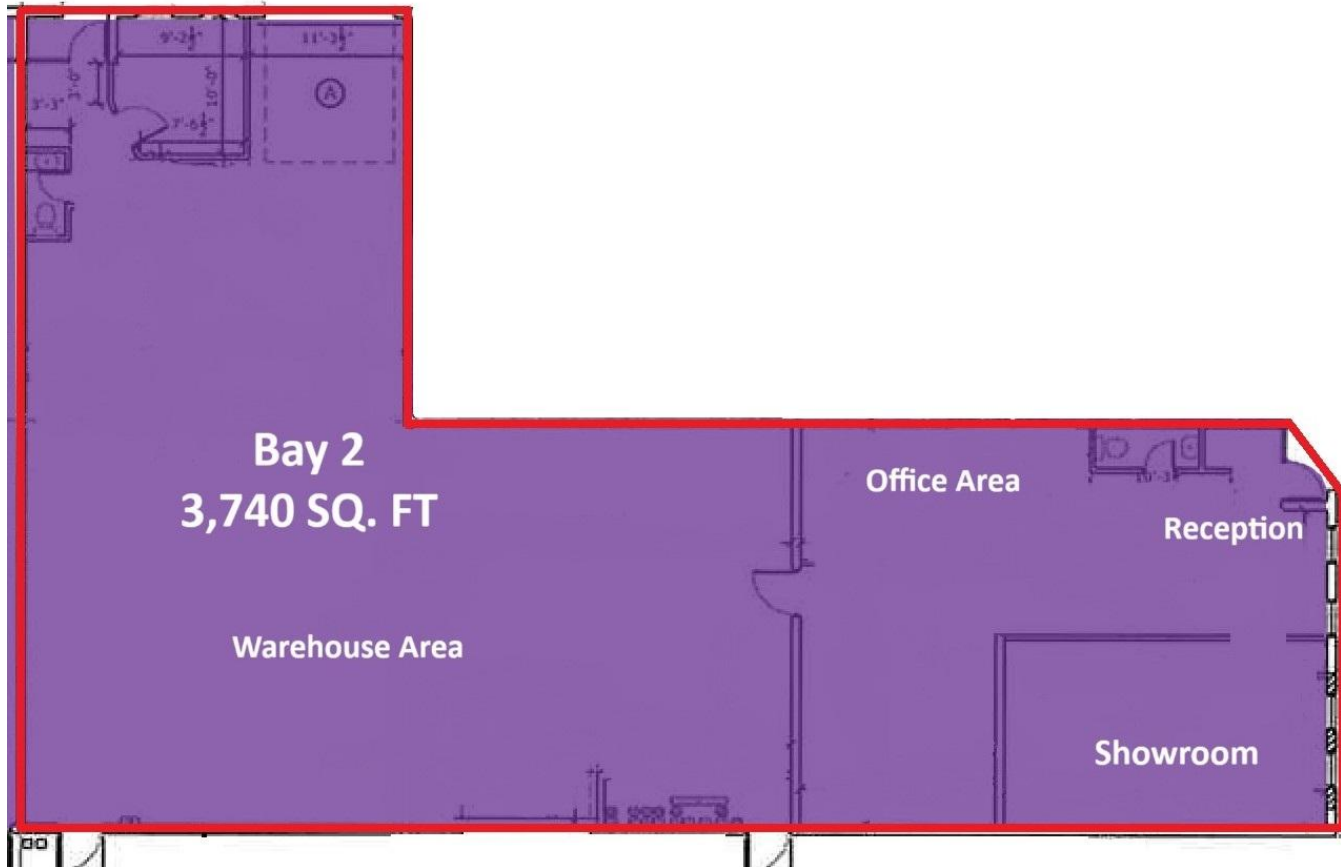

## GEOFFREY H. GODDING CPM

Senior VP / Commercial Sales  
Representative

Capworth Commercial Realty Brokerage  
Corporation

Direct # 613.720.1186

Main Office # 613.663-2549 ext. 4

Email: geoffg@bell.net

Main Office:

1390 Prince of Wales Drive,  
Suite 106, Ottawa, Ontario K2C 3N6

## ADDITIONAL RENT INCLUDES:

- General Maintenance & Repair
- Management & Administration
- Insurance
- Landscape
- Real Estate Taxes
- Snow Removal
- Water & Sewer

Hydro and gas is metered and paid  
directly by the tenant.

Recoverable cost are estimated at \$8.77  
per month for year ending December 31,  
2025

This communication is intended for general information only and not to be relied upon in any way. Consequently, no responsibility or liability whatsoever can be accepted by CAPWORTH for any loss or damage resulting from any use of, reliance on or reference to the contents of this document, including hypertext links to external sources. In addition, as a general communication, this material does not necessarily represent the view of CAPWORTH in relation to particular properties or projects. This communication is not intended to cause or induce breach of any agency agreement. Reproduction or distribution of this communication in whole or in part is not allowed without prior written approval of CAPWORTH.