

810

BLANSHARD STREET















City Views, Private Patio Space, & Flexible Floor Plates

CBRE Limited is thrilled to offer a fabulous opportunity to lease office space in the prestigious Robert Ker Building. Nestled between Downtown and Fairfield.

Office | For Lease

CBRE

BUILDING

-  Four storeys of office space totaling 34,569 SF
-  Flexible floor plates
-  3,303 SF patio
-  Kitchenette on each floor
-  Common washrooms on each floor
-  Boardroom on each floor
-  Secure bicycle storage
-  Underground parking
-  Break/lounge area on each floor
-  End of trip facilities
-  Convenient location
-  Flexible floorplates
-  Central Business District Zoning (CBD-1)

ALL FLOORS DEMISABLE TO SUIT TENANT'S REQUIREMENT

04	OFFICE SPACE 7,856 SF
03	OFFICE SPACE 7,856 SF
02	OFFICE SPACE & PRIVATE PATIO 7,856 SF 3,303 SF Patio
01	OFFICE SPACE 11,001 SF
LF	LOWER FLOOR Parking

ADDITIONAL RENT \$15.89 PSF

DETAILS + DATA

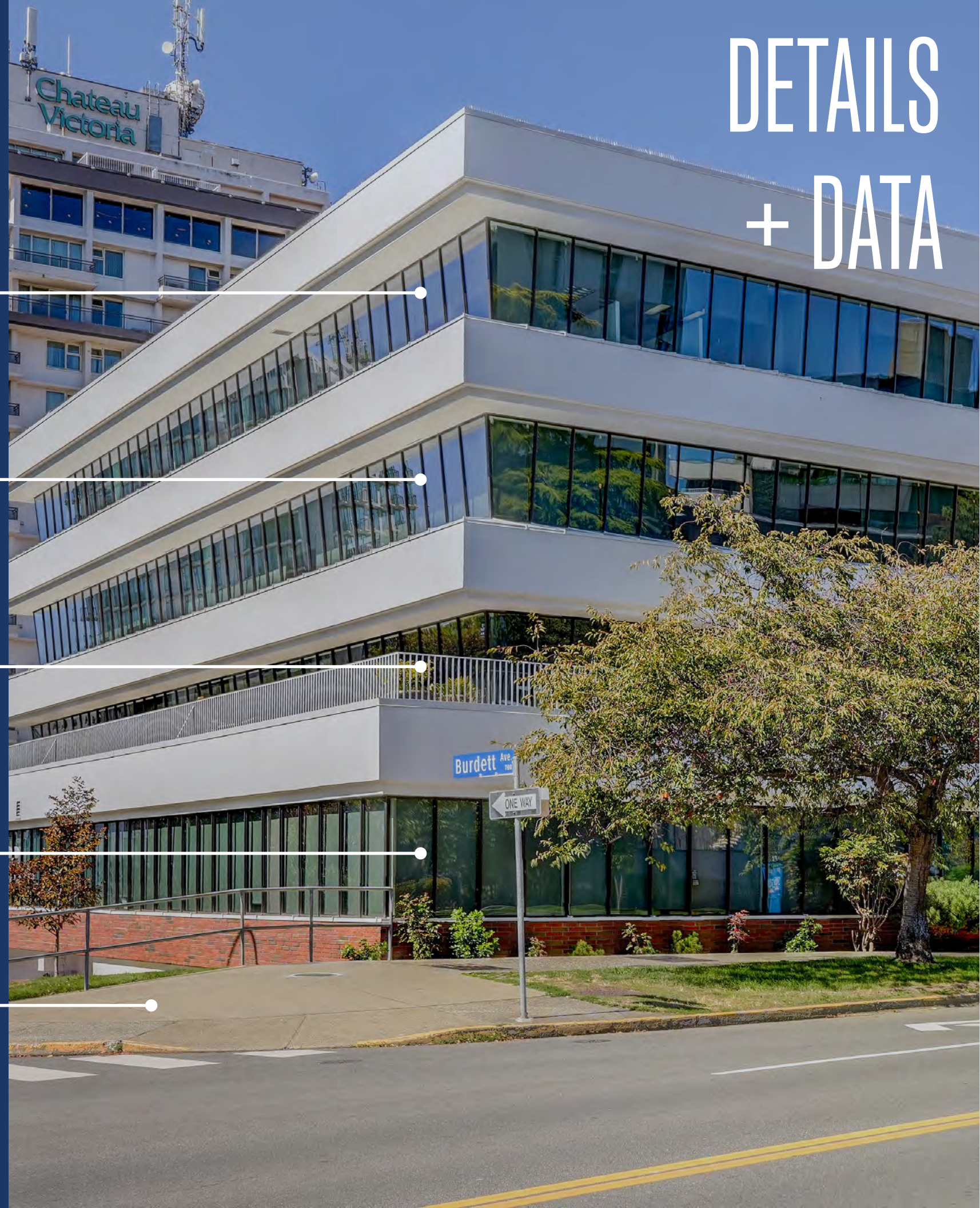

02 LEVEL | TEST FIT

CREATIVE OFFICE - DEMISE OPTION

■ Seat Count - Suite 201

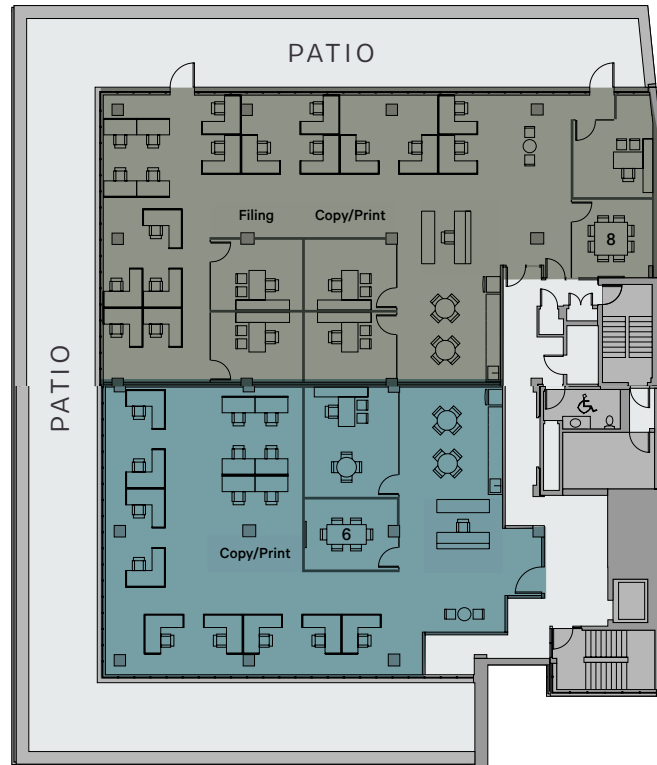

- 14 Workstation
- 5 Office
- 2 Breakout Area
- 8 Conference Room
- 8 Kitchen & Lounge
- 1 Reception
- 2 Support Space

■ Seat Count - Suite 202

- 9 Workstation
- 1 Office
- 2 Breakout Area
- 6 Conference Room
- 8 Kitchen & Lounge
- 1 Reception
- 1 Support Space

Not to scale

04 LEVEL | TEST FIT

TECH OFFICE

Seat Count

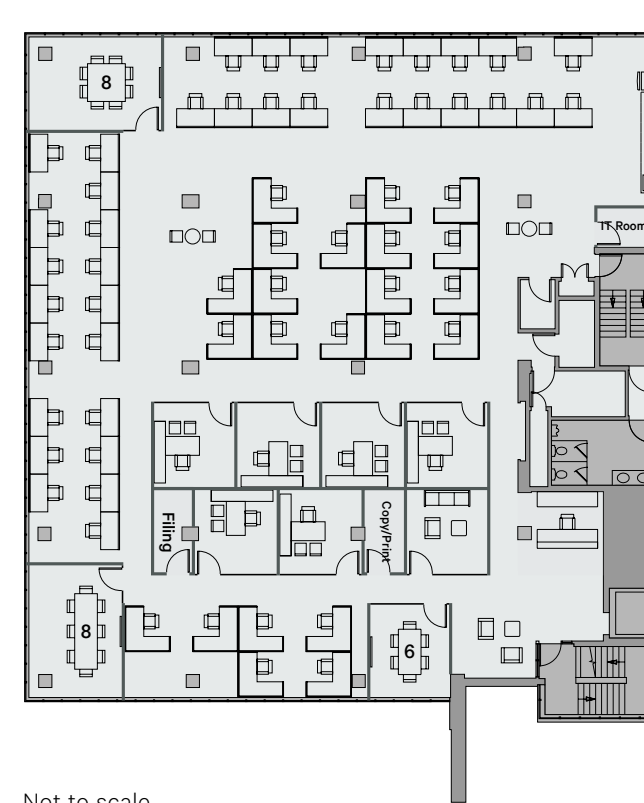

- 36 Open Workstation
- 23 Workstation
- 6 Office
- 6 Breakout Area
- 22 Conference Room
- 4 Huddle Room
- 1 Reception
- 3 Support Space

Not to scale



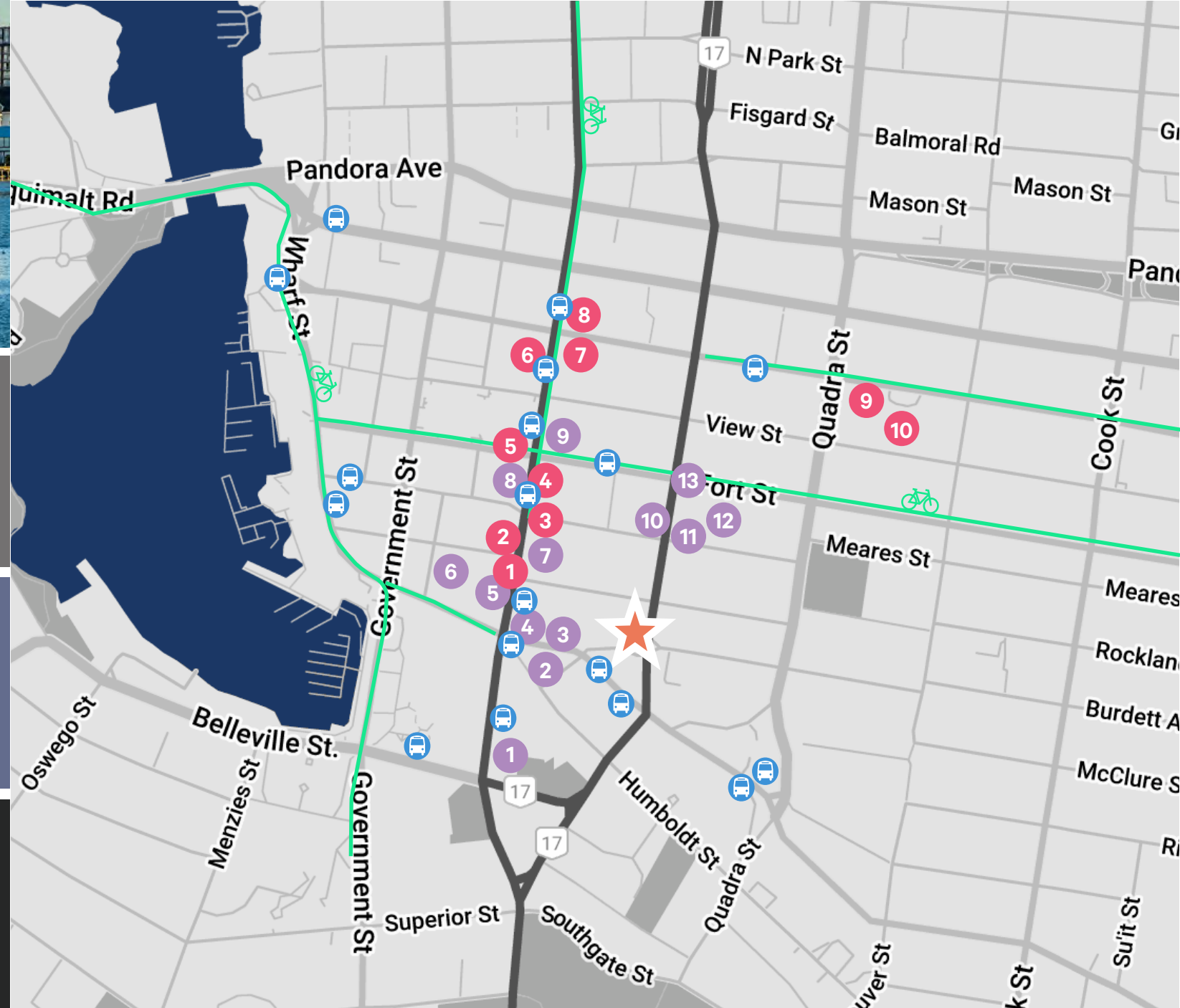

WALK
SCORE
99

TRANSIT
SCORE
92

BIKE
SCORE
84



LOCATION

810 Blanshard Street is located in the heart of Victoria, surrounded by numerous eateries, shops, and cultural attractions. Nearby landmarks include the Royal Theatre, Beacon Hill Park, the Fairmont Empress and the Victoria Conference Centre. The location offers easy access to public transportation. An ideal location for those seeking a central, vibrant, urban environment.

● CAFES + RESTAURANTS

1. The Old Spaghetti Factory
2. Starbucks
3. Ithaka Greek
4. Browns Socialhouse
5. Noodlebox
6. The Courtney Room
7. The Sticky Wicket Bar & Restaurant
8. Chipotle
9. Cactus Club Cafe

● BUSINESSES

1. National Bank
2. Rexall
3. Island Savings
4. RBC Royal Bank
5. TD Canada Trust
6. Shoppers Drug Mart
7. BMO Bank of Montreal
8. Scotiabank
9. London Drugs



810

BLANSHARD STREET



Contact Agents

Jeff Lougheed

Vice President
+1 250 386 0001

jeff.lougheed@cbre.com

Andrea Teahen

Senior Associate
+1 250 813 3377

andrea.teahen@cbre.com

CBRE

www.cbrevictoria.com | www.cbre.ca

This disclaimer shall apply to CBRE Limited, Real Estate Brokerage, and to all other divisions of the Corporation; to include all employees and independent contractors ("CBRE"). The information set out herein, including, without limitation, any projections, images, opinions, assumptions and estimates obtained from third parties (the "Information") has not been verified by CBRE, and CBRE does not represent, warrant or guarantee the accuracy, correctness and completeness of the Information. CBRE does not accept or assume any responsibility or liability, direct or consequential, for the Information or the recipient's reliance upon the Information. The recipient of the Information should take such steps as the recipient may deem necessary to verify the Information prior to placing any reliance upon the Information. The Information may change and any property described in the Information may be withdrawn from the market at any time without notice or obligation to the recipient from CBRE. CBRE and the CBRE logo are the service marks of CBRE Limited and/or its affiliated or related companies in other countries. Content contained in this material has been generated in whole or in part by or with the assistance of generative artificial intelligence. All other marks displayed on this document are the property of their respective owners. All Rights Reserved. Mapping Sources: Canadian Mapping Services canadamapping@cbre.com; DMTI Spatial, EnviroNics Analytics, Microsoft Bing, Google Earth.