

CORRAL CENTRE

Western Manitoba's Premier Retail / Mixed-Use Power Centre

811 18th Street North, Brandon, Manitoba

FULLY DEVELOPED OFFICE SPACE OPPORTUNITY



BUSY
RETAIL NODE



GREAT
ACCESS



SUBSTANTIAL
PARKING



STRONG
RESIDENTIAL



235,500+
TRADE AREA

www.shindico.com

Shindico

811 18th Street North, Brandon, Manitoba

The site plan illustrates the proposed development's layout, including the building footprint, parking spaces, and surrounding streets. Key features include:

- Mark's:** A large rectangular building footprint with a yellow box highlighting a section.
- SleepCountry:** A building footprint adjacent to Mark's, with a yellow box highlighting a section labeled "2,944 SF".
- LIQUOR MART:** A building footprint to the right of SleepCountry.
- SAFeway:** A large building footprint at the bottom left of the plan.
- Western Financial Group, CHATTERS, SALLY, petvalu, and Walmart one:** A vertical strip of building footprints along the right edge of the plan.
- Bus Stop:** Two locations are marked with "BUS STOP" labels and bus symbols.
- EXISTING TRANSFORMATION:** A label indicating an area for existing transformation.
- 20 Parking Spots:** A label indicating the number of parking spots in a specific area.
- 5.35' S.F.:** A label indicating the square footage of a specific area.

APPROXIMATE

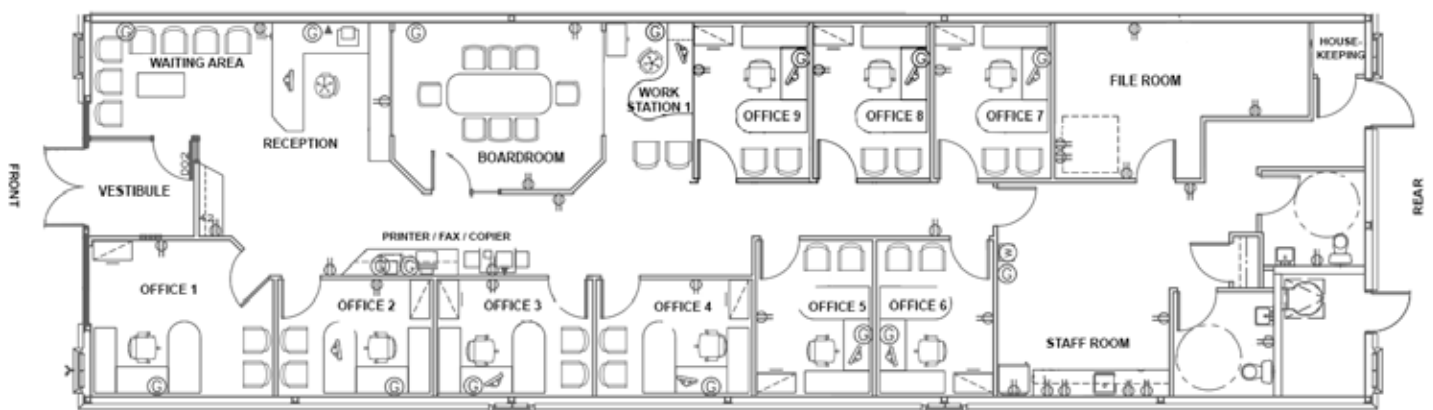

CORRAL CENTRE

811 18th Street North, Brandon, Manitoba



PROPERTY SUMMARY

Available	2,944 SF
Net Rent	TBN
Property Taxes (2025 est.)	\$5.78/SF
CAM* (2025 est.)	\$2.91/SF
Zoning	CAR - Commercial
Parking	Ample

*plus management fee of 5% of gross rent

FEATURES

- Fully developed office space.
- Adjacent to Marks and Sleep Country.
- Signage on three sides.
- End cap in freestanding building in front of Home Depot with exposure directly into Safeway's parking pool.

LOCATION

- Corral Centre is a **500,000 sq. ft.** retail / mixed-use power centre located on 39 acres.
- Anchored by Walmart Supercentre, Home Depot, and Safeway, the centre draws consistent traffic from across Western Manitoba.
- Strong lineup of national and regional retailers—including Best Buy, Winners, Michaels, Liquor Mart, Mark's, Dollarama, Subway, Starbucks, Montana's, and Ashley Furniture.
- Strategically positioned at the major intersection of 18th Street (Brandon's dominant commercial artery) and Kirkcaldy Drive, just south of the Trans-Canada Highway #1, with unmatched visibility and accessibility via two signalized intersections and a right in/out on 18th Street.

TRAFFIC

- 23,790 vehicles per day on 18th Street at Kirkcaldy Drive (City of Brandon).

CORRAL CENTRE

811 18th Street North, Brandon, Manitoba

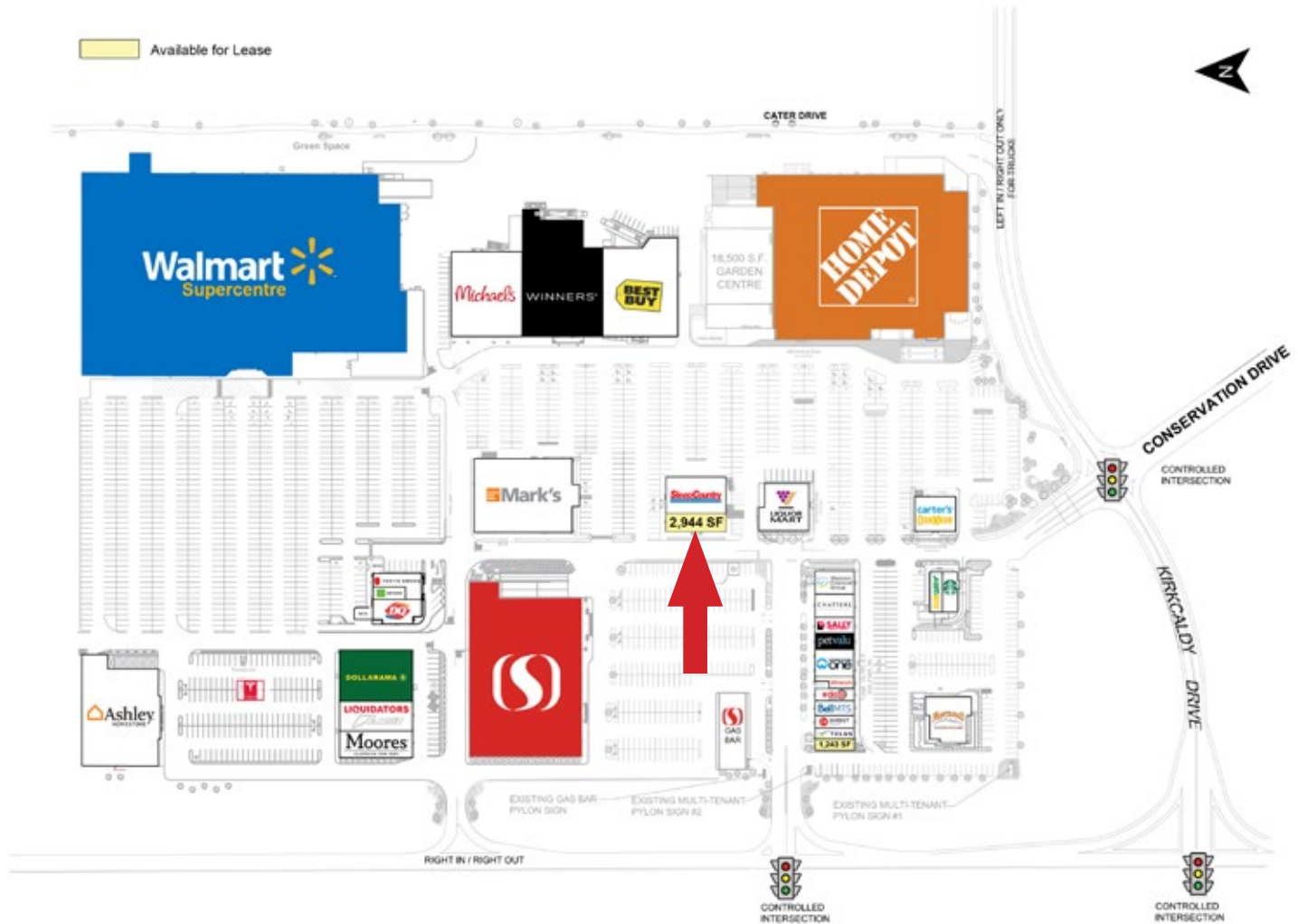

FOR MORE INFORMATION, PLEASE CONTACT:

Michael Stronger*

*SHINDICO REALTY, MICHAEL STRONGER and SHINDICO REALTY are affiliated Brokers

P (204) 928-8237

C (204) 793-3448

mstronger@shindico.com

Dino Alevizos*

*Services provided by Dino Alevizos Personal Real Estate Corporation

P (204) 928-8209

C (204) 781-9717

dalevizos@shindico.com

Shindico Realty Inc.
200-1355 Taylor Avenue
Winnipeg, Manitoba R3M 3Y9
P (204) 474-2000
inquire@shindico.com
www.shindico.com



Shindico
Succeeding by Helping Others Succeed



Shindico is dedicated to the protection of the environment and the communities that we are a part of.

The accuracy of the information set out herein has not been confirmed, and Shindico Realty Inc. and its affiliates make no representations or warranties as to the accuracy of the information and assumes no responsibility for errors or omissions. The recipient is responsible to verify the accuracy of any information and bears all risk related to any inaccuracies. 100925