

FOR LEASE



PARTNERS GLOBAL
CORPORATE REAL ESTATE

WOODLAWN PLAZA

114 Woodlawn Road
Dartmouth, NS



Discover Woodlawn Plaza

Woodlawn Plaza is located on Woodlawn Road, with exposure from Portland Street, one of Dartmouth's primary commercial arteries. The Plaza's main entrance is situated at a signalized intersection, providing easy access to the parking lot. Anchored by national tenants such as Staples, Giant Tiger, and Bulk Barn, the plaza provides excellent visibility with prominent signage opportunities. The high-traffic area is traveled by upwards of 40,000 vehicles each day. Tenants and customers benefit from free parking and convenient access to major transit lines. Professionally managed and vibrant, Woodlawn Plaza is ideal for a variety of retail, service, and office businesses.

Demographics | 10 km Radius



Population

252,622



Households

115,676



Median Age

47



Median Income

\$96,833



10-Year Growth

16.25%

*Data from 2023 Environics Analytics

Property Overview

Building Name	Woodlawn Plaza
Address	114 Woodlawn Road, Dartmouth, NS
Property Type	Retail Plaza
Building Size	158,058 sq. ft.
Units Available	Unit 132: 866 sq. ft Unit 133/ 134: Leased Unit 135: 2,079 sq. ft
Parking	Ample, free on-site parking
Public Transit	Six (6) routes within walking distance
Additional Rent	\$10.50 psf (2025)



Key Highlights



Flexible Floor Plans



Multiple Signage Options



Proximity to Public Transit



Proximity to Public Residential



Amenity Rich Area



Ample, On-site Parking



Excellent Street Visibility

Unit 132

866 sq. ft. of bright, open-concept retail space with high ceilings and designated storage area

Size	866 sq. ft.
Availability	Immediately
Net Rent	By negotiation
Additional Rent	\$10.50 psf (2025)



Floor Plan:

- Large storefront windows
- Open-concept layout
- One accessible washroom
- Designated storage space

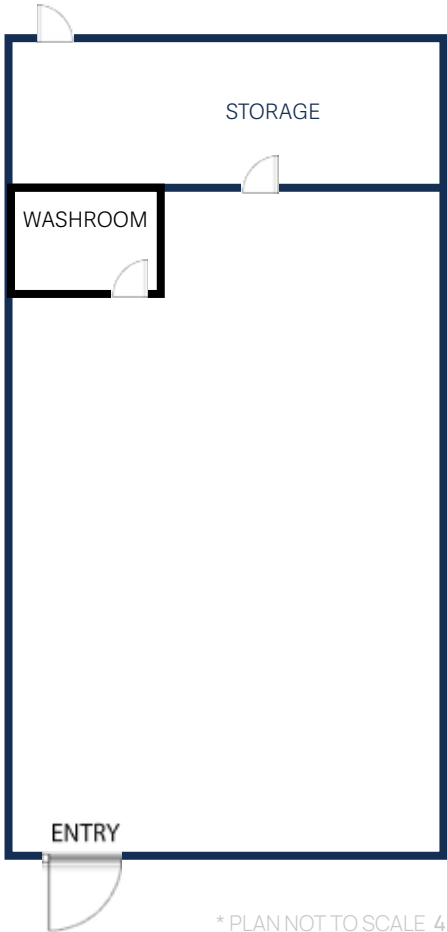



Unit 132 | 866 sq. ft.



Unit 135

2,079 sq. ft. of open-concept retail space ideal for grocery or specialty food business

Size	2,079 sq. ft.
Availability	Immediately
Net Rent	By negotiation
Additional Rent	\$10.50 psf (2025)



Floor Plan:

- Large storefront windows
- 2,079 sq. ft. of open-concept space
- Built-in front counter
- Rear prep kitchen area
- One washroom
- Durable epoxy flooring
- Storage and grocery storage space
- Some kitchen/ grocery store equipment and fixtures available





Unit 135 | 2,079 sq. ft.



Site Plan



Tenant List:

101. Giant Tiger	121. Vogue Optical	130. Dr. Miller
110. Planet Fitness	122. Massage Experts	131. Giant Robot Comics
114. Coastal Dance	124A. Supplement world	132. Vacant
115. The Growing Place	124B. 7 Iron	133/134. Leased
116. Shanti Hot Yoga	123. Under Agreement	135. Vacant
117. H&R Block	125. J&B Lock	138. (Mezz.) Tattletales Book
117D Sally Beauty	126. Rosebush Flowers	PD01. Not Available
118 Atlantic Fabric	127. Original Six Barbershop	PD02. Staples
119A. Fairstore Financial	127B. European Groceries	PD02. Scooters Tire Barn
119B. Bulk Barn	128. TA Nails	
120. JAMS Bakery	129. Crowell Denture	

Aerial Overview



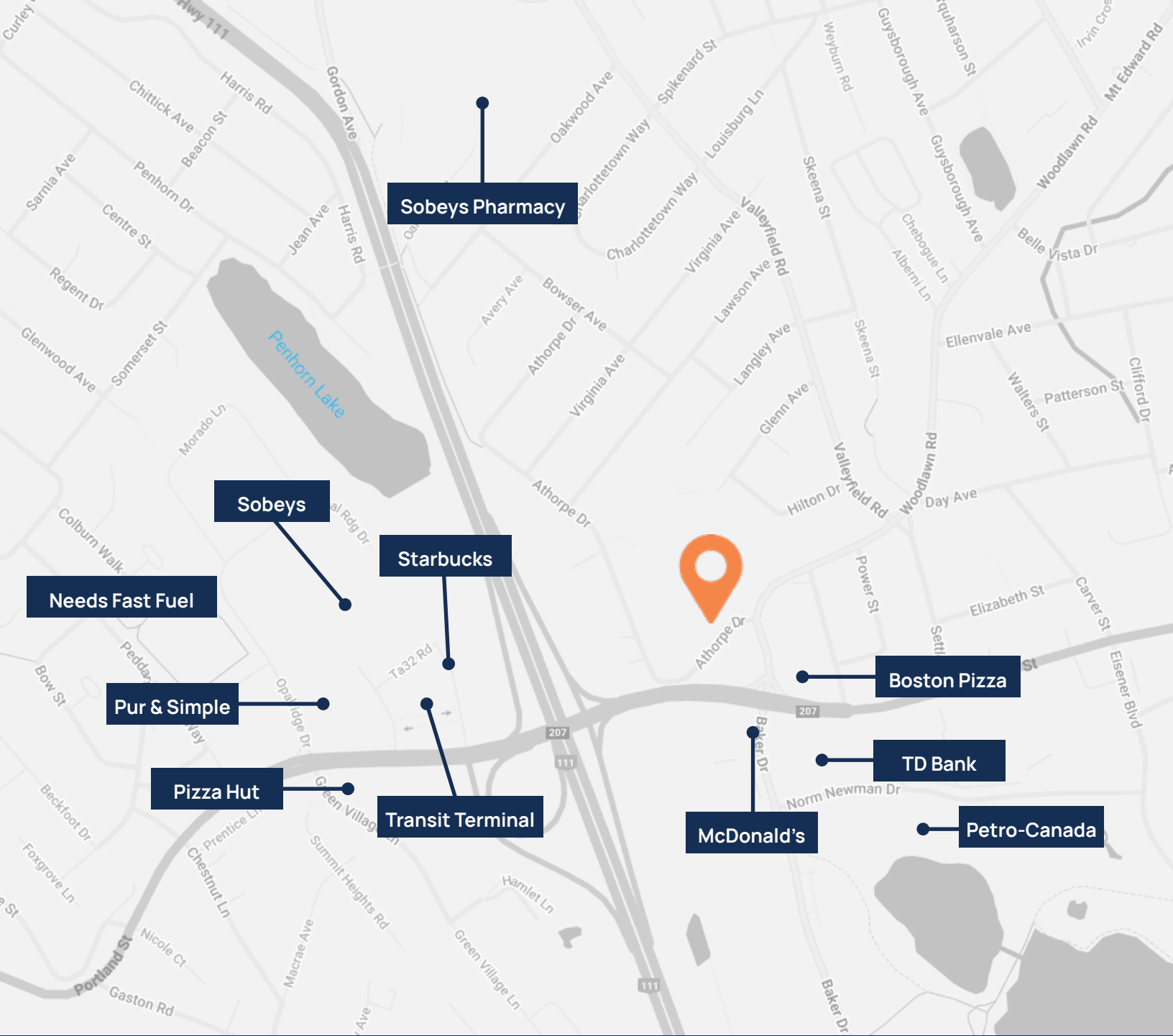

Rod Winters

📞 (902) 444-4004
 📠 (902) 223-5781
 ✉️ rod@partnersglobal.com



Matt Ross

📞 (902) 444-4004
 📠 (902) 324-1101
 ✉️ matt@partnersglobal.com

Partners Global Corporate Real Estate (Partners Global) and its agents and affiliates do not warrant, represent or guarantee the accuracy, completeness or validity of the information provided herein. Parties interested in the property are to conduct their own independent investigations to determine the suitability of the property for their intended use and are strongly urged to discuss the property with their professional advisors. Partners Global expressly disclaims any liability arising out of any errors and omissions in the information. Prospective clients should not confine themselves to the contents but should make their own enquiries to satisfy themselves in all respects. Partners Global will not accept any responsibility should any details prove to be incomplete or incorrect.