

FOR LEASE

31831 LOUGHEED HIGHWAY, MISSION, B.C.

RETAIL OPPORTUNITIES AT NEW MIXED-USE DEVELOPMENT

Developed By:



ELEVATE

Visit Elevate Website



OUTLOOK VILLAGE
MISSION



FUTURE PHASE

Main Entrance
Into Outlook Village



LOUGHEED HWY (35,262 VPD)

WREN STREET (14,000 VPD)

Marcus & Millichap

FOR LEASE

OUTLOOK VILLAGE, MISSION, B.C.



OUTLOOK VILLAGE

MISSION

[Visit Outlook Village Website](#)

A gateway to the City of Mission, Outlook Village is a multi-phased, mixed-use development that is set to be a landmark entrance to a rapidly growing community. Upon full completion of commercial and residential, Outlook Village / Wren + Raven Hillside Homes will feature 130,000 square feet of retail/office space and 131 newly constructed residential homes.

PROPERTY HIGHLIGHTS



100,000 SF of Retail and 30,000 SF of Office



Total of 533 commercial parking stalls



Highly accessible by two signalized intersections



Flexible zoning allows for wide variety of commercial uses



Exceptional exposure onto Lougheed Hwy with traffic counts exceeding 35,000 VPD



FOR LEASE

OUTLOOK VILLAGE, MISSION, B.C.

OUTLOOK VILLAGE - OVERALL SITE



FOR LEASE

OUTLOOK VILLAGE, MISSION, B.C.

BUILDING 8 - 1,193 SF - 3,713 SF

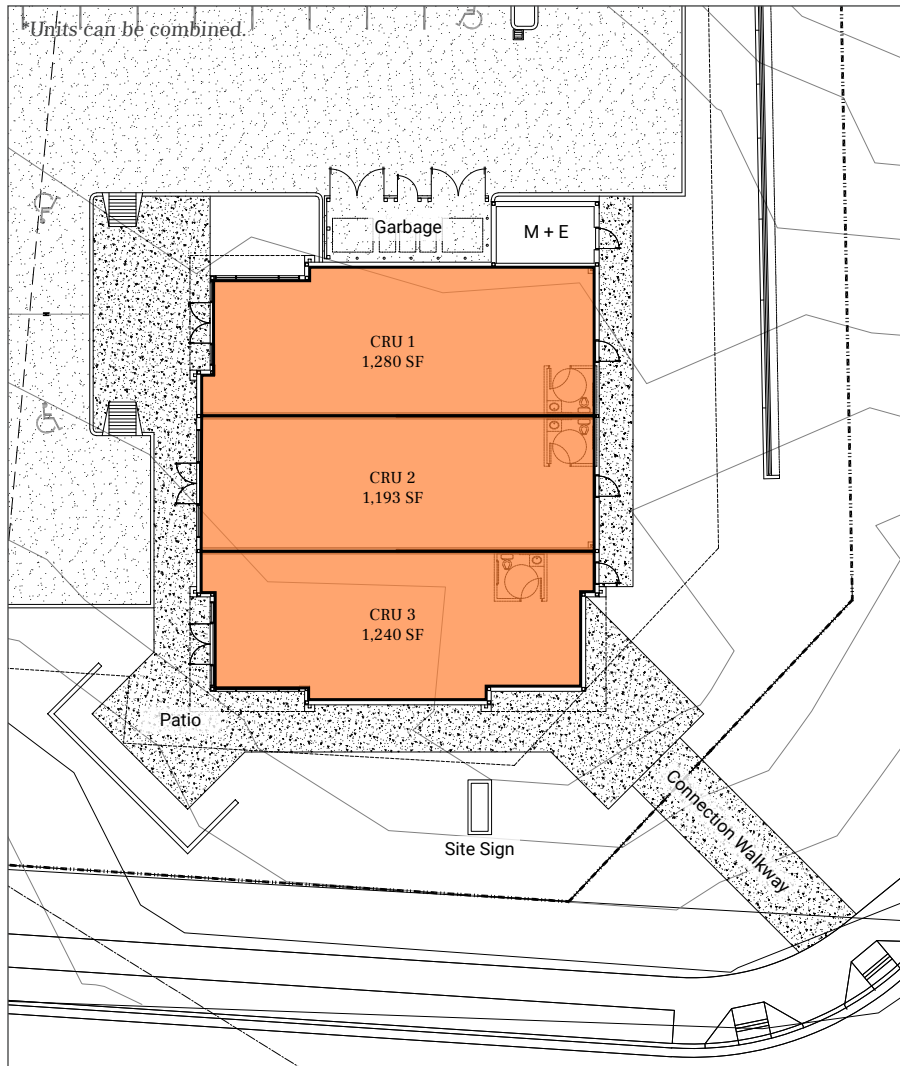

FOR LEASE

OUTLOOK VILLAGE, MISSION, B.C.

BUILDING 9 - 1,450 SF

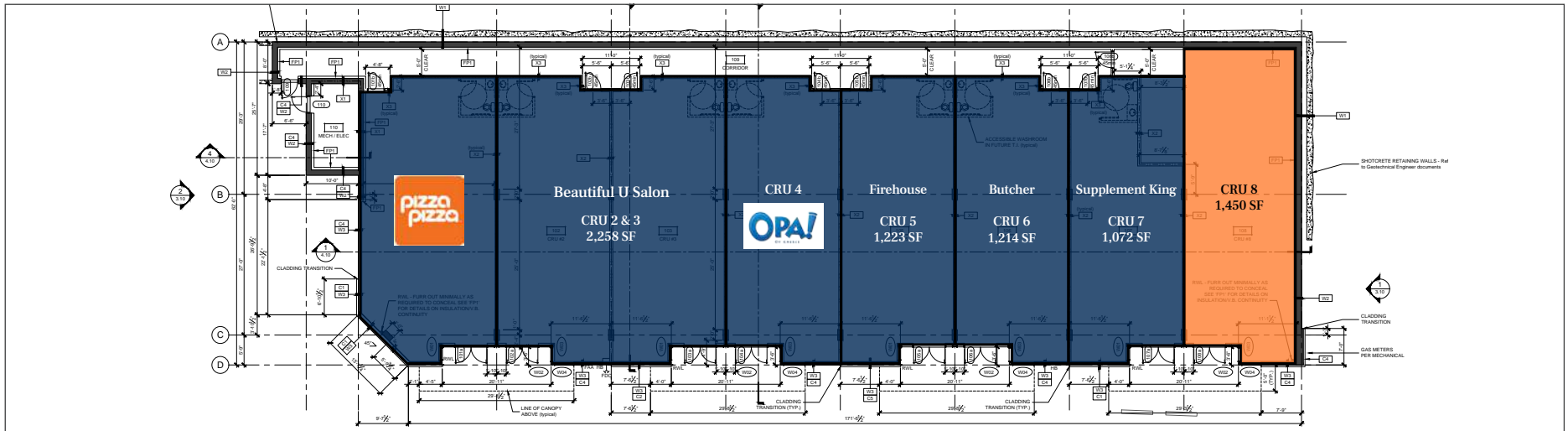

FOR LEASE

OUTLOOK VILLAGE, MISSION, B.C.

2024 Demographics	3KM	5KM	10 Min Drive	Mission
Population	19,680	38,158	41,989	46,125
Households	6,630	12,238	13,619	14,992
Average Household Income	\$115,904	\$127,879	\$126,392	\$131,036
% Population Change 2024 - 2029	2.3%	6.5%	7.8%	9.5%



- | | | | | |
|----------------------------------|---|---|--|--|
| 1. Subject Site | 7. Real Canadian Superstore | 12. The Shops at Mission | 16. The Junction Shopping Centre: Silvercity, Canadian Tire, Staples, Tim Hortons, Wendy's, Envision Financial | Canada Trust, Fas Gas Plus |
| 2. Mission Sports Park | 8. Mission Memorial Hospital | 13. Esso, McDonald's, Dairy Queen | 17. London Drugs, Save-On-Foods, White Spot, Boston Pizza, TD | 18. Mission Arena |
| 3. RCMP | 9. Best Western | 14. Bosley's, Cobs, BC Liquor, Shoppers Drug Mart, Brown's Social House | | 19. Clarke Foundation Theatre |
| 4. Walmart Supercentre | 10. Prospera Credit Union | 15. Chevron | | 20. University of Fraser Valley |
| 5. Anytime Fitness, Petro Canada | 11. Rexall, Westland Insurance, Tim Hortons | | | 21. West Coast Express: Mission City Station |
| 6. Rona | | | | |

FOR LEASE

OUTLOOK VILLAGE, MISSION, B.C.

DISTRICT OF MISSION

IMMEDIATE AREA GROWTH:

- Mission's current population of 39,000 is expected to reach a total of 56,000 by 2041
- Proposed development planning for the immediate area sets the stage for the District's anticipated growth

MISSION WATERFRONT:

- A proposed 230-acre planned redevelopment area to revitalize the Waterfront region of Southwest Mission
- Including a variety of housing types to accommodate up to 40,000 people
- Commercial/industrial plan for redevelopment with a wide range of supporting infrastructure
- Plans include public spaces and community amenities

SILVERDALE COMPREHENSIVE PLANNING AREA (SCPA):

- A 3,440-acre master-planned area in West Mission designated for future urban growth
- A Master Infrastructure Strategy (MIS) was introduced in July 2018 in order to further progress the SCPA

HIGHLIGHTS

District of Mission represents a fast growing, affluent trade area comprised of over 50,000 people

The primary trade area of Mission is projected to grow at a rate of 9.5% until 2029

Mission experiences excellent commuter access to downtown Vancouver via the West Coast Express, with Mission City Station situated just over 2KM from Outlook Village

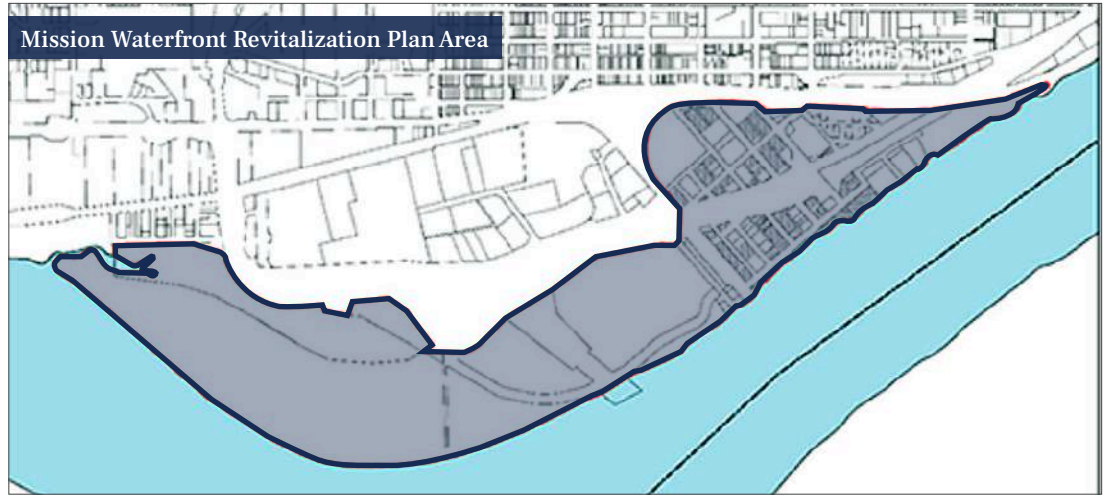

Marcus & Millichap

Jack Allpress

(604) 638-1975

JAllpress@MarcusMillichap.com

Personal Real Estate Corporation

Robert Hamilton

(604) 398-2773

RHamilton@MarcusMillichap.com

Marcus & Millichap

1100 - 1111 West Georgia Street

Vancouver, BC V6E 4M3

T (604) 638-2121

F (604) 638-2122

MarcusMillichap.ca

The information contained in this Marketing Brochure is proprietary and strictly confidential. It is intended to be reviewed only by the party receiving it from Marcus & Millichap and should not be made available to any other person or entity without the written consent of Marcus & Millichap. This Marketing Brochure has been prepared to provide summary, unverified information to prospective purchasers, and to establish only a preliminary level of interest in the subject property. The information contained herein is not a substitute for a thorough due diligence investigation. Marcus & Millichap has not made any investigation, and makes no warranty or representation, with respect to the income or expenses for the subject property, the future projected financial performance of the property, the size and square footage of the property and improvements, the presence or absence of contaminating substances, PCB's or asbestos, the compliance with State and Federal regulations, the physical condition of the improvements thereon, or the financial condition or business prospects of any tenant, or any tenant's plans or intentions to continue its occupancy of the subject property. The information contained in this Marketing Brochure has been obtained from sources we believe to be reliable; however, Marcus & Millichap has not verified, and will not verify, any of the information contained herein, nor has Marcus & Millichap conducted any investigation regarding these matters and makes no warranty or representation whatsoever regarding the accuracy or completeness of the information provided. All potential buyers must take appropriate measures to verify all of the information set forth herein.

Marcus & Millichap is not affiliated with, sponsored by, or endorsed by any commercial tenant or lessee identified in this marketing package. The presence of any corporation's logo or name is not intended to indicate or imply affiliation with, or sponsorship or endorsement by, said corporation of Marcus & Millichap, its affiliates or subsidiaries, or any agent, product, service, or commercial listing of Marcus & Millichap, and is solely included for the purpose of providing tenant lessee information about this listing to prospective customers.

This information has been secured from sources we believe to be reliable, but we make no representations or warranties, express or implied, as to the accuracy of the information. References to square footage or age are approximate. Buyer must verify the information and bears all risk for any inaccuracies. Marcus & Millichap is a trademark of Marcus & Millichap Real Estate Investment Services, Inc. Used under license by Marcus & Millichap Real Estate Investment Services Canada Inc. © 2023 Marcus & Millichap. All rights reserved.