



# FOR LEASE

107B – 2748 LOUGHEED HIGHWAY  
PORT COQUITLAM, BC

## WESTWOOD CENTRE OPPORTUNITY!!



Westwood  
Street

**AVAILABLE NOW!**

Value Property Group  
(604) 606-7016  
info@valueindustries.com



SCAN ME

400 – 1245 W. Broadway  
Vancouver, BC V6H 1G7  
www.ValueGroupProperties.com

# FOR LEASE

107B – 2748 Lougheed Highway  
Port Coquitlam

## Location:

Located at the Southeast corner of Lougheed Highway and Westwood Street. High traffic from Port Coquitlam, Coquitlam & Port Moody.

Join BC Liquor Store, ReMax, Jenny Craig, DeDutch, Subway, Waves Coffee, Great Clips, Running Room and others at this highly active commercial centre in Port Coquitlam.



## The Centre:

- A high exposure, busy shopping centre
- Strategically located to service Port Coquitlam, Coquitlam & Port Moody
- Highly visible Pylon signage on both Westwood Street & on Lougheed Hwy.

## Unit Details:

- 2058 sq. ft.
- Large, open space, back storage space & private washroom
- CC zoning (Community Commercial)
- Available now

## Lease Rate:

Please call for details.

## Taxes & Operating Costs (2026):

Property Taxes: \$10.00/sq. ft.\*

Common Area: \$8.53/sq. ft.\*

\*excluding management fee

## CHECK OUT OUR VIDEO TOUR:

<https://tours.pixlworks.com/107b-2748-lougheed-hwy-port-coquitlam>

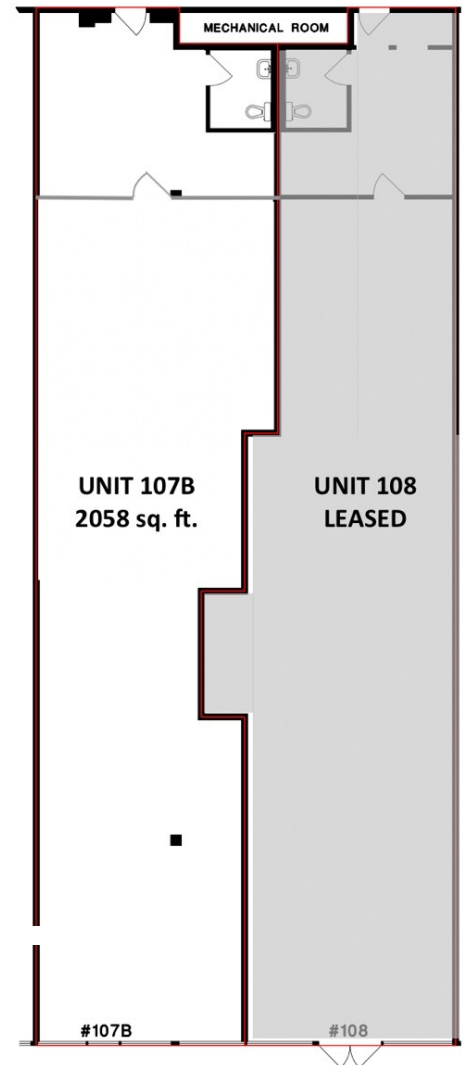

Note: Pre-Construction Pricing offers valid until May 15, 2020. The landlord has provided this information as a courtesy only and assumes no liability for its accuracy. All figures should be verified before relying on them. Rates subject to change.

Value Property Group  
(604) 606-7016  
info@valueindustries.com



SCAN ME

400 – 1245 W. Broadway  
Vancouver, BC V6H 1G7  
www.ValueGroupProperties.com