

Suite 350

969 Robson Street

Vancouver, BC

Improved Move-in Ready Office Space at the Iconic Corner of Robson and Burrard Streets in Downtown Vancouver



Robson Central at 969 Robson Street is a six-storey “A” class office/retail heritage building centrally located on the northeast corner of Robson and Burrard Streets. The Robson/Alberni corridor stretch serves as a commercial mecca for premier front retail area tenants that include Louis Vuitton, Tiffany’s, Salvatore Ferragamo, Prada, Gucci and Coach. Robson Central features Adidas flagship store at the retail level.

Suite 350

Improved with a reception, kitchen area, nine private offices, meeting rooms, large open area and in-suite washrooms.

Virtual TOUR 

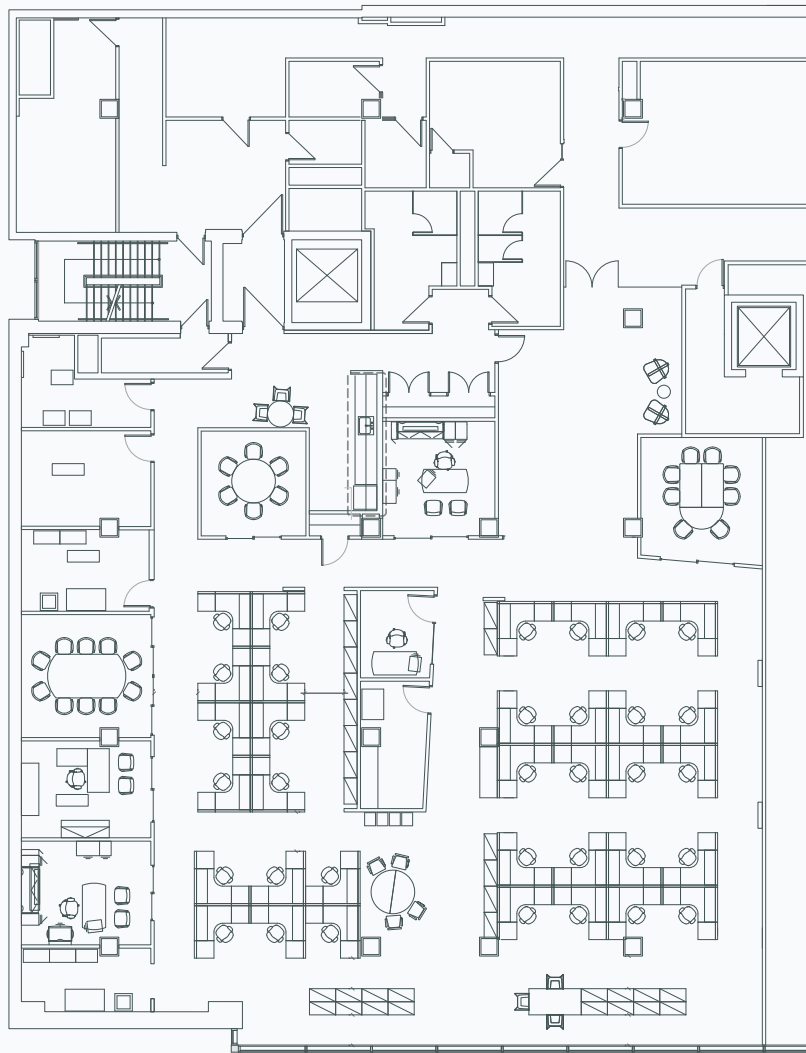

FLOOR PLAN NOT TO SCALE - FURNITURE IS CONCEPTUAL



Available Area
8,334 Rentable Square Feet



Net Rent
Contact Listing Agents



Additional Rent
\$23.43 PSF (2025 estimate)



Availability
Immediate

BUILDING AMENITIES

- + Centrally located in Downtown Vancouver
- + Bike storage
- + Abundant restaurants and shops nearby
- + Great street scape views of Robson and Burrard Streets
- + Professionally managed by Warrington PCI



BUILDING FEATURES

Heritage Building Designation (1994)

1958 Recipient of the Massey Silver Medal for Architecture



Renovated in 2012
- 35,000 Sq. Ft. New Adidas Flagship Store

A Class Office Space

BOMA Best Silver for Sustainability

Location

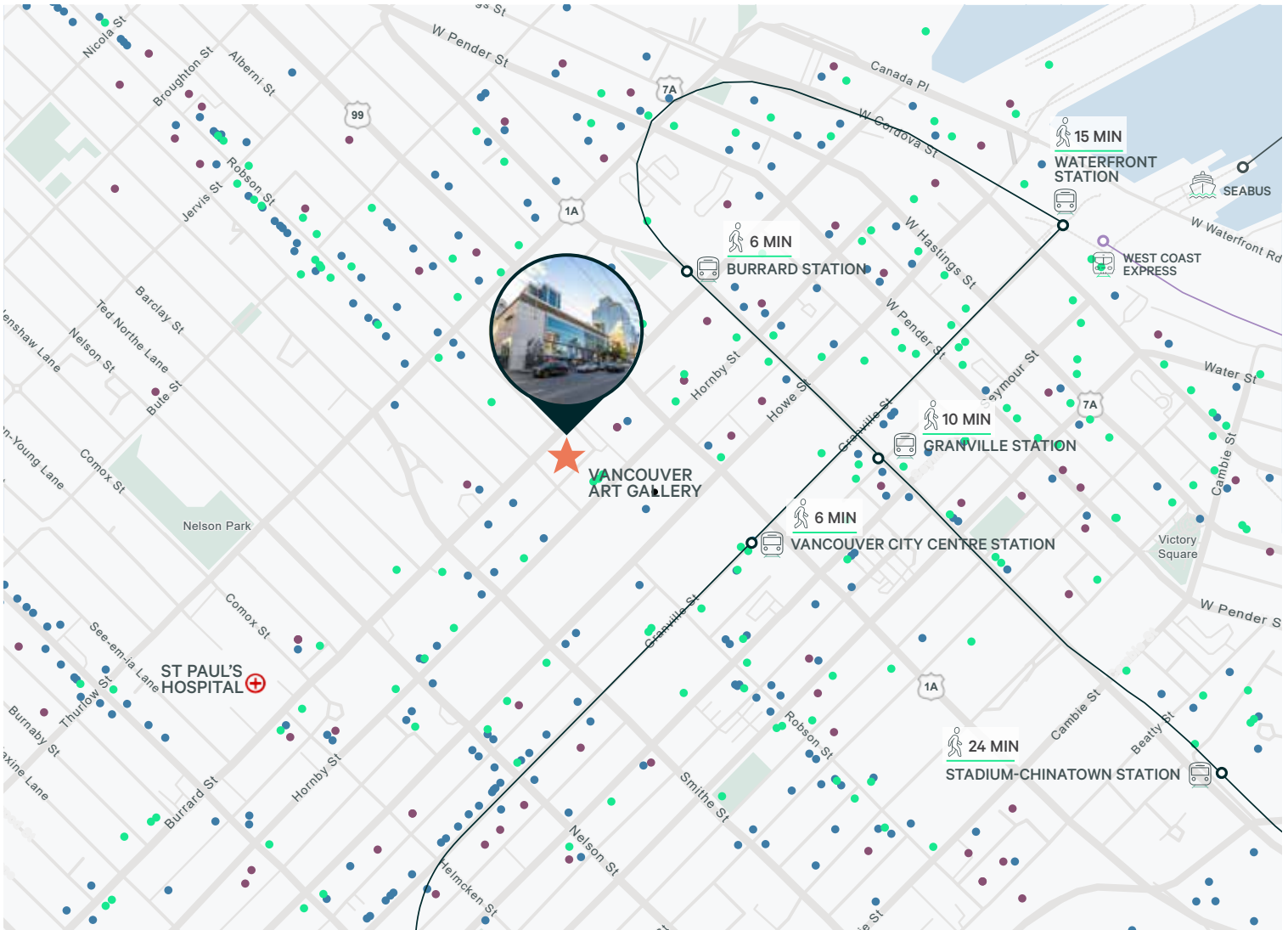
Located at the vibrant intersection of Robson and Burrard Streets, 969 Robson Street is your gateway to the best of Vancouver! This prime location offers immediate access to multiple transit routes, including the Vancouver City Centre, Granville, and Waterfront SkyTrain stations for access to the Canada Line, Expo Line, Westcoast Express and SeaBus. The area is bustling with a variety of amenities, including high-end retail stores, popular restaurants, and vibrant cafes all steps away, perfect for lunch breaks or after-work gatherings. The area also has numerous entertainment options such as theaters and hotels all within walking distance. With its central location and excellent connectivity, 969 Robson Street is an ideal spot for both business and leisure.



100 Walker's Paradise
 100 Excellent Transit
 91 Biker's Paradise
 163 Cafés
 257 Restaurants
 57 Hotels

walkscore.com

Contact

Eli Applebaum
 Personal Real Estate Corporation
 Vice President
 Office Properties
 604 662 5164
 eli.applebaum@cbre.com

Andre Alie Day
 Personal Real Estate Corporation
 Senior Associate
 The High Technology Facilities Group
 604 662 5137
 andre.alieday@cbre.com

CBRE Limited | 1021 West Hastings Street | #2500 | Vancouver, BC V6E 0C3 | www.cbre.ca

This disclaimer shall apply to CBRE Limited, Real Estate Brokerage, and to all other divisions of the Corporation; to include all employees and independent contractors ("CBRE"). The information set out herein, including, without limitation, any projections, images, opinions, assumptions and estimates obtained from third parties (the "Information") has not been verified by CBRE, and CBRE does not represent, warrant or guarantee the accuracy, correctness and completeness of the Information. CBRE does not accept or assume any responsibility or liability, direct or consequential, for the Information or the recipient's reliance upon the Information. The recipient of the Information should take such steps as the recipient may deem necessary to verify the Information prior to placing any reliance upon the Information. The Information may change and any property described in the Information may be withdrawn from the market at any time without notice or obligation to the recipient from CBRE. CBRE and the CBRE logo are the service marks of CBRE Limited and/or its affiliated or related companies in other countries. All other marks displayed on this document are the property of their respective owners. All Rights Reserved.

Mapping Sources: Canadian Mapping Services canadamapping@cbre.com; DMTI Spatial, Envirionics Analytics, Microsoft Bing, Google Earth.