

# #111 - 805 West Broadway, Vancouver

## BASIC RENT: CONTACT LISTING AGENT

Rentable Area: 1,220sf | Availability: January 1st, 2023

Retail unit with high exposure and large frontage located in busy medical center.

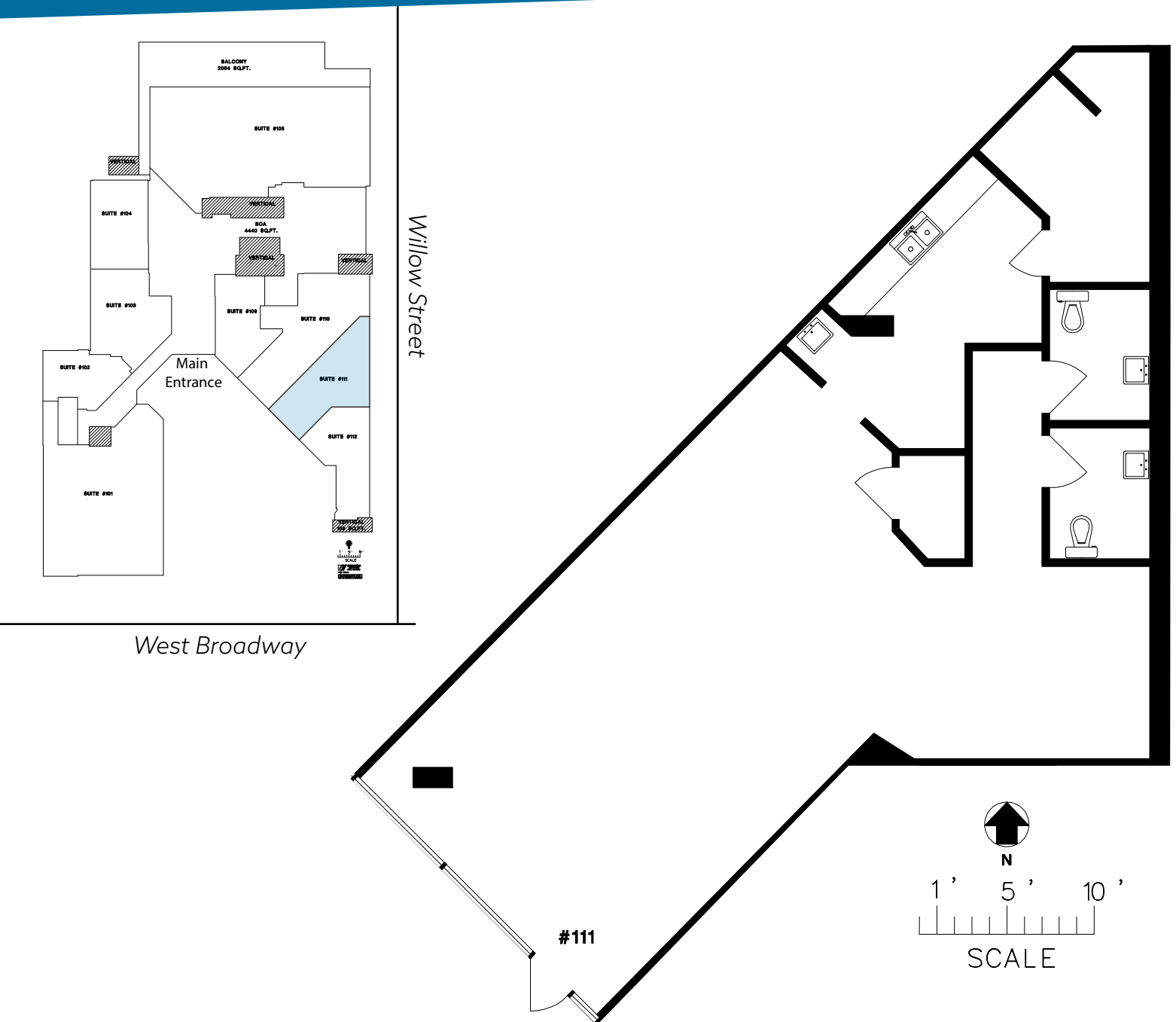

**JEFF TOEWS**

604 723 4990

[jtoews@warringtonpci.com](mailto:jtoews@warringtonpci.com)

300 - 1030 West Georgia St., Vancouver, BC V6E 2Y3

E. & O.E.: The information contained herein was obtained from sources which we deem reliable, and while thought to be correct, is not guaranteed by Warrington PCI Management.



**WARRINGTON PCI**  
MANAGEMENT