

# Peguis Promenade

Reenders Drive & Rougeau Road  
Winnipeg, Manitoba

## East Winnipeg's Exciting New Development Adjacent to Kildonan Place and Costco



**NORTHEAST  
WINNIPEG**



**64,587  
HOUSEHOLDS**  
Based on Trade Area (2025)



**147,937  
DAYTIME  
POPULATION**  
Based on Trade Area (2025)



**24,800  
VEHICLES  
PER DAY**  
Reenders Dr. (2024)



**500+ NEW  
MULTIFAMILY  
UNITS ON-SITE**

# Peguis Promenade

Reenders Drive & Rougeau Road  
Winnipeg, Manitoba

Mixed-Use Development, Adjacent to Kildonan Place and Costco

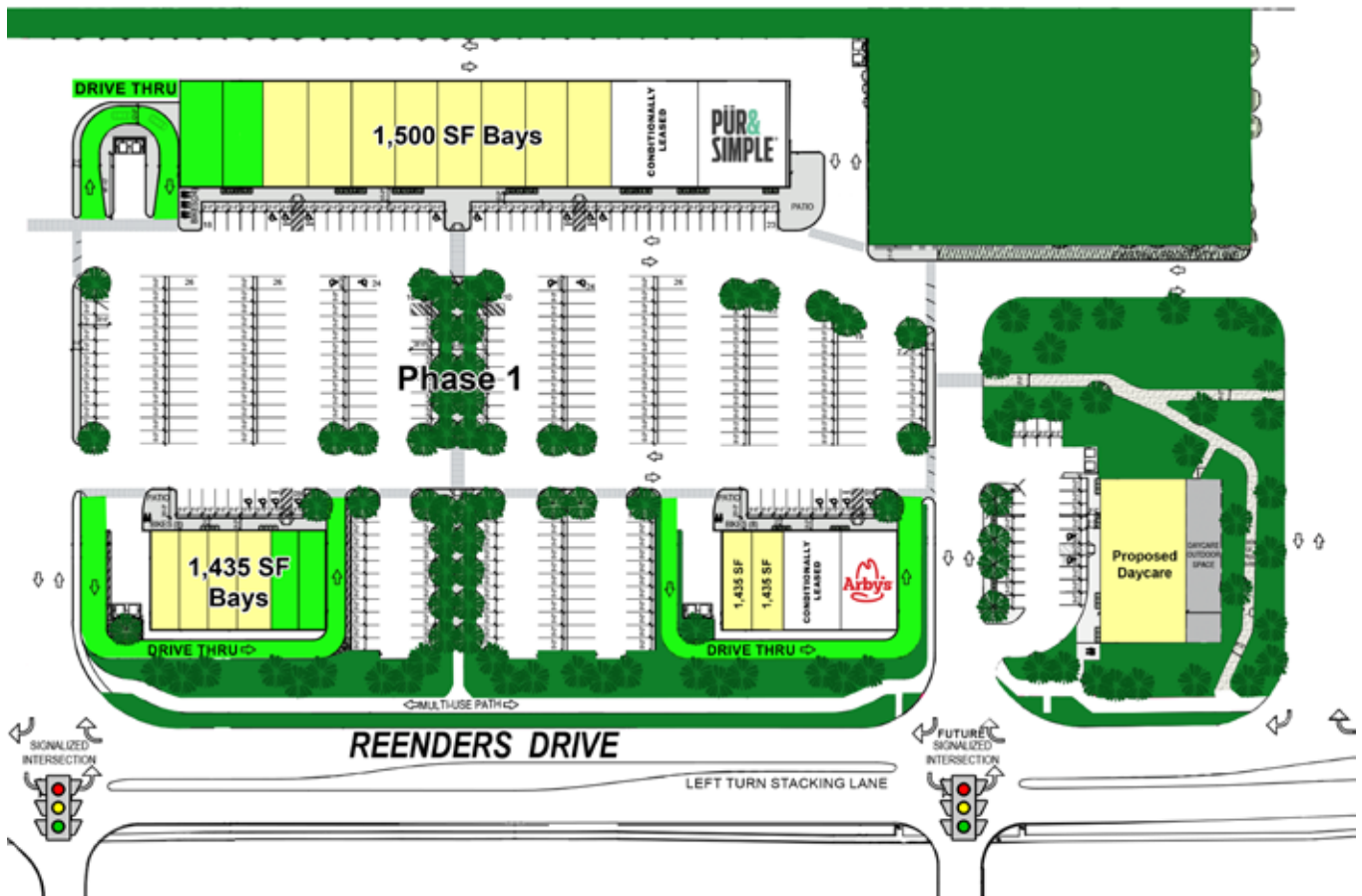

## IN THE HEART OF EAST WINNIPEG'S LARGEST SHOPPING DESTINATION

Situated in the centre of a **dominant shopping hub** serving east Winnipeg. Peguis Promenade is a new mixed-use development featuring luxury rental apartments to compliment new service and retail.



**Accommodate all sizes and uses**  
Prominent drive-thru opportunities and major pylon signage proposed



**Growing Residential Area**  
Fast growing residential area with thousands of new homes planned. 7,000+ new households in last decade.



**Infrastructure Improvements**  
Multi-million investment including the extension and widening of Reenders Drive & Peguis Street



**Excellent Public Transportation**  
There are 10 transit routes in the immediate vicinity, connecting to all areas of the city

204.474.2000

**Shindico**

# Peguis Promenade

Reenders Drive & Rougeau Road  
Winnipeg, Manitoba

Mixed-Use Development, Adjacent to Kildonan Place and Costco



## YOUR FLAGSHIP LOCATION IN A THRIVING RETAIL & RESIDENTIAL CORRIDOR

- Adjacent to Canadian Tire (major expansion underway) and Costco (with expanded parking), and across the street from Kildonan Place Shopping Centre, northeast Winnipeg's regional shopping centre with over 100 shops, food court and theatre.
- Over **500 new purpose-built rental units** are planned for the development.
- Regional attractions include Cineplex Junxion, Club Regent Casino (1,642,500 visitors annually), the Regent Avenue Auto Strip, Home Depot, Walmart Supercentre, Real Canadian Superstore and Rona+.
- **Large Daytime Population** with significant employment lands nearby including:
  - Canada Revenue Agency's Winnipeg Taxation Centre (3,000+ employees).
  - St. Boniface Industrial Park, to the south, which includes approximately 15,000 employees from companies such as New Flyer Industries, Palliser Furniture, Richlu Manufacturing, Bison Transport, Parmalat, and BeeMaid.
- **Ready for tenant occupancy Spring 2027.**



# Peguis Promenade

Reenders Drive & Rougeau Road  
Winnipeg, Manitoba

Mixed-Use Development, Adjacent to Kildonan Place and Costco

## TRADE AREA DEMOGRAPHICS



164,186  
Population



38.3  
Median Age



64,587  
Households



CA\$87,266  
Median Income

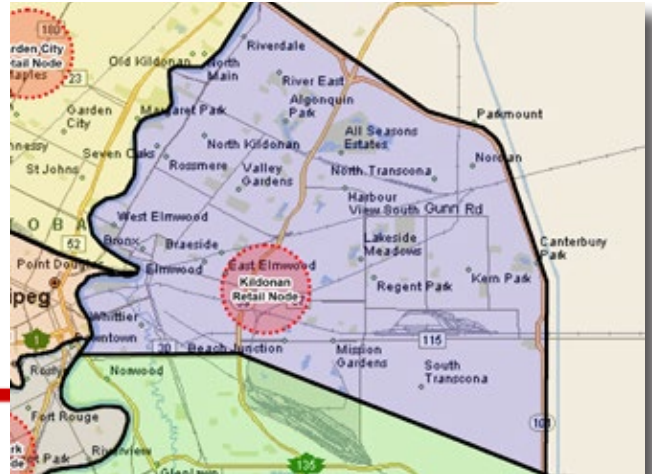

Population and Household Counts

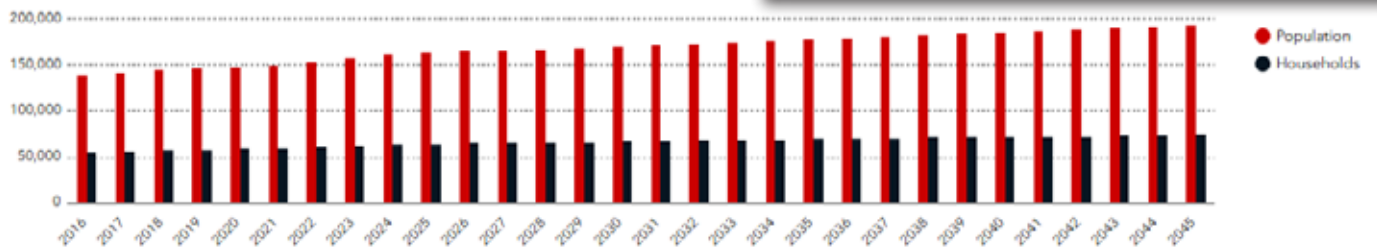

Population and Household Percent Changes

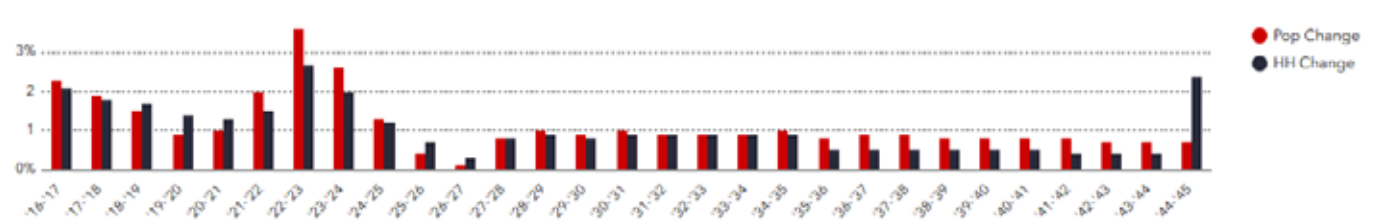

9+%

Population growth  
in the last 5 years

10+%

Growth in  
Total Households  
in the last 5 years

50%

Daytime Population  
is at work

Envronics Analytics ©2025

204.474.2000

Shindico

# Peguis Promenade

Reenders Drive & Rougeau Road  
Winnipeg, Manitoba

Mixed-Use Development, Adjacent to Kildonan Place and Costco

ONE OF THE **FASTEST**  
GROWING RESIDENTIAL  
AREAS IN WINNIPEG  
WITH **THOUSANDS** OF  
NEW HOMES



# Peguis Promenade

Reenders Drive & Rougeau Road  
Winnipeg, Manitoba

Mixed-Use Development, Adjacent to Kildonan Place and Costco



FOR MORE INFORMATION, PLEASE CONTACT:

**Michael Stronger\***

\*SHINDICO REALTY, MICHAEL STRONGER and SHINDICO REALTY are affiliated Brokers

P (204) 928-8237  
C (204) 793-3448  
mstronger@shindico.com

**Dino Alevizos\***

\*Services provided by Dino Alevizos Personal Real Estate Corporation

P (204) 928-8209  
C (204) 781-9717  
dalevizos@shindico.com

**Shindico Realty Inc.**  
200-1355 Taylor Avenue  
Winnipeg, Manitoba R3M 3Y9  
P (204) 474-2000  
inquire@shindico.com  
www.shindico.com



*Shindico is dedicated to the protection of the environment and the communities that we are a part of.*

The accuracy of the information set out herein has not been confirmed, and Shindico Realty Inc. and its affiliates make no representations or warranties as to the accuracy of the information and assumes no responsibility for errors or omissions. The recipient is responsible to verify the accuracy of any information and bears all risk related to any inaccuracies.