FOR SUBLEASE

**NEWLY RENOVATED BOUTIQUE OFFICE SPACE
WITH NORTH SHORE MOUNTAIN VIEWS**



**#210 - 1201 WEST PENDER ST
VANCOUVER, BC**



THE HIGH
TECHNOLOGY
FACILITIES GROUP

CBRE



THE OPPORTUNITY

CBRE Limited is pleased to present the opportunity to sublease high-quality office space in the East Asiatic Building, a heritage-style boutique office property just steps from Vancouver's Seawall and close to Coal Harbour shops and amenities.

PROPERTY OVERVIEW

AVAILABLE AREA 2,099 SF

RENT/PRICE Contact Listing Agents

OPERATING COSTS & TAXES/ PROPERTY TAXES \$20.86 (2026) PSF

AVAILABILITY 60 days notice

PARKING 2 stalls, additional parking in nearby parkades

EXPIRY DATE Nov. 30, 2027, longer term negotiable

FLOOR PLAN

UNIT 210 | 2,099 SF

- 1 boardroom
- 1 meeting room
- 2 executive offices
- Recently renovated
- Modern kitchen
- Gym in building

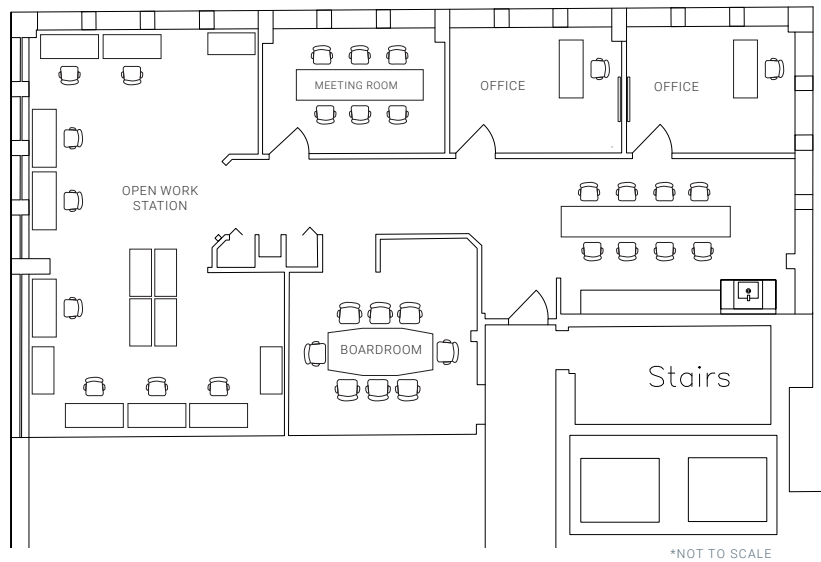

HIGHLIGHTS



Recently renovated



Within a 5-min walk of Burrard Skytrain station



Corner units



Steps from seawall



Great views



Ample natural light





THE LOCATION

Central Downtown location on edge of Coal Harbour, providing a perfect environment for firms seeking proximity to the CBD, while benefiting from a walkable area, with ample shops, gyms, coffee and restaurants at your doorstep, easily accessing some of the city's best amenities.

CONTACT

ALAIN RIVERE

Personal Real Estate Corporation
Senior Vice President, CBRE Limited
alain.rivere@cbre.com
604 662 5110

NICO QUINN

Sales Associate, CBRE Limited
nico.quinn@cbre.com
604 319 0774



FOR SUBLEASE

#210 - 1201 WEST PENDER ST VANCOUVER, BC

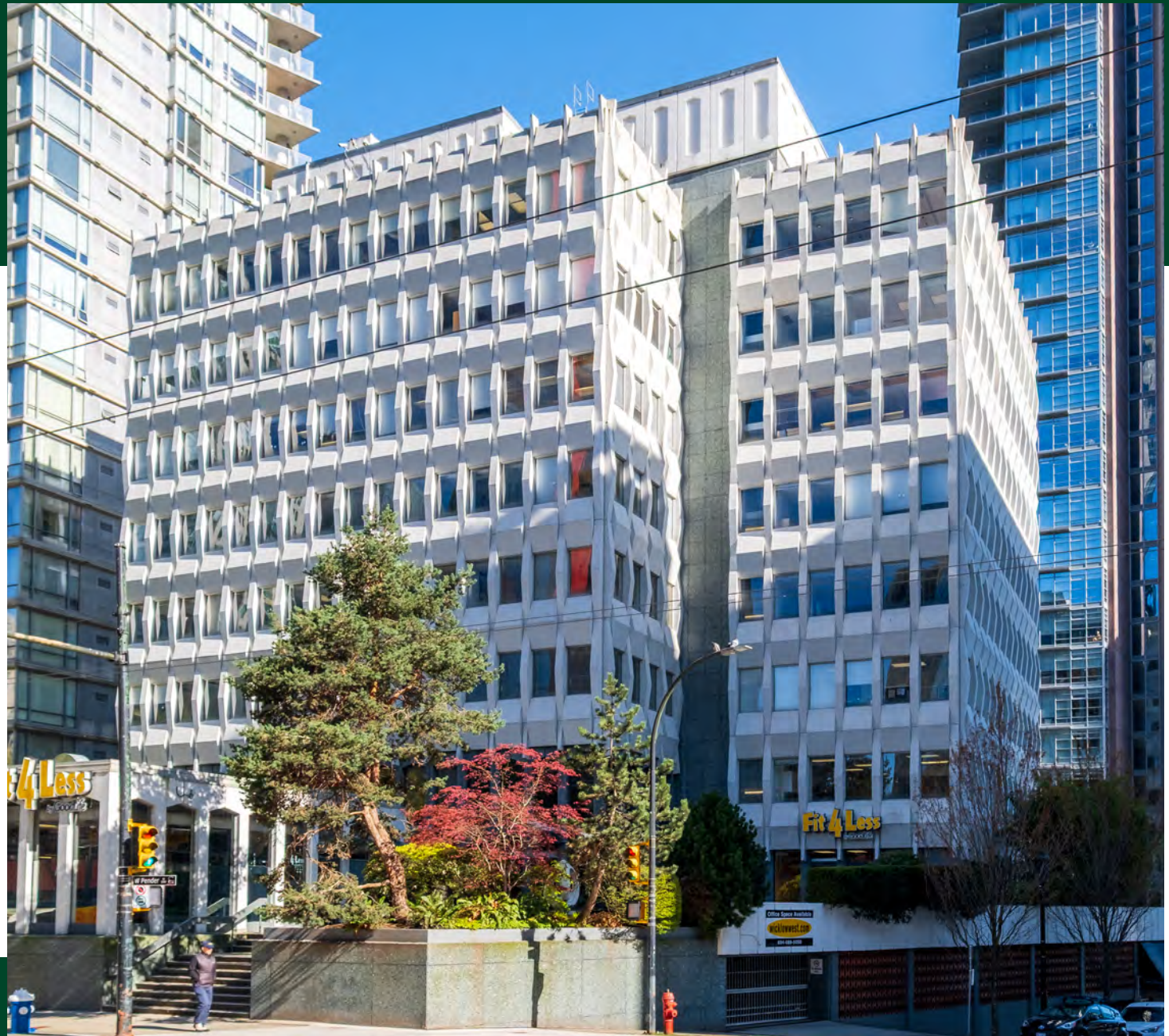

CBRE Limited | 1021 West Hastings Street #2500, Vancouver, BC | www.cbre.ca

This disclaimer shall apply to CBRE Limited, Real Estate Brokerage, and to all other divisions of the Corporation; to include all employees and independent contractors ("CBRE"). The information set out herein, including, without limitation, any projections, images, opinions, assumptions and estimates obtained from third parties (the "Information") has not been verified by CBRE, and CBRE does not represent, warrant or guarantee the accuracy, correctness and completeness of the Information. CBRE does not accept or assume any responsibility or liability, direct or consequential, for the Information or the recipient's reliance upon the Information. The recipient of the Information should take such steps as the recipient may deem necessary to verify the Information prior to placing any reliance upon the Information. The Information may change and any property described in the Information may be withdrawn from the market at any time without notice or obligation to the recipient from CBRE. CBRE and the CBRE logo are the service marks of CBRE Limited and/or its affiliated or related companies in other countries. All other marks displayed on this document are the property of their respective owners. All Rights Reserved. Mapping Sources: Canadian Mapping Services canadamap-ping@cbre.com; DMTI Spatial, EnviroNics Analytics, Microsoft Bing, Google Earth.