

For Lease



6810 – 6 Street SE, Unit C

Glenmore Business Park | Calgary, AB

- Available Immediately
- 7,949 SF
- Small office portion
- 2 dock loading doors, 1 dock w/30,000 lbs capacity ramp

IDEAL FOR BULK STORAGE AND DISTRIBUTION



Unit C

Immediate access to Heritage Drive and Blackfoot Trail, with excellent nearby amenities including the Calgary Farmers' Market and shopping district; Deerfoot Meadows

For leasing opportunities

John Vautour, Director, Leasing
403.536.3549 | jvautour@dream.ca

Dream Industrial REIT
leasing.dream.ca

Floor Plan

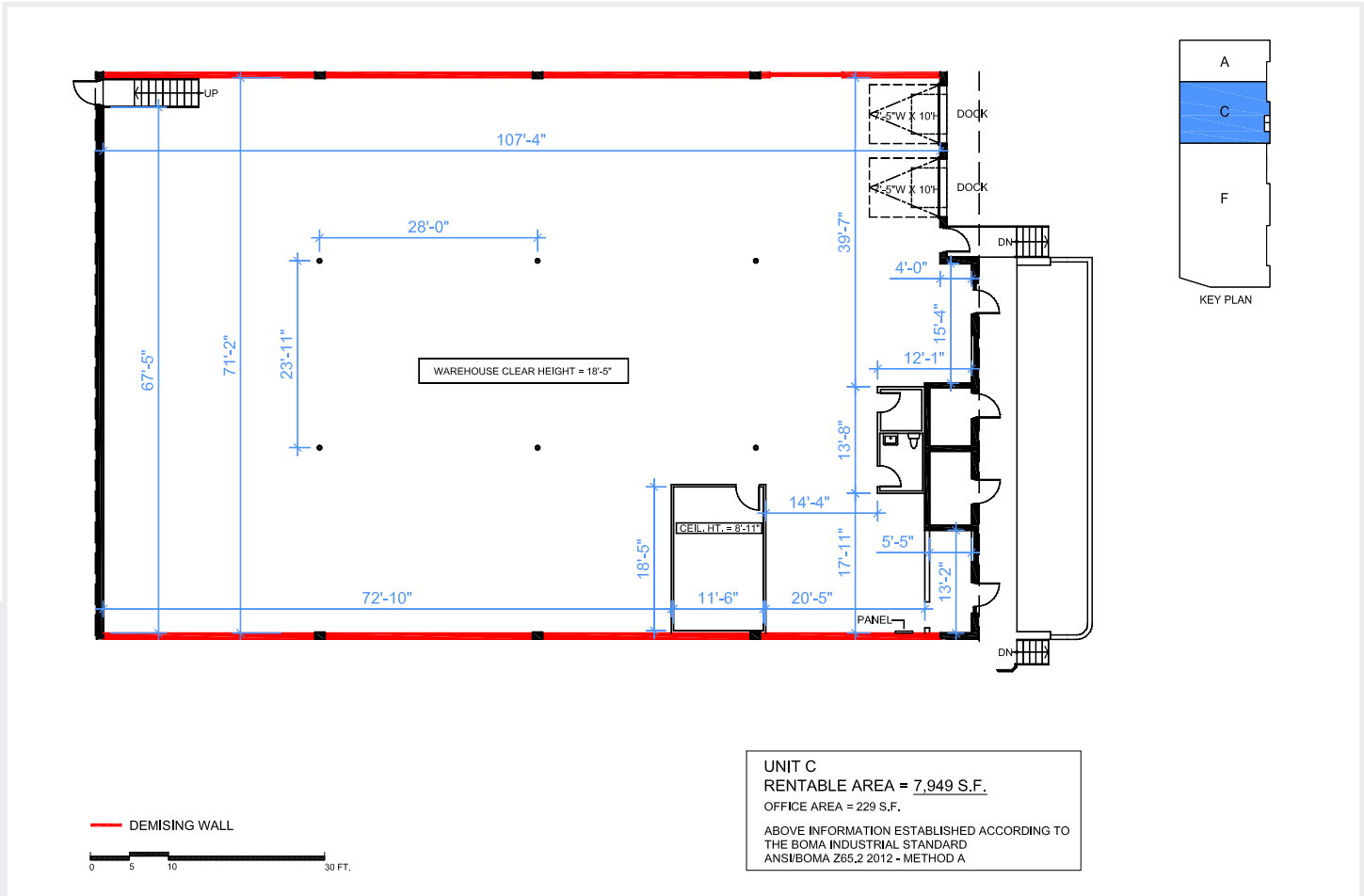

| | | | |
|-----------------|---------------|---|-----------------------------|
| Available area: | Loading: | Ceiling Height: | Power: |
| 7,949 SF | 2 Dock Doors | 18'5" | 200 Amps (347/600 Volts) |
| Availability: | Rental Rates: | Operating Costs: | Zoning: |
| Immediately | Market Rates | CAM \$4.74 TAX \$2.93 (est. 2026) | I-G (Industrial General) |

Dream Industrial is an innovative and customer-focused owner, operator, and developer of high-quality industrial properties. Dream Industrial invests in and manages over 71 million square feet of industrial assets in Canada, Europe, and the United States for over 1,500 occupiers operating across a diversity of sectors. The organization has a track record of delivering best-in-class modern industrial properties globally, with a development pipeline that includes approximately 6 million square feet of active projects and an additional 7 million square feet available for expansion or built-to-suit purposes.

Dream Industrial is part of the Dream Group of Companies and is managed by Dream Unlimited Corp. (TSX:DRM), a leading global real estate asset manager and institutional investor with \$27 billion in assets under management. Dream Industrial is comprised of Dream Industrial REIT (TSX:DIR.UN) as well as several private vehicles.