

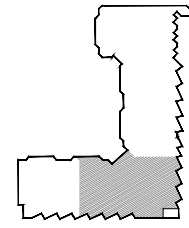

35 Riviera Drive,
Markham, Ontario

Unit 5-8



 **KEY PLAN**

		Hwy # 7	
		407	Rodick Rd.
408	Woodbine Ave.	14th Ave.	Warden Ave.
		Steeles Ave. E.	
		Riviera Dr.	

Drawing Prepared: October 09, 2025
Measured Date: April 23, 2018

This drawing has been prepared by Milestone Property Management Limited and is based upon best information and measurement practices available at the time. This drawing is offered as a reasonable representation to aid in the specification of the available subject named above. All dimensions are deemed correct however they may change without notice. Milestone Property Management Limited is not in any way liable for any errors, inaccuracies and omissions that may result from such information. No party shall rely on the work product, whole or in part without the consent in the form of a letter to Milestone Property Management Limited. For the latest drawings please contact Milestone Property Management Limited. All drawings at the Milestone Property Management office are considered as the reference set to which all other drawings shall be referred to and therefore shall govern in any dispute.

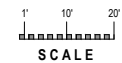

SCALE