

FOR LEASE

Unit#A2 - 1535 Snyder's Rd E, Petersburg



Price:	\$11.00 / sq ft net
Additional Rent:	\$4.87
Taxes:	\$0.80
Total Area:	2,452 sq ft
Ceiling Height:	Varies up 20 ft
Power:	600 volts / 200 amps
Zoning:	Z10 & Z10A

**Industrial/Office unit at
Central location with
excellent access to HWY 8.**



John Markou
Broker/Principal
519-742-7000 x 102
john@coupalmarkou.com

FOR LEASE

Unit#A2 - 1535 Snyder's Rd E, Petersburg

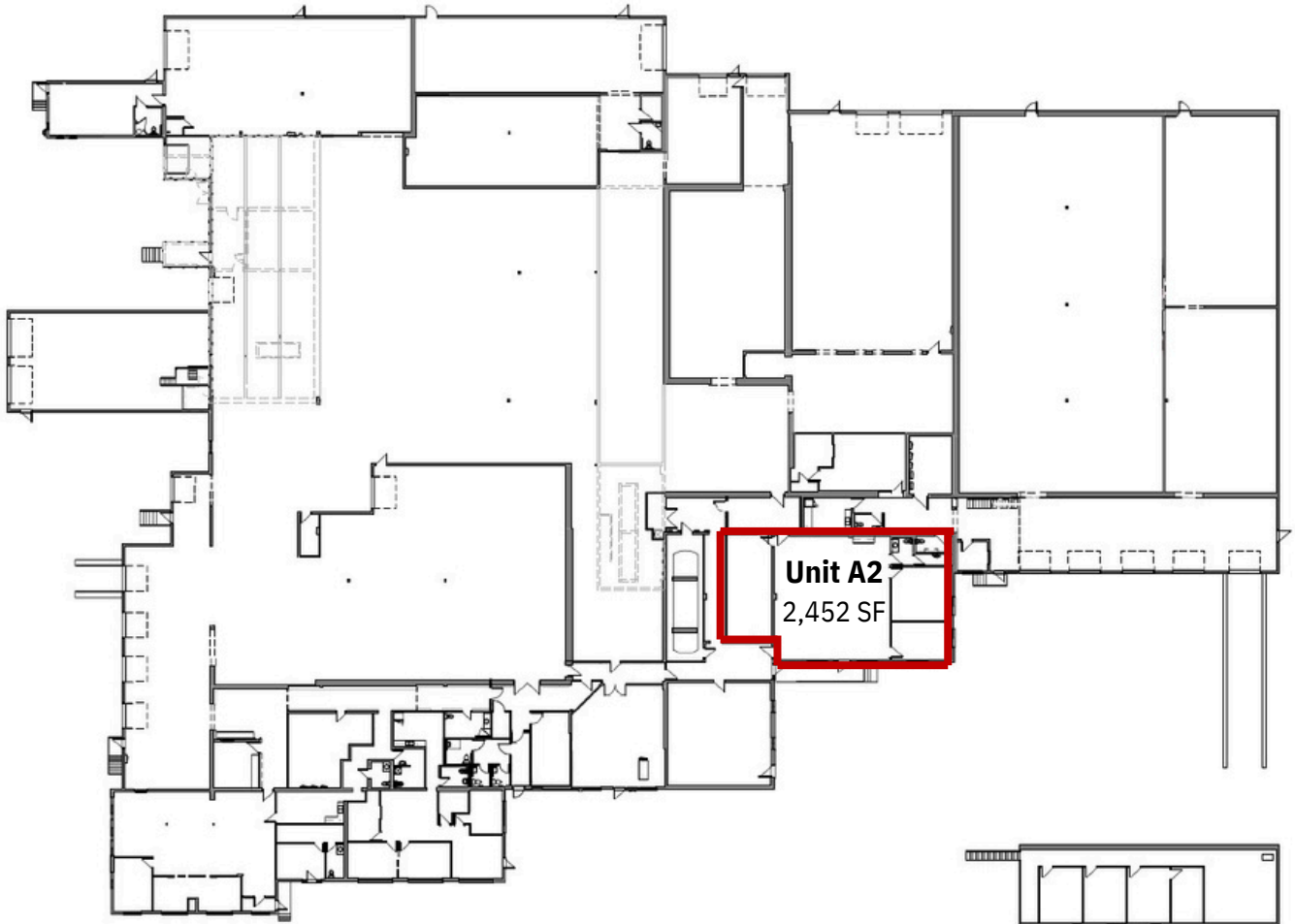

All units subject to final measurements. Additional Rent & Taxes are estimated for 2024.



John Markou
Broker/Principal
519-742-7000 x 102
john@coupalmarkou.com