



Prime end cap unit in busy plaza

Nick Boertien
Sales Representative, Principal,
Vice President
+1 226 366 9011
nick.boertien@avisonyoung.com

Jeremy Moser, CPA, CMA
Sales Representative,
Vice President
+1 226 366 9002
jeremy.moser@avisonyoung.com



Property Details

200 Montclair Drive, Woodstock

- Brand new commercial units ideal for office, retail or service commercial types of uses
- Shadow anchors include Walmart, Home Depot, Staples, Canadian Tire and many more
- Ample onsite parking
- Accessible to public transit
- Immediate occupancy available

Unit	Size	Net rent	TMI
Unit #3	2,061 sf	\$30 psf	\$11.25
Unit #2-3	4,148 sf	\$28 psf	\$11.25

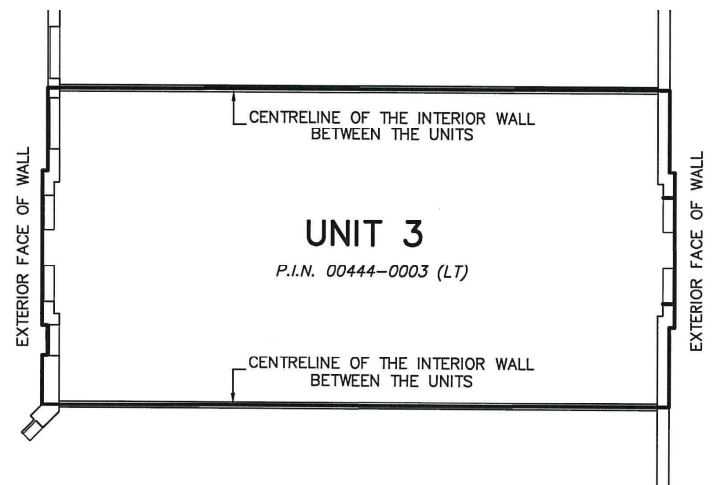
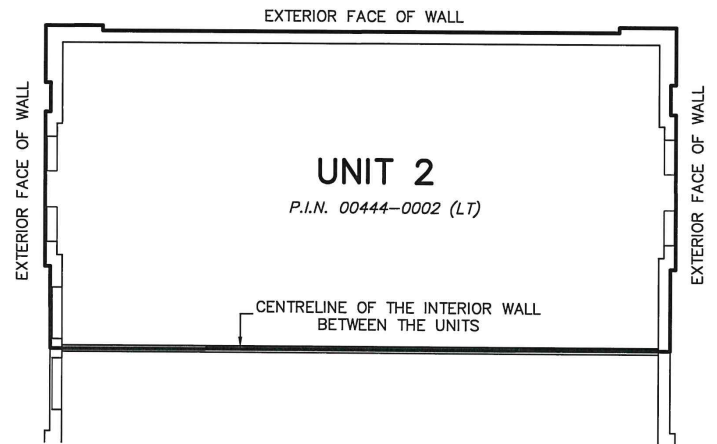

Retail / Office for Lease | 200 Montclair Drive, Woodstock

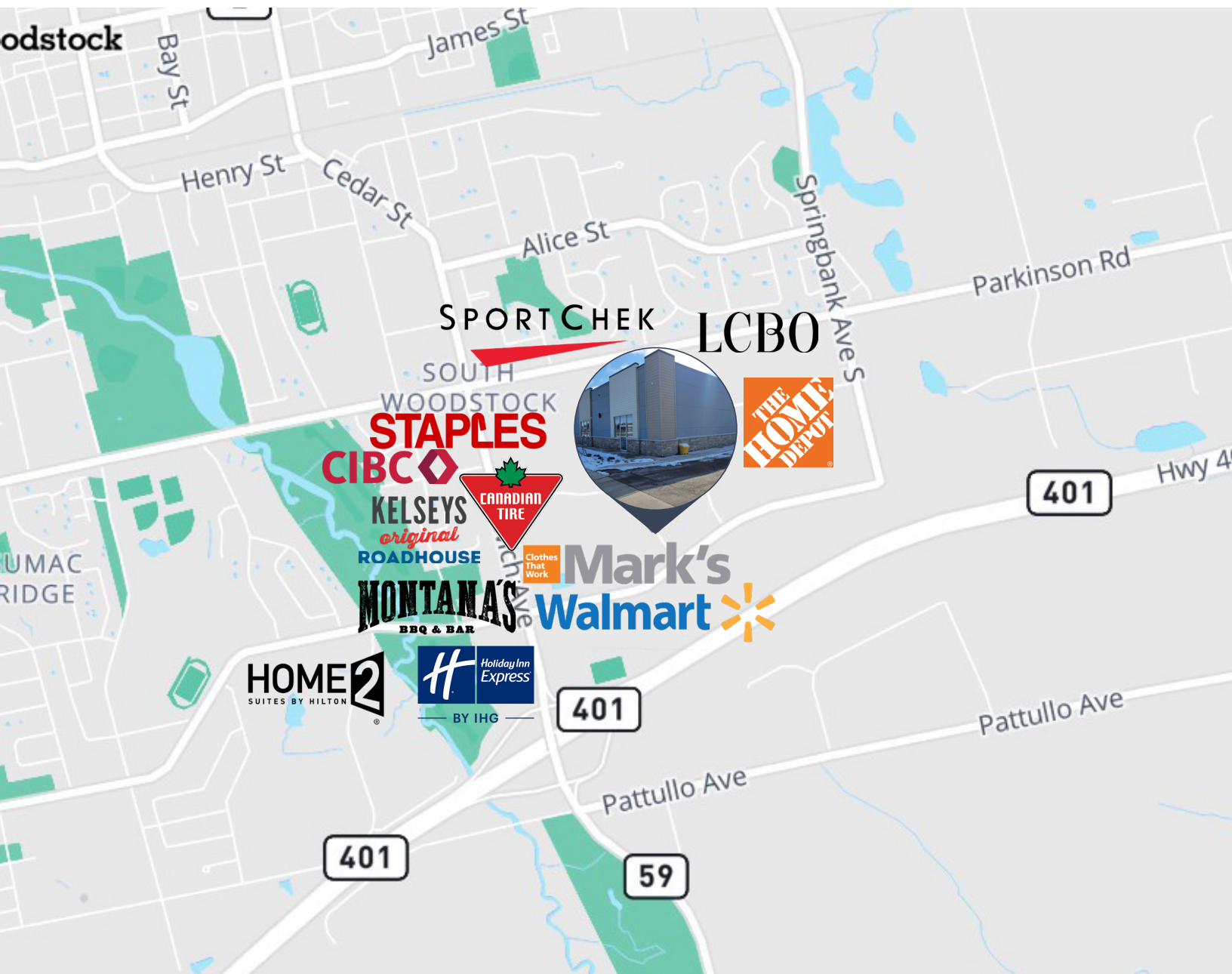

 **53,753** Population of Woodstock  **49,267** Daytime Population  **\$92,574** Avg. Household Income  **41.2** Median Age

Get more information

Nick Boertien

Sales Representative, Principal,
Vice President
+1 226 366 9011
nick.boertien@avisonyoung.com

Jeremy Moser, CPA, CMA

Sales Representative,
Vice President
+1 226 366 9002
jeremy.moser@avisonyoung.com

Avison Young Commercial Real Estate Services, LP, Brokerage
231 Shearson Crescent, Suite 102, Cambridge ON N1T 1J5
T +1 226 366 9090 F +1 866 541 9755

**AVISON
YOUNG**

Platinum member