



New gas development in southeast Grande Prairie

Countryside Crossing

Grande Prairie's population has grown by over 70% since 2001 to nearly 70,000. With a total trade area of nearly 300,000 residents, Grande Prairie serves residents from northeastern BC, northwestern Alberta and as far away as the Yukon and Northwest Territories.

Countryside Crossing is well located at the high exposure intersection of 68 Avenue and 92 Street and offers mid box, drive-thru, pad, and CRU opportunities.

Site work has been completed including clean fill, compaction to 98% and grading to a clean and level condition.



Asking Sale/Lease Price:
Market



Parcel Size
± 2.5 acres



Zoning:
CG - General Commercial



21,555 vpd
along 68 Avenue &
92 Street (2019)

**Get more
information**

Arlyn Stoik
Principal
+1 780 429 7552
arlyn.stoik@avisonyoung.com

Alison Hansen-Carlson
Senior Associate
+1 780 702 0692
alison.hansen-carlson@avisonyoung.com

Siv Lalli
Senior Associate
+1 780 803 9000
siv.lalli@avisonyoung.com

Grande Prairie Demographics (2023)



Population:
68,572



Regional Trade Area:
+2,950,000



Daytime Population:
68,018



Average HH Income:
\$134,893

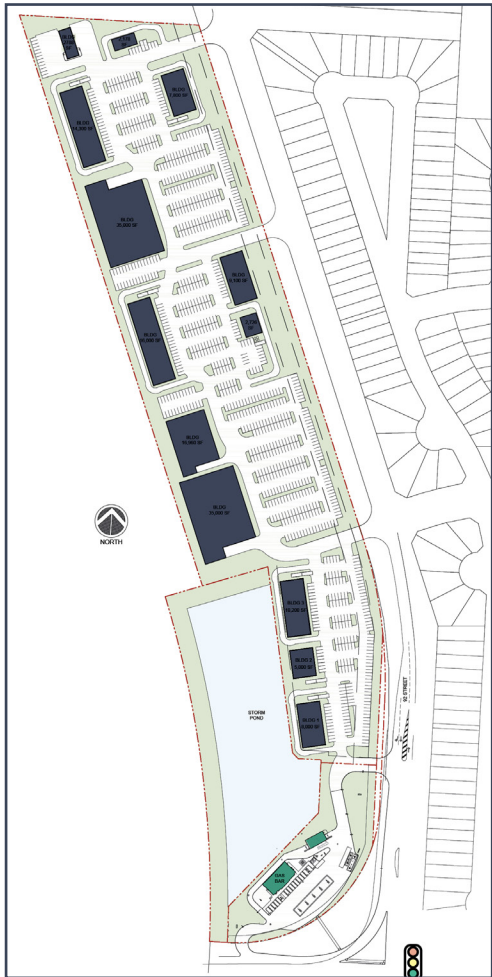

Get more
information

Arlyn Stoik
Principal
+1 780 429 7552
arlyn.stoik@avisonyoung.com

Alison Hansen-Carlson
Senior Associate
+1 780 702 0692
alison.hansen-carlson@avisonyoung.com

Siv Lalli
Senior Associate
+1 780 803 9000
siv.lalli@avisonyoung.com

Retail property for lease

NW Corner of 68 Avenue and 92 Street



**Get more
information**

Arlyn Stoik
Principal
+1 780 429 7552
arlyn.stoik@avisonyoung.com

Alison Hansen-Carlson
Senior Associate
+1 780 702 0692
alison.hansen-carlson@avisonyoung.com

Siv Lalli
Senior Associate
+1 780 803 9000
siv.lalli@avisonyoung.com